

## Johnston Lane Allocation of Conserved Water

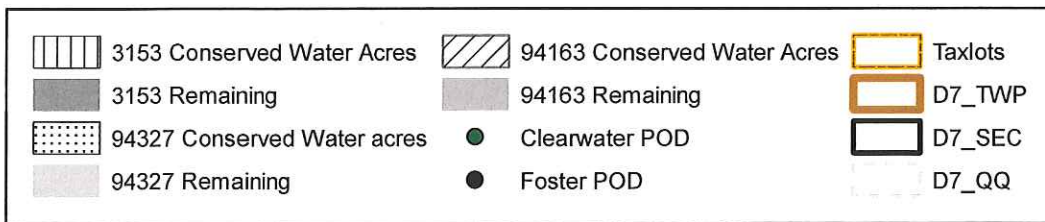

RECEIVED

APR 25 2019

OWRD

↑  
N  
1 in = 1,320 ft

**MAP**  
 ACCOMPANYING APPLICATION OF THE CROSS  
 COUNTRY CANAL COMPANY OF LOSTINE, OREGON  
 FOR A PERMIT TO APPROPRIATE WATER.  
 WALLOWA COUNTY, OREGON

Scale: 4" = 1 Mile

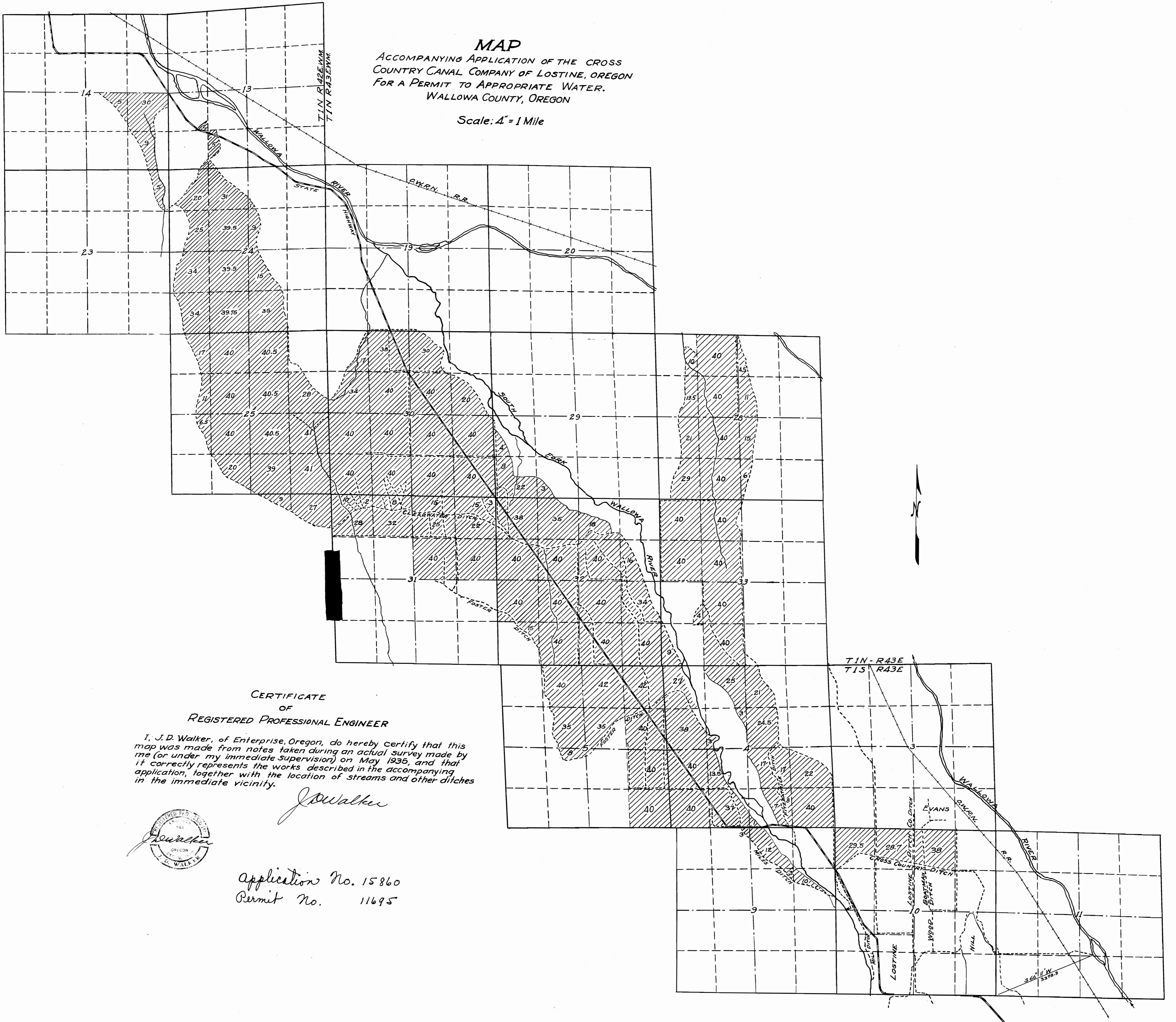

**CERTIFICATE  
 OF  
 REGISTERED PROFESSIONAL ENGINEER**

I, J. D. Walker, of Enterprise, Oregon, do hereby certify that this map was made from notes taken during an actual survey made by me (or under my immediate supervision) on May 1935, and that it correctly represents the works described in the accompanying application, together with the location of streams and other ditches in the immediate vicinity.

*J. D. Walker*



Application No. 15860  
 Permit No. 11695