

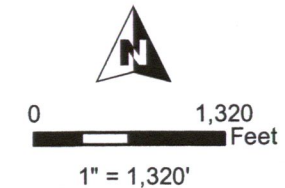





**T24S, R32E,
SECTION 11, WM**
HARNEY COUNTY, OREGON



-  POU IR Remaining
-  POU IR OFF
-  Section
-  QQ Lines
-  Tax Lots
-  Wells

Well # 1: 3218' N, 1381' W of SE Cor S11
Well # 2: 1301' N, 1329' W of SE Cor S11



RENEWAL DATE 12/31/2018



RECEIVED
 APR 05 2018
 OWRD

TRANSFER OFF MAP
Stalcup Ranch

CERT 89916

NOTE: THIS MAP IS NOT INTENDED TO
PROVIDE LEGAL DIMENSIONS OR LOCATIONS
OF PROPERTY OWNERSHIP LINES.

FEB 16, 2018

WATER RIGHT SERVICES, LLC
PO BOX 1830, BEND, OR 97709
CCB# 197121 www.oregonwater.us
541-389-2837 JOHNSHORT@USA.COM

T 24 S, R 32 E, WM

RECEIVED

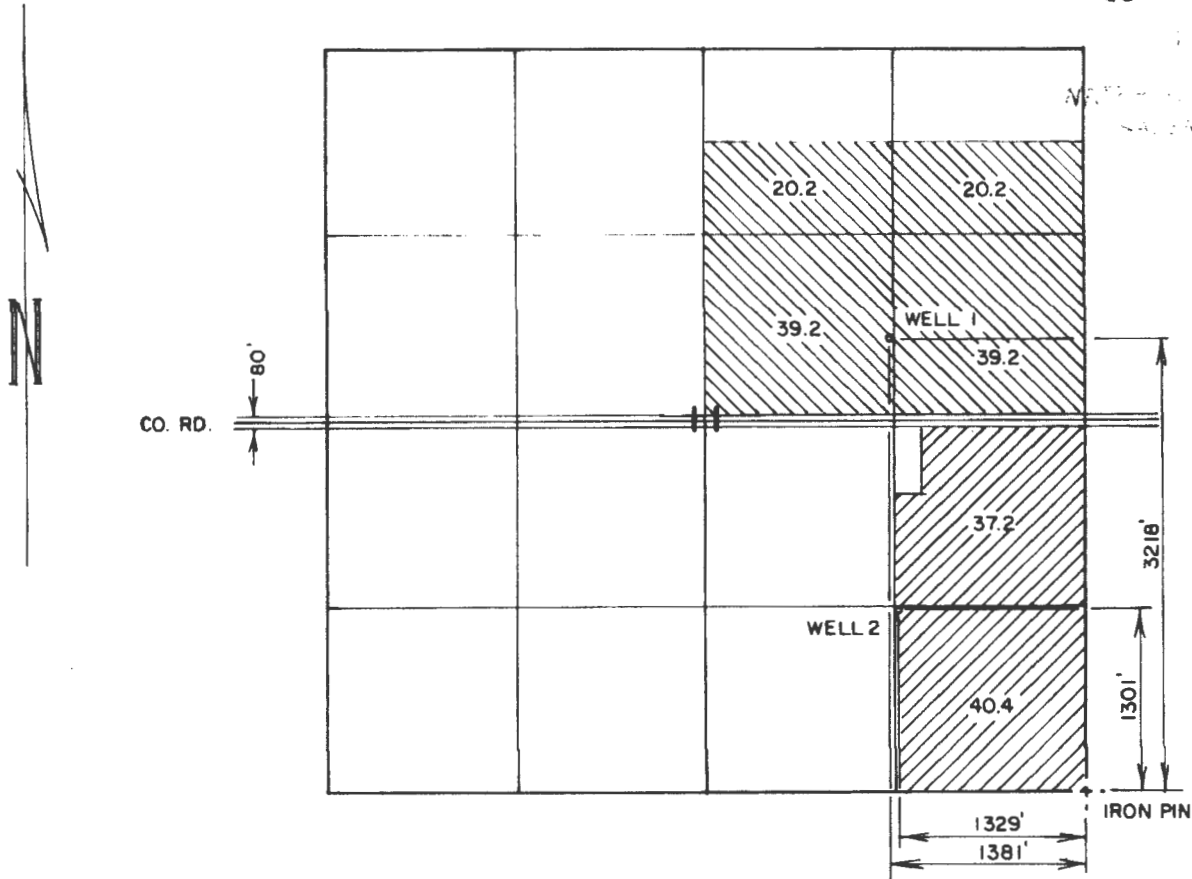

RECEIVED BY OWRD

JAN 10 2017

SALEM, OR

THE PURPOSE OF THIS MAP IS TO IDENTIFY THE LOCATION OF THE WATER RIGHT. IT IS NOT INTENDED TO PROVIDE INFORMATION RELATIVE TO THE LOCATION OF PROPERTY OWNERSHIP.

FINAL PROOF SURVEY

UNDER APPLICATION G-12463
PERMIT G-11785

IN THE NAME OF
CURTIS J. BLACKBURN

Scale: 4" = 1 MILE

Date: JAN. 1996

Job: 1295

Dsn:
Drm: CHRIS
Ckd:



M. A. PALMER & SONS, INC.
ENGINEERING & SURVEYING
254 N. Alder - Box 61
Burns, Oregon 97720

Sht. No.

of 1

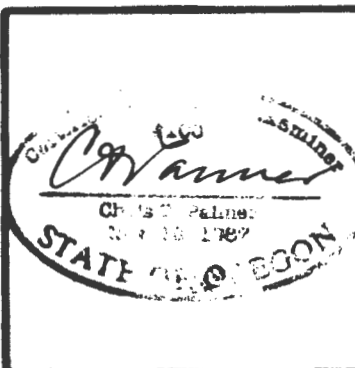





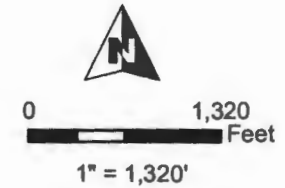
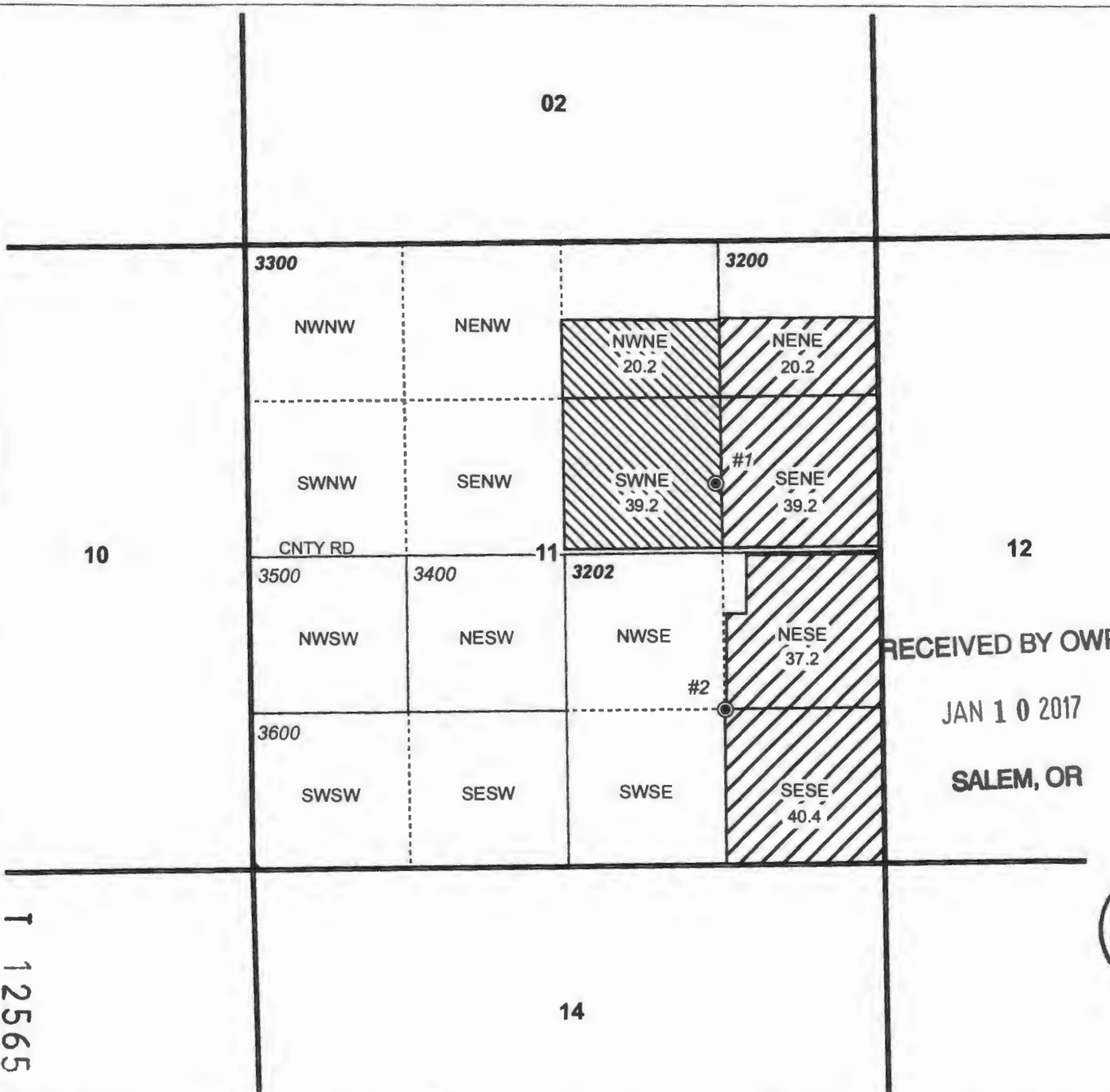

T 12565

**T24S, R32E,
SECTION 11, WM**
HARNEY COUNTY, OREGON



POU Irrigation

-  Transfer OFF
-  Remain ON
-  Section
-  Quarter Quarter
-  Tax Lot
-  Well

WELL LOCATIONS:

- #1: 3,218' N, 1,381' W OF SE COR SEC 11
- #2: 1,301' N, 1,329' W OF SE COR SEC 11

RECEIVED BY OWRD

JAN 10 2017

SALEM, OR

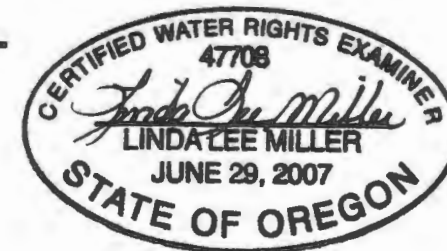

RENEWAL DATE 12/31/2018

**TRANSFER "OFF" MAP
WEDEL RANCH**

CERTIFICATE 89916

NOTE: THIS MAP IS NOT INTENDED TO
PROVIDE LEGAL DIMENSIONS OR LOCATIONS
OF PROPERTY OWNERSHIP LINES.

JANUARY 4, 2017

WATER RIGHT SERVICES, LLC

PO BOX 1830, BEND, OR 97709

CCB# 197121 www.oregonwater.us





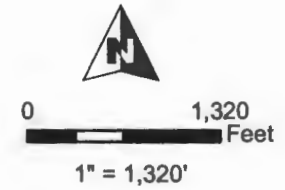

541-389-2837 JOHNSHORT@USA.COM

T
1
2565

**T23S, R33E,
SECTION 07, WM**
HARNEY COUNTY, OREGON



POU Irrigation

-  Transfer ON
-  Township
-  Section
-  Quarter Quarter
-  Tax Lot
-  Well
-  Stream

WELL LOCATION:
2,410' N, 870' E OF SW COR SEC 07

RECEIVED BY OWRD

JAN 10 2017

SALEM, OR



RENEWAL DATE 12/31/2018

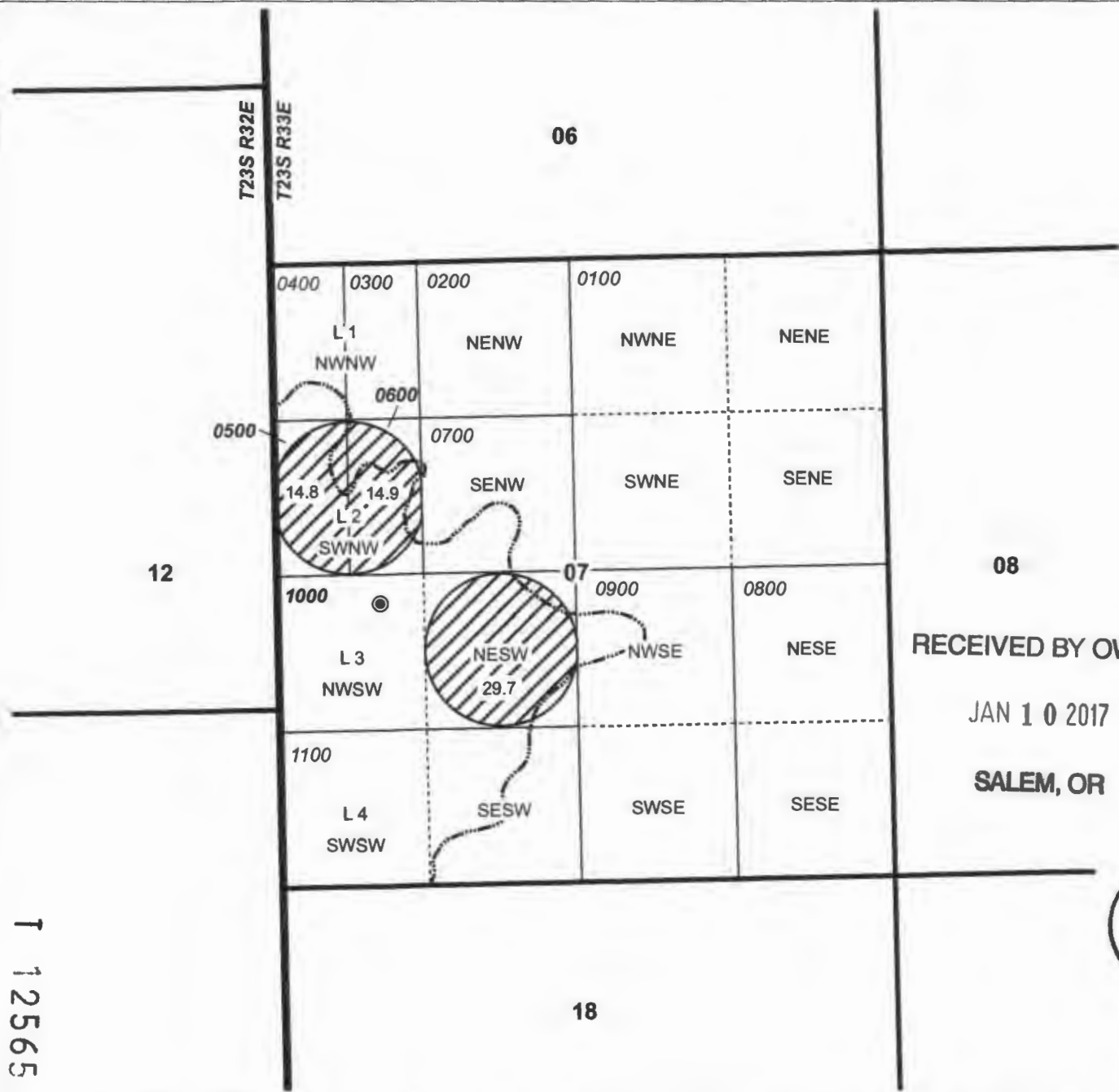

T 12565

**TRANSFER "ON" MAP
WEDEL RANCH**

CERTIFICATE 89916

NOTE: THIS MAP IS NOT INTENDED TO
PROVIDE LEGAL DIMENSIONS OR LOCATIONS
OF PROPERTY OWNERSHIP LINES.

JANUARY 4, 2017

WATER RIGHT SERVICES, LLC





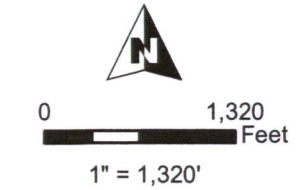
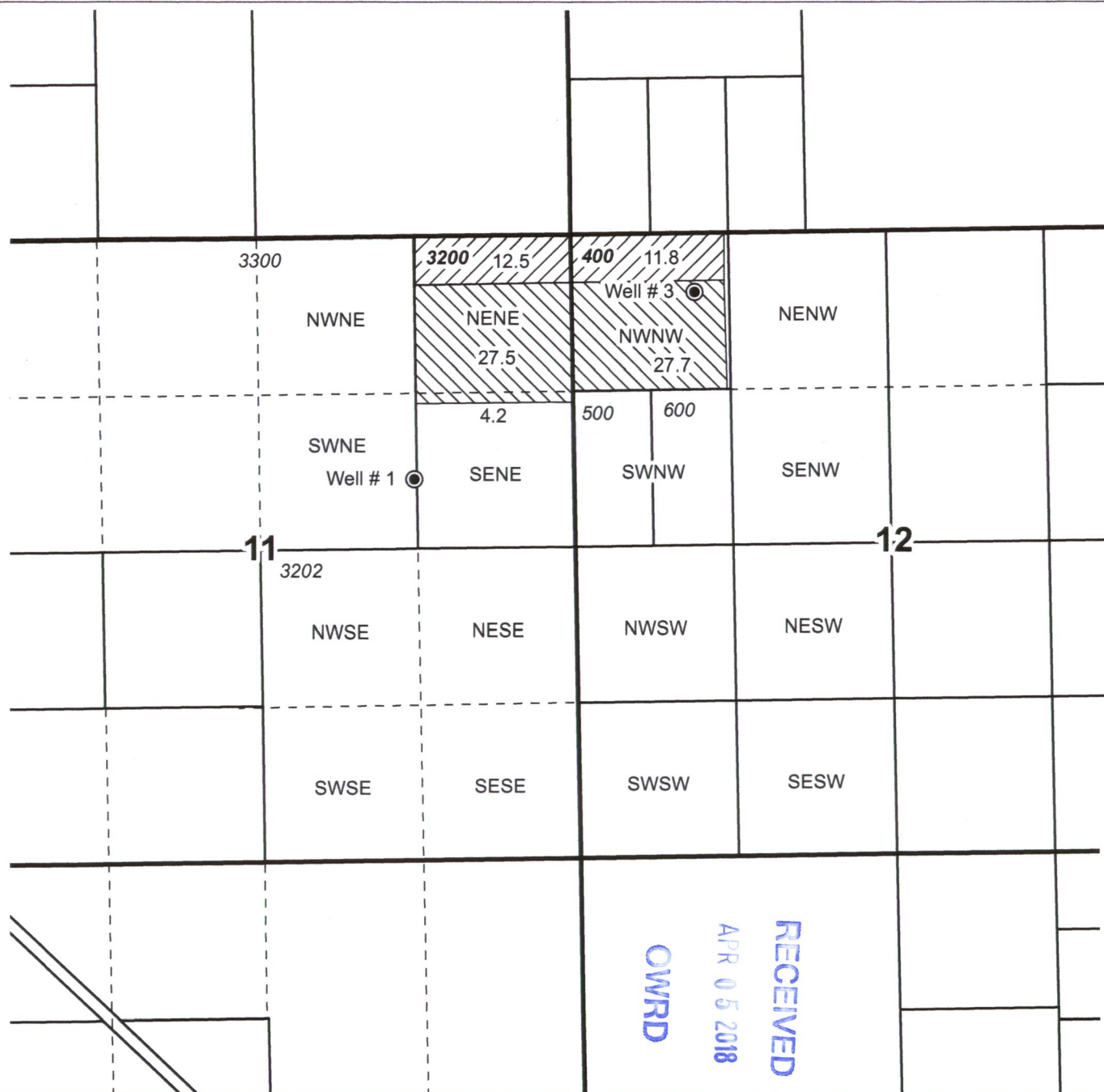

PO BOX 1830, BEND, OR 97709

CCB# 197121 www.oregonwater.us

541-389-2837 JOHNSHORT@USA.COM

**T24S, R32E,
SECTIONS 11 & 12, WM
HARNEY COUNTY, OREGON**



-  POU IR 4-1-1991
-  POU IR 11-5-2004
-  Section
-  QQ Lines
-  Tax Lots
-  Wells

Well # 1: 3218' N, 1381' W of SE Cor S11
Well # 3: 490' S, 1030' E of NW Cor S12

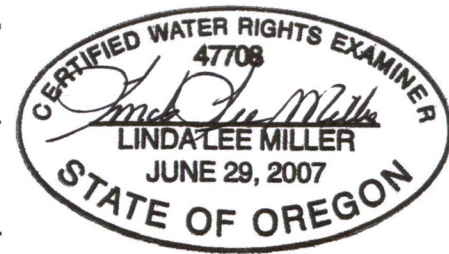

RENEWAL DATE 12/31/2018

RECEIVED
APR 05 2018
OWRD

**TRANSFER ON MAP
Stalcup Ranch**

CERT 89916

NOTE: THIS MAP IS NOT INTENDED TO
PROVIDE LEGAL DIMENSIONS OR LOCATIONS
OF PROPERTY OWNERSHIP LINES.

FEB 16, 2018

WATER RIGHT SERVICES, LLC
PO BOX 1830, BEND, OR 97709
CCB# 197121 www.oregonwater.us
541-389-2837 JOHNSHORT@USA.COM

**T24S, R33E,
SECTION 24, WM**
HARNEY COUNTY, OREGON







WELL:
1,310' N, 1,230' W OF
C 1/4 COR SEC 24

T24S R33E
T24S R34E



0 1,320 Feet

1" = 1,320'

-  POU IR Remaining
-  POU IR OFF
-  Section
-  Quarter Quarter
-  Tax Lot
-  Well

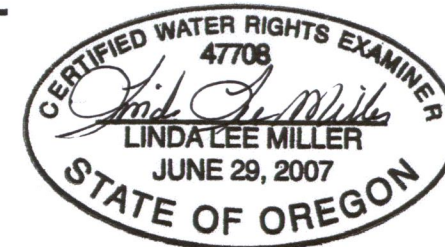
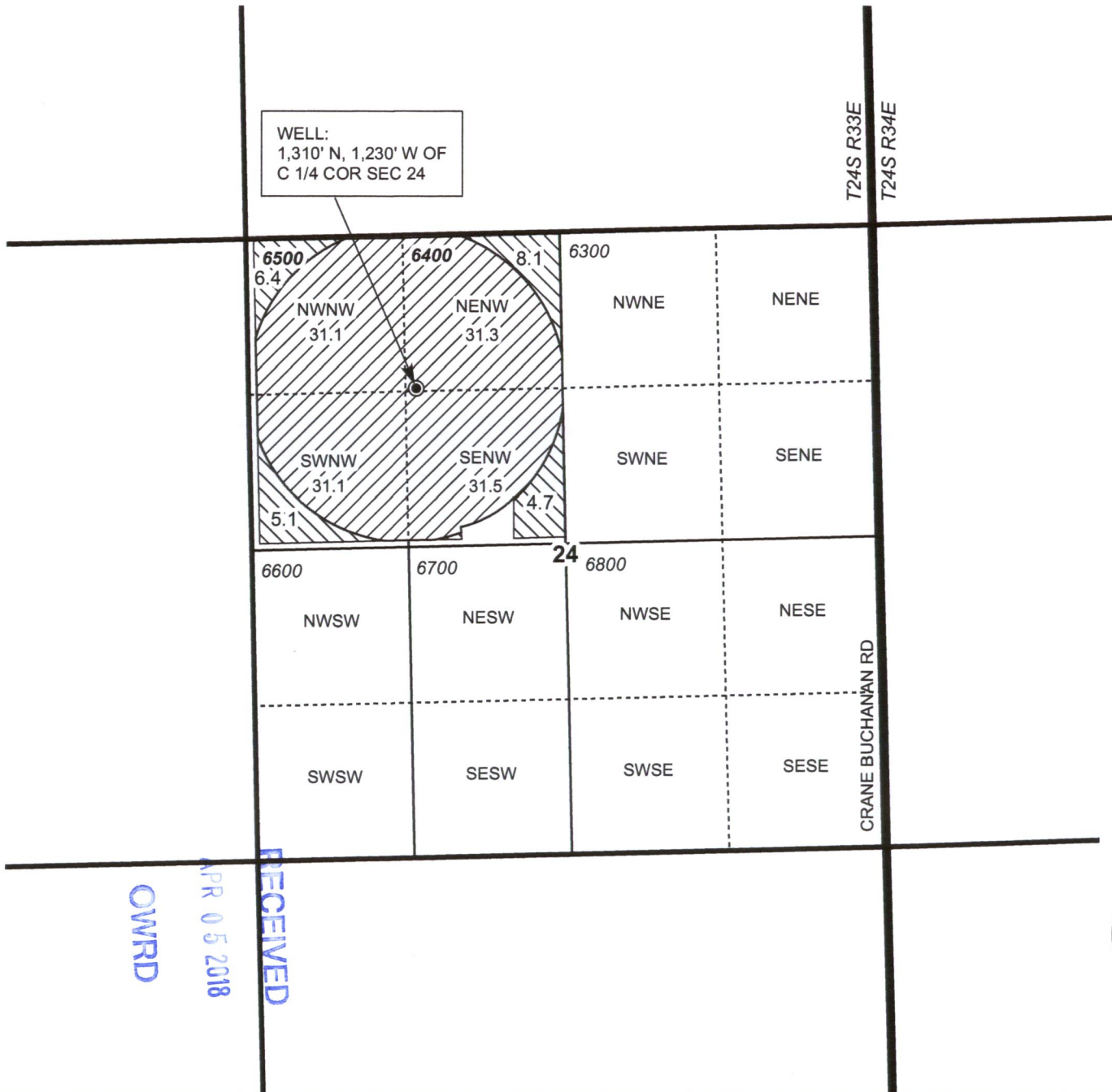

RENEWAL DATE 12/31/2018

TRANSFER MAP
Stalcup Ranch

CERT 92371

NOTE: THIS MAP IS NOT INTENDED TO
PROVIDE LEGAL DIMENSIONS OR LOCATIONS
OF PROPERTY OWNERSHIP LINES.

FEB 16, 2018

WATER RIGHT SERVICES, LLC

PO BOX 1830, BEND, OR 97709

CCB# 197121 www.oregonwater.us

541-389-2837 JOHNSHORT@USA.COM