

**Attachment 2D. Certificate
86337 Lamonta Well**

**Point of Appropriation and
Place of Use Map**

Crook County, Oregon
Township 14, 15 South,
Range 16 East (W.M.)

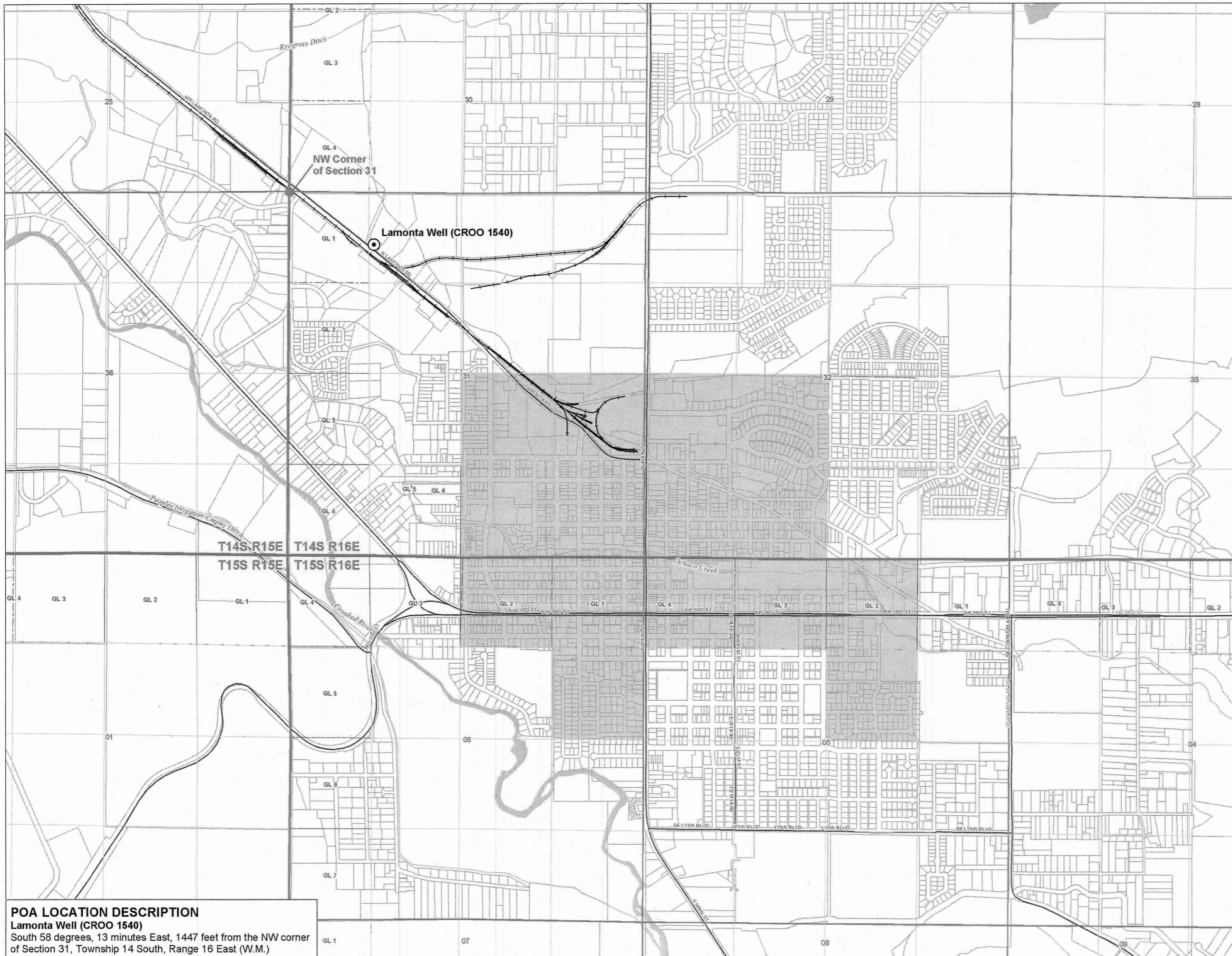

LEGEND

- Point of Appropriation (POA)
- Place of Use (POU)
- Government Lot (GL)
- All Other Features**
- Tax Lot
- Major Road
- Railroad
- Watercourse
- Waterbody

RECEIVED
MAY 03 2019
OWRD

13176

Certified Water Rights Examiner Stamp

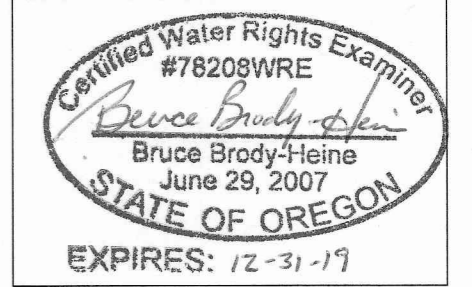

DISCLAIMER

This map was prepared for the purpose of identifying the location of a water right only and it is not intended to provide legal dimensions or location of property ownership lines.

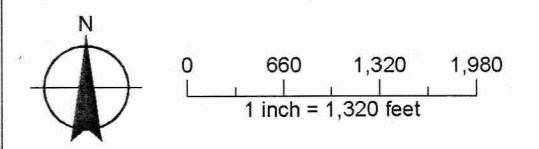

POA LOCATION DESCRIPTION
Lamonta Well (CROO 1540)
South 58 degrees, 13 minutes East, 1447 feet from the NW corner of Section 31, Township 14 South, Range 16 East (W.M.)

Date: April 17, 2019
Data Sources: OWRD, USGS, BLM, ESRI, City of Prineville

