

Application for Change in Point of Diversion & Place of Use

Elmwood Ranch, Inc - Russell Ricco / Roger & Janna Lee

Water Rights "From" Lands to be Transferred

Township 13 South, Range 33 East, Sections 17 & 18 W.M.

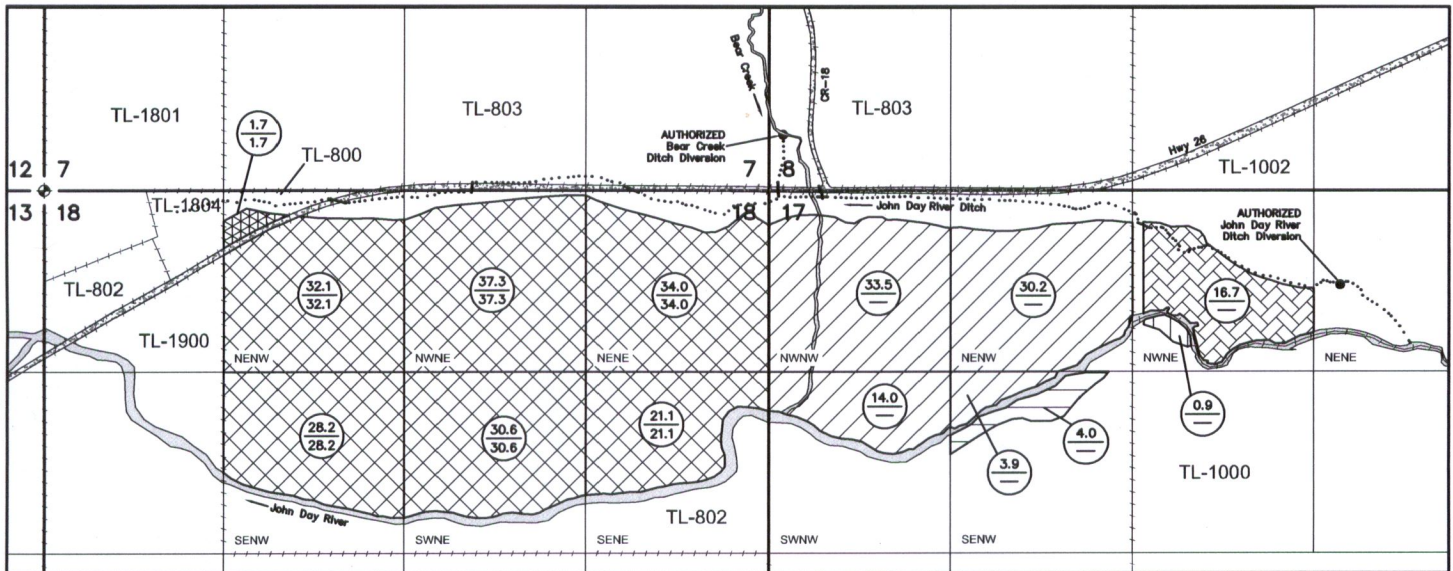

Scale: 1" = 1,320'

This map is not intended to provide legal dimensions or location of property ownership lines.

AUTHORIZED John Day River Ditch Diversion:
Township 13 South, Range 30 East
Section 17 W.M. NE $\frac{1}{4}$ NE $\frac{1}{4}$

RECEIVED

APR 19 2018

OWRD

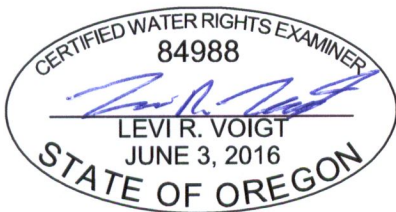

RENEWS:

LEGEND	
	Located Section Corner
	Property Boundary
	Irrigation Pipeline
	Irrigation Ditch
	Certificate No. 25272 (Xxxx)
	Certificate No. 25273 (Xxxx)
	Certificate Nos. 25272 & 25273 (Yyyy)
	Certificate No. 32398
	Primary Acres Supplemental Acres
	Certificate No. 25272 (not included in this transfer)
	Certificate No. 32398 (not included in this transfer)