

# Application for Change in Point of Diversion & Place of Use

Elmwood Ranch, Inc - Russell Ricco / Roger & Janna Lee

Water Rights "From" Lands to be Transferred

Township 13 South, Range 33 East, Sections 17 & 18 W.M.

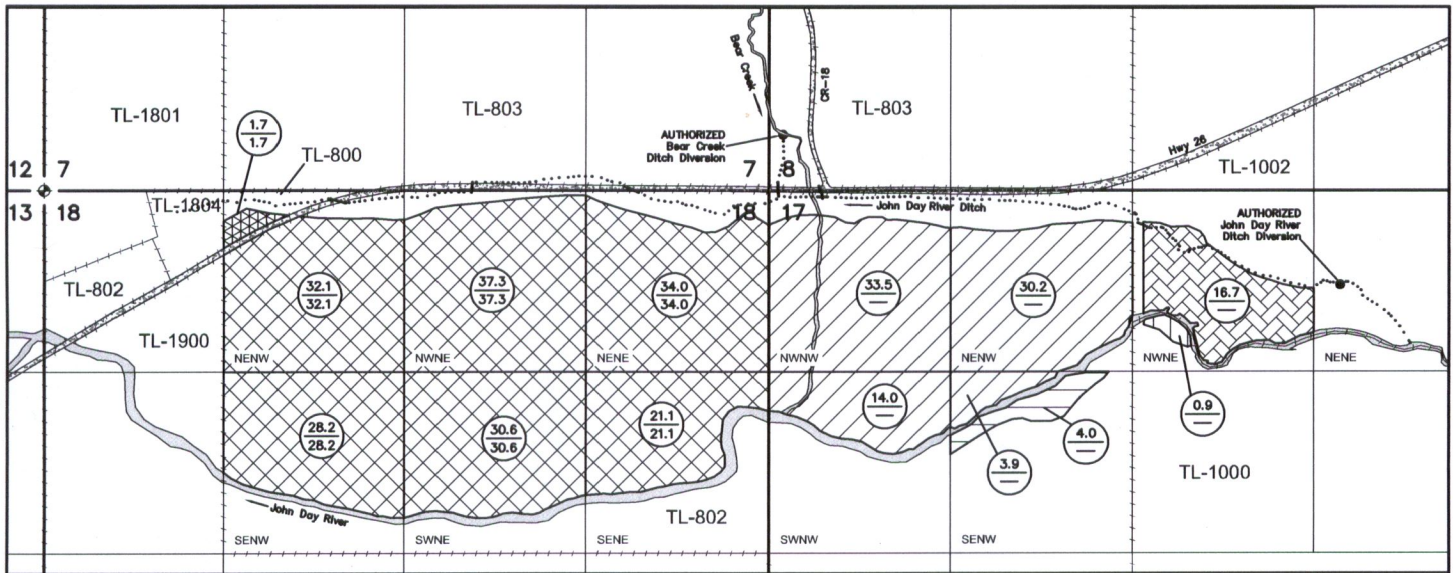

Scale: 1" = 1,320'

This map is not intended to provide legal dimensions or location of property ownership lines.

**AUTHORIZED John Day River Ditch Diversion:**  
Township 13 South, Range 30 East  
Section 17 W.M. NE $\frac{1}{4}$  NE $\frac{1}{4}$

RECEIVED

APR 19 2018

OWRD

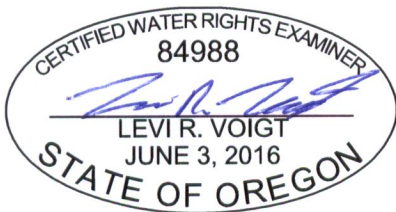

RENEWS:

LEGEND	
	Located Section Corner
	Property Boundary
	Irrigation Pipeline
	Irrigation Ditch
	Certificate No. 25272 (Xxxx)
	Certificate No. 25273 (Xxxx)
	Certificate Nos. 25272 & 25273 (Yyyy)
	Certificate No. 32398
	Primary Acres Supplemental Acres
	Certificate No. 25272 (not included in this transfer)
	Certificate No. 32398 (not included in this transfer)

# Application for Change in Point of Diversion & Place of Use

Elmwood Ranch, Inc - Russell Ricco / Roger & Janna Lee

Water Rights "To" Lands to be Transferred

Township 13 South, Range 33 East, Sections 17 & 18 W.M.

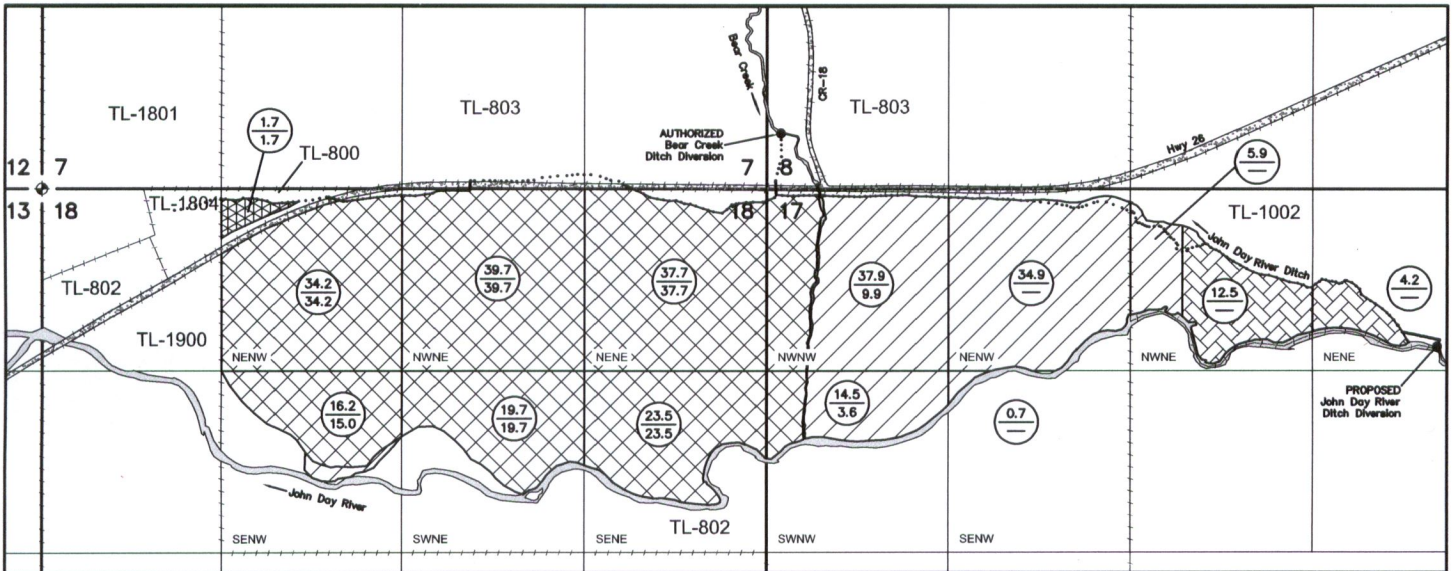

**Scale: 1" = 1,320'**

This map is not intended to provide legal dimensions or location of property ownership lines.

**PROPOSED John Day River Ditch Diversion:**  
 Township 13 South, Range 30 East  
 Section 17 W.M. NE $\frac{1}{4}$  NE $\frac{1}{4}$   
 N44.44274°, W118.75946°

RECEIVED

APR 19 2018

OWRD

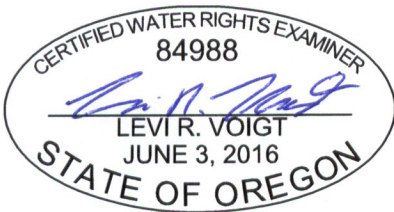

RENEWS:

LEGEND	
	Located Section Corner
	Property Boundary
	Irrigation Pipeline
	Irrigation Ditch
	Former Certificate No. 25272 (Xxxx)
	Former Certificate No. 25273 (Xxxx)
	Former Certificate Nos. 25272 & 25273 (Yyyy)
	Former Certificate No. 32398
	Primary Acres Supplemental Acres