

FINAL PROOF MAP

TO ADD PLACE OF USE AND A POINT OF APPROPRIATION
FOR PERMIT APPLICATION G-17744

SE 1/4 OF SECTION 18,
TOWNSHIP 26 SOUTH, RANGE 29 EAST, W.M.
TAX LOT: 1600

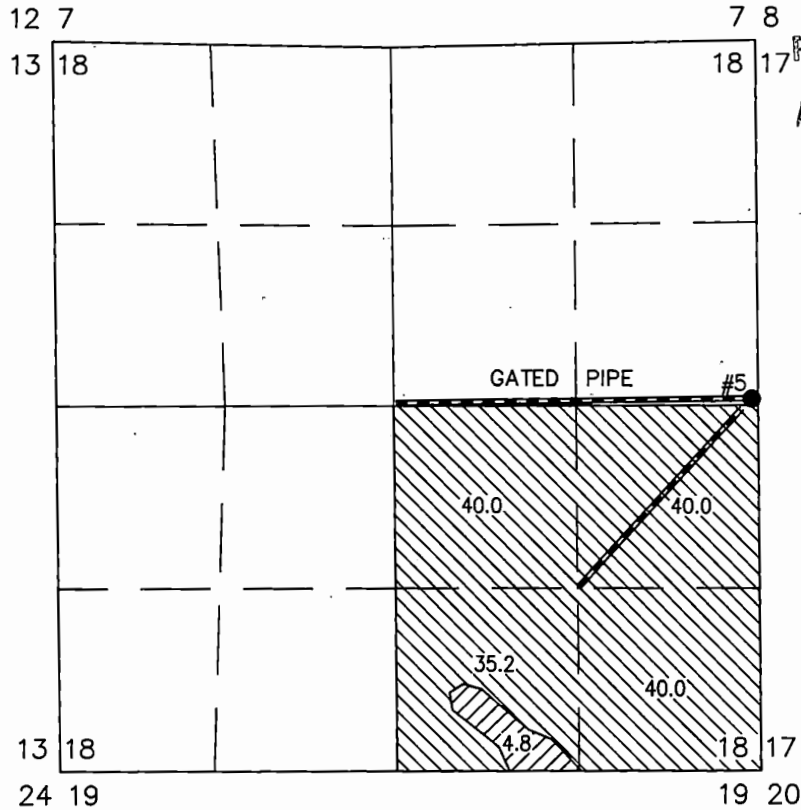



RECEIVED
AUG 19 2019
OWRD



● **#5 (HARN 52168)**

LOCATED IN THE SE 1/4 NE 1/4 SECTION 18, T26S
R29E, W.M. AND 150 FEET NORTH AND 50 FEET WEST
FROM THE E 1/4 CORNER OF SECTION 18. FLOW
METER LOCATED 10' W FROM WELL.

 4.8 AC IR FROM #5

 155.2 AC IS FROM #5



THIS MAP IS FOR THE PURPOSE OF LOCATING A WATER RIGHT
ONLY AND HAS NO INTENT TO PROVIDE LEGAL DIMENSIONS OR
THE LOCATION OF PROPERTY LINES

RENEWAL DATE: 12/31/2020

PREPARED FOR:

BILL AND LORI PEILA
P.O. BOX 723
HINES, OR 97738

PREPARED BY:



ALL POINTS ENGINEERING AND SURVEYING, INC.
P.O. BOX 767 TERREBONNE, OR 97760
(541) 548-5833 www.APEandS.com