

CLAIM OF BENEFICIAL USE KAY TOOLSSEN RESIDENCE

SE 1/4, SE 1/4, T18S, R4W, SEC 6
TL 1800 & 1900

JUNE 24, 2016

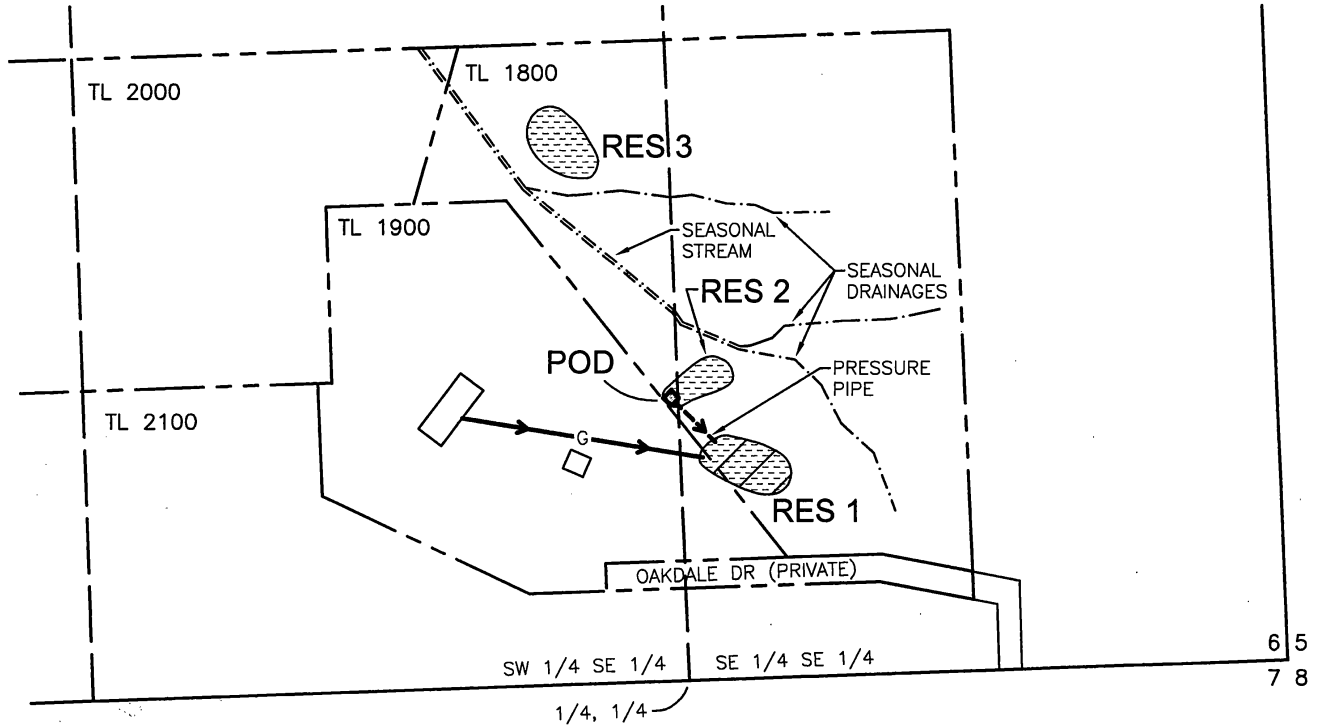

LEGEND

- SECTION LINE
- - - 1/4 SECTION LINE
- - - TAX LOT LINE
- - -> 1-1/2" PVC PRESSURE PIPE
- > G -> 4" GRAVITY PIPE FROM ROOF DRAINS & PAVED DRIVEWAYS
- ◆ POINT OF DIVERSION (POD)
- ▭ STRUCTURE
- ▨ PERMITTED RESERVOIR

POD

625' NORTH OF AND
1,335' WEST OF SE SECTION CORNER

PERMIT # R-13323
APPLICATION # R-84659

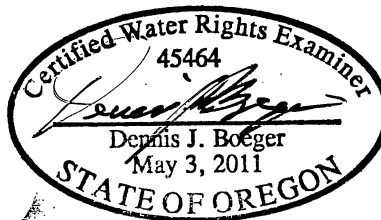

EXPIRES: 12/31/2017

SCALE: 1" = 400'

Boeger & Associates, LLC
1158 High Street, Suite #102
Eugene, OR 97401
Ph: 541.302.4996
Fax: 541.302.4968
dboeger@boegerassociates.com

DISCLAIMER

THIS MAP IS NOT INTENDED TO PROVIDE
LEGAL DIMENSIONS OR LOCATIONS OF
PROPERTY OWNERSHIP LINES.