

# Sec. 11, S1/2 of Sec. 2, N1/2 of Sec. 14 Township 39 South, Range 5 West, W.M.

RECEIVED  
DEC 20 2019  
OWRD

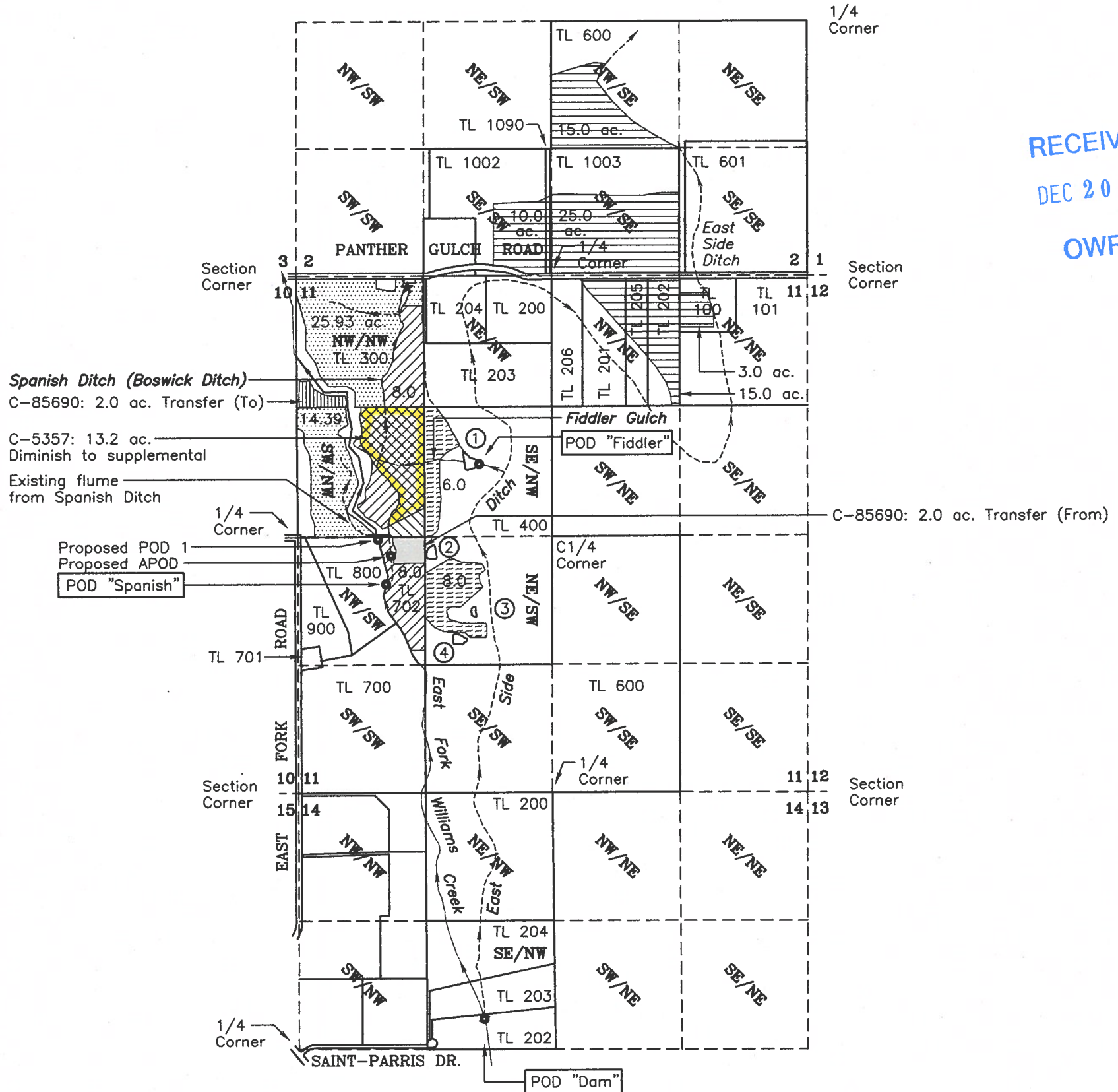

## LEGEND:

- |  |   |
|--|---|
| <ul style="list-style-type: none"> <li> Place of Use (POU) per Certificate No. 16330 (1875)<br/>Not part of transfer application; shown to clarify POU.<br/>NW1/4NW1/4 Sec. 11 = 25.93 Acres<br/>SW1/4NW1/4 Sec. 11 = 14.39 Acres</li> <li> Place of Use per Certificate No. 85690 (Aug. 3, 1915)<br/>NW1/4NW1/4 Sec. 11 = 8.0 Acres<br/>SW1/4NW1/4 Sec. 11 = 17.0 Acres<br/>NW1/4SW1/4 Sec. 11 = 10.0 Acres (Total Existing)<br/>8.0 remains unchanged; 2.0 ac. to be transferred to NW1/4NW1/4 Sec. 11.</li> <li> Place of Use per Certificate No. 85690 (Remainder)<br/>Unchanged by this transfer; Priority Date = Aug. 3, 1915<br/>Acreages as shown.</li> <li> Area of POU transfer FROM (C-85690: 2.0 Acres)</li> <li> Area of POU transfer TO (C-85690: 2.0 Acres)</li> <li>② Pond number per Exempt Reservoir Permit No. P-74225</li> <li>★ Auxiliary Pump Site (1160'E &amp; 120'S of the NW Corner, Sec. 11)</li> <li>APOD Additional point of diversion</li> </ul> | <ul style="list-style-type: none"> <li> Place of Use per Certificate No. 5357 (Sept. 10, 1918)<br/>SW1/4NW1/4 Sec. 11 = 15.0 Acres (Total Existing):<br/>1.8 ac. remain primary; 13.2 ac. diminish to supplemental.</li> <li> Place of Use per Certificate No. 8861<br/>Unchanged by this transfer; Priority Date = April 24, 1920<br/>SE1/4NW1/4 Sec. 11 = 6.0 Acres<br/>NE1/4SW1/4 Sec. 11 = 8.0 Acres</li> <li> Existing Ditch (Named ditches as shown)</li> <li> Point of Diversion (POD) as shown<br/>Authorized POD "Dam": to be abandoned<br/>(1930'E &amp; 320'N of W1/4 Corner, Sec. 14)<br/>Authorized POD "Fiddler"<br/>(1890'E &amp; 760'N of W1/4 Corner, Sec. 11)<br/>Authorized POD "Spanish"<br/>(920'E &amp; 490'S of W1/4 Corner, Sec. 11)<br/>Proposed POD 1<br/>(840'E &amp; 20'S of W1/4 Corner, Sec. 11)<br/>Additional POD (APOD)<br/>(970'E &amp; 190'S of W1/4 Corner, Sec. 11)</li> </ul> |
|--|---|

This map is not intended to provide legal dimensions or locations of property ownership lines.

PROJECT NO.  
1281-17-779

DRAWING NO.  
183-11.17

REVISION DATE:  
12-06-19

SCALE:  
1" = 1320'

SHEET NO.  
1 of 1

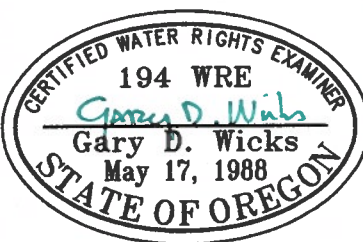

RENEWAL DATE: 6-30-20

## APPLICATION MAP FOR TRANSFER NO. T-12832

LOCATED IN  
Section 11, South 1/2 of Section 2, and North 1/2 of Section 14  
Township 39 South, Range 5 West, W.M.  
Josephine County, Oregon

PREPARED FOR:  
**Gregg & Wilma Hyde**  
501 Panther Gulch Road  
Williams, OR 97544  
Tel: 541-846-6469

PREPARED BY:  
**WICKS ENGINEERING & SURVEYING**  
311 N.E. "D" Street  
Grants Pass, Oregon 97526  
Tel. (541) 479-3436 Fax (541) 479-1014