

Water Rights Examination Map for Portions of
 Certificate #42875 and Certificate #50378
 T. 39 S., R. 5 W., W. M., Josephine County
 Section 11, NE1/4 NE1/4

July 22, 2007

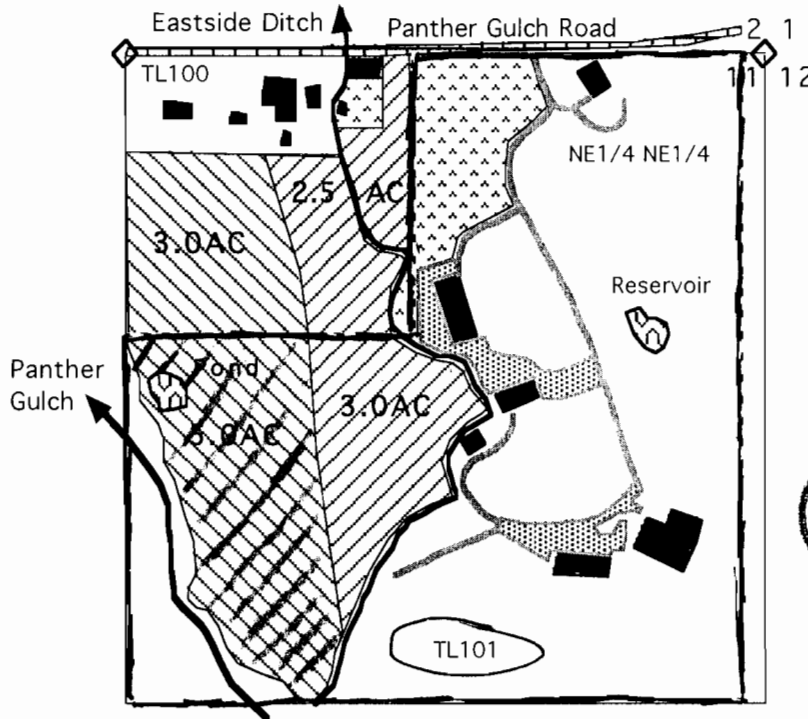

N
RECEIVED
 AUG 20 2007
 WATER RESOURCES DEPT
 1" = 400' SALEM, OREGON

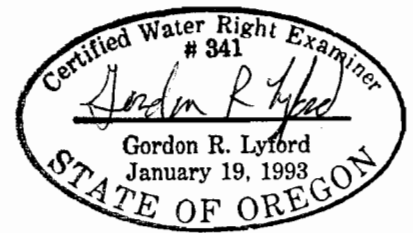

7-22-2007
 exp 12-31-2008

■ Buildings ▨ Roads and Parking Lots

▩ Reservoir constructed under Permit # R-46968, and an unauthorized pond.

The POD for the Eastside Ditch is from the East Fork of Williams Creek in the SE1/4 NW1/4 of Sec 14, T 39S, R5W, WM.

▧ 8.0 acres irrigated under Certificate #42875 with a priority of August 3, 1915.

▨ 5.5 acres irrigated under Certificate #50378 with a priority of November 24, 1915.

▩ 2.5 acres abandoned under Certificate #50378 (0.5 acres in TL100 and 2.0 acres in TL101).

T-4741 was approved on June 17, 1981 to transfer the POU of 2.0 acres within TL100. T-4741 resulted in the cancellation of C #2192, the issuance of remaining right C #50378, and the issuance of confirming C #61745 for the new POU. However, after reviewing past mapping it appears that T-4741 actually transferred 1.0 acres each from both C #2192 and C #42875 (in the northwest corner of TL100) and applied those 2.0 acres to an area already covered by C #2192 (along the east side of TL100). Consequently T-4741 effectively only accomplished the cancellation of those 2.0 acres of irrigation rights.

Water right certificates #42875 and #50378 together confirm 16.0 acres for irrigation in this 1/4 - 1/4 section. Past maps for those water rights delineated too much area. This map identifies water rights found to be irrigated under those two certificates, and the water rights found abandoned under certificate #50378.

Tax lot 101 also has 7.0 acres of irrigation rights from a spring and reservoir under certificate #65725. Tax lot 100 also has 2.0 acres of primary irrigation rights and 5.63 acres of supplemental irrigation rights from a well under certificate #62114.

This map was drawn by Gordon R. Lyford for Joseph B. and Pamela R. Fichtner to identify their irrigation water rights from the East Fork of Williams Creek. The Fichtners own tax lot 101. Jim and Barb Rigel own tax lot 100.

This map was prepared for the purpose of identifying the location of water rights only and is not intended to provide legal dimensions or the location of property ownership lines.

CANCEL
 5.0 AC

SEP 19 2007

G-16931

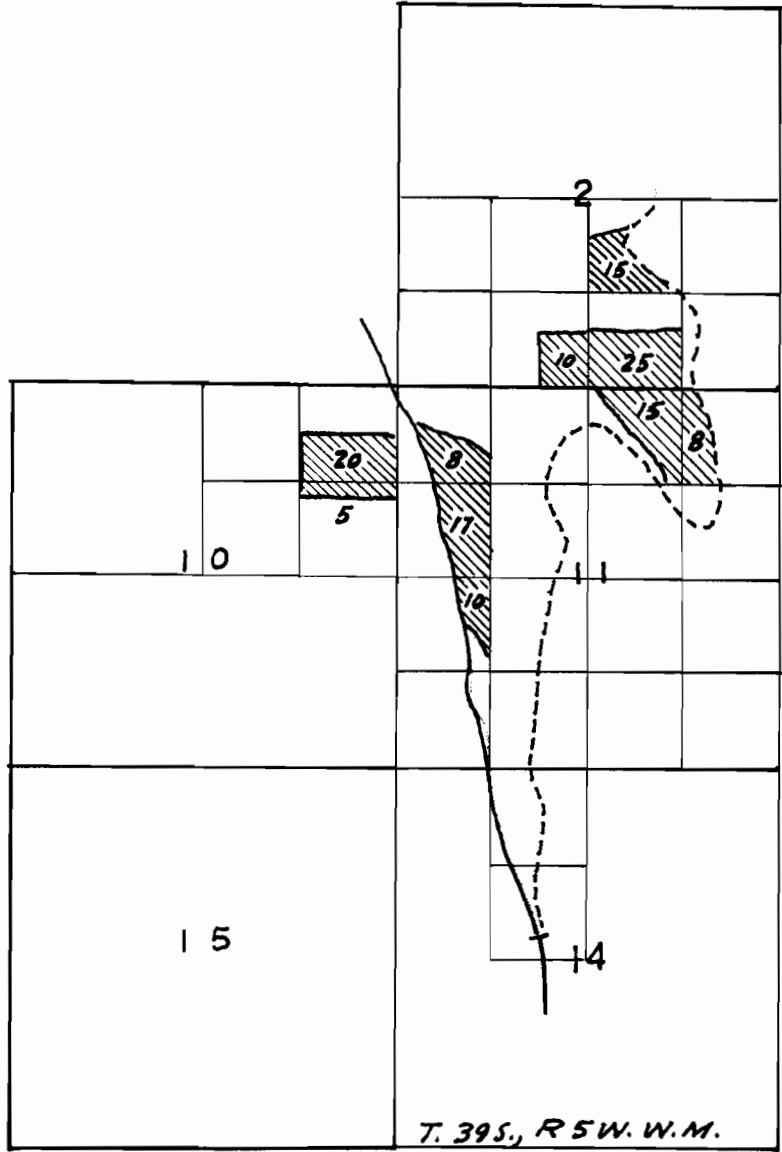

sketched from app. map

A-4438

Sec. 11, S1/2 of Sec. 2, N1/2 of Sec. 14 Township 39 South, Range 5 West, W.M.

RECEIVED
DEC 20 2019
OWRD

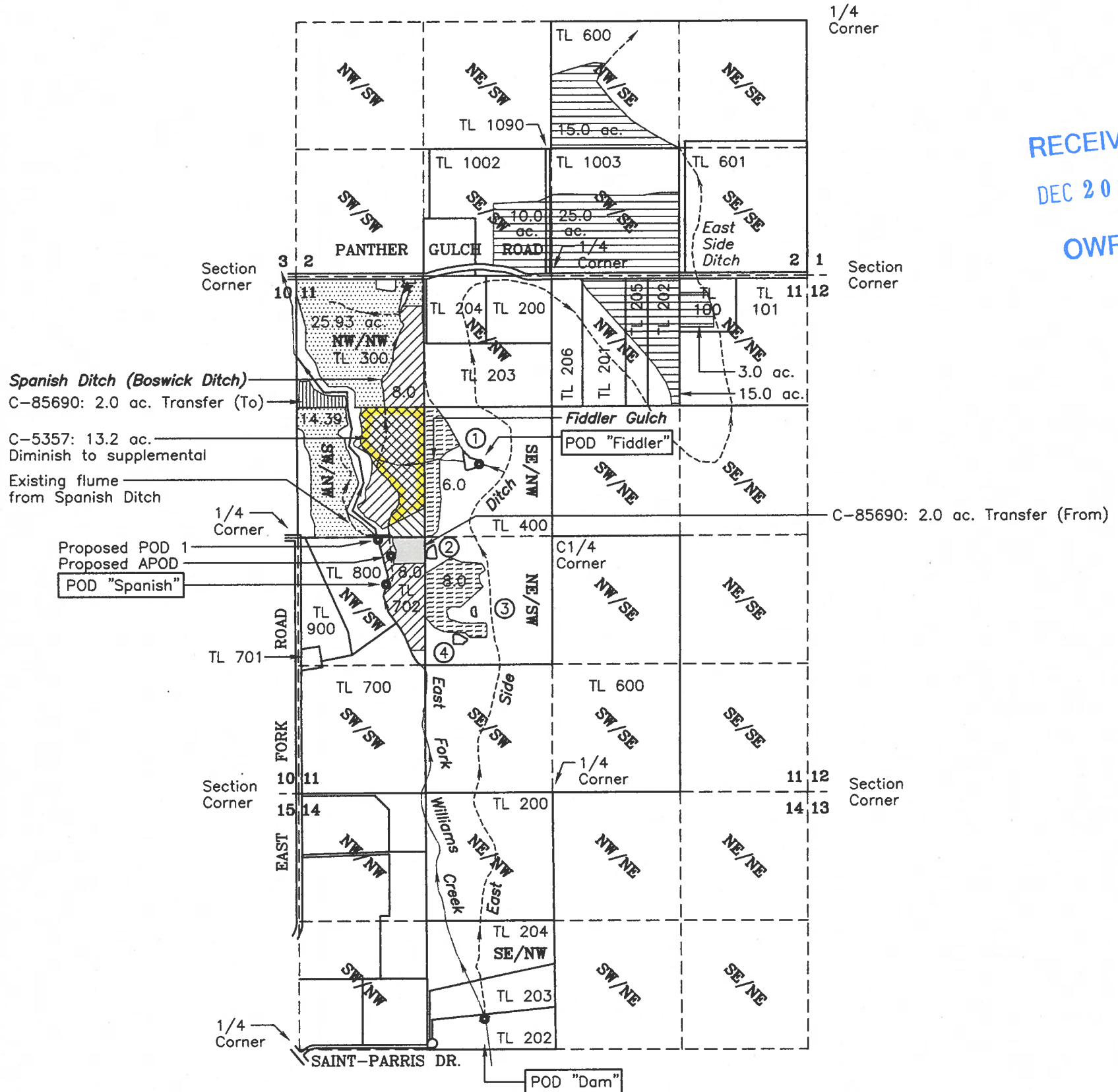

LEGEND:

- | | |
|--|---|
| <ul style="list-style-type: none"> Place of Use (POU) per Certificate No. 16330 (1875)
Not part of transfer application; shown to clarify POU.
NW1/4NW1/4 Sec. 11 = 25.93 Acres
SW1/4NW1/4 Sec. 11 = 14.39 Acres Place of Use per Certificate No. 85690 (Aug. 3, 1915)
NW1/4NW1/4 Sec. 11 = 8.0 Acres
SW1/4NW1/4 Sec. 11 = 17.0 Acres
NW1/4SW1/4 Sec. 11 = 10.0 Acres (Total Existing)
8.0 remains unchanged; 2.0 ac. to be transferred to NW1/4NW1/4 Sec. 11. Place of Use per Certificate No. 85690 (Remainder)
Unchanged by this transfer; Priority Date = Aug. 3, 1915
Acreages as shown. Area of POU transfer FROM (C-85690: 2.0 Acres) Area of POU transfer TO (C-85690: 2.0 Acres) ② Pond number per Exempt Reservoir Permit No. P-74225 ★ Auxiliary Pump Site (1160'E & 120'S of the NW Corner, Sec. 11) APOD Additional point of diversion | <ul style="list-style-type: none"> Place of Use per Certificate No. 5357 (Sept. 10, 1918)
SW1/4NW1/4 Sec. 11 = 15.0 Acres (Total Existing):
1.8 ac. remain primary; 13.2 ac. diminish to supplemental. Place of Use per Certificate No. 8861
Unchanged by this transfer; Priority Date = April 24, 1920
SE1/4NW1/4 Sec. 11 = 6.0 Acres
NE1/4SW1/4 Sec. 11 = 8.0 Acres Existing Ditch (Named ditches as shown) Point of Diversion (POD) as shown
Authorized POD "Dam": to be abandoned
(1930'E & 320'N of W1/4 Corner, Sec. 14)
Authorized POD "Fiddler"
(1890'E & 760'N of W1/4 Corner, Sec. 11)
Authorized POD "Spanish"
(920'E & 490'S of W1/4 Corner, Sec. 11)
Proposed POD 1
(840'E & 20'S of W1/4 Corner, Sec. 11)
Additional POD (APOD)
(970'E & 190'S of W1/4 Corner, Sec. 11) |
|--|---|

This map is not intended to provide legal dimensions or locations of property ownership lines.

PROJECT NO.
1281-17-779

DRAWING NO.
183-11.17

REVISION DATE:
12-06-19

SCALE:
1" = 1320'

SHEET NO.
1 of 1

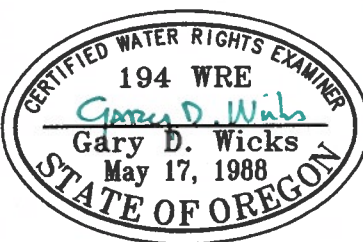

RENEWAL DATE: 6-30-20

APPLICATION MAP FOR TRANSFER NO. T-12832

LOCATED IN
Section 11, South 1/2 of Section 2, and North 1/2 of Section 14
Township 39 South, Range 5 West, W.M.
Josephine County, Oregon

PREPARED FOR:
Gregg & Wilma Hyde
501 Panther Gulch Road
Williams, OR 97544
Tel: 541-846-6469

PREPARED BY:
WICKS ENGINEERING & SURVEYING
311 N.E. "D" Street
Grants Pass, Oregon 97526
Tel. (541) 479-3436 Fax (541) 479-1014