

KLAMATH COUNTY, OREGON
T 24 S, R 7 E, WM
SECTION 20

0 200 400
 Feet

1" = 400'

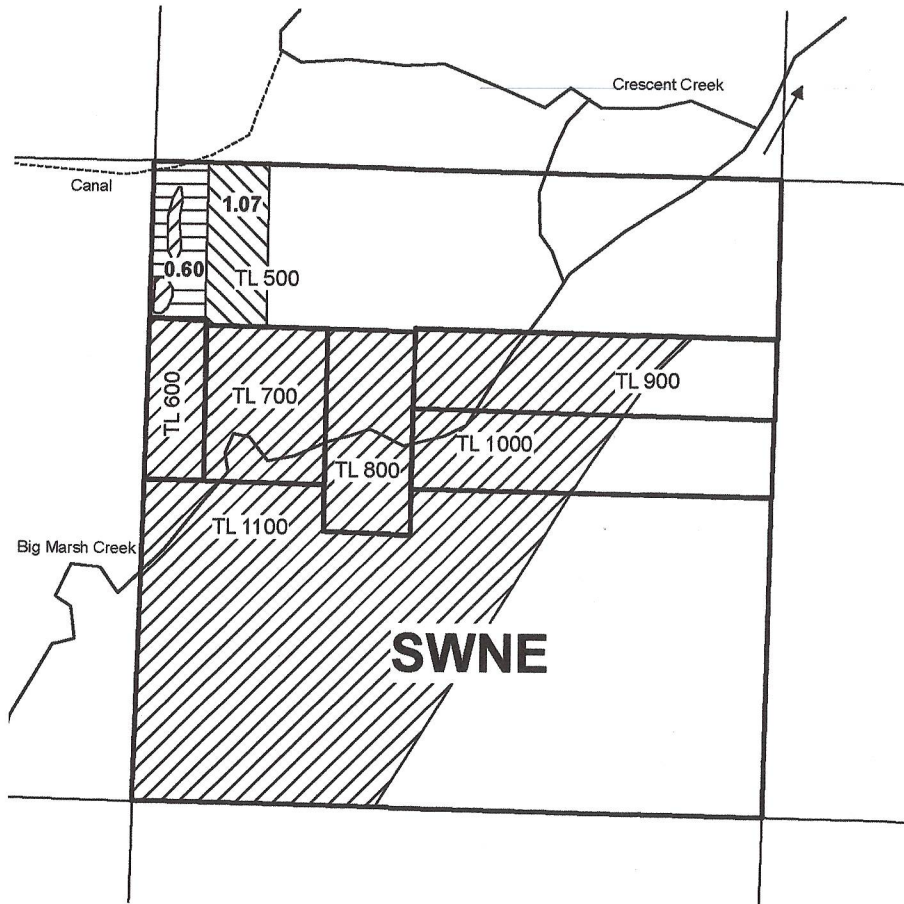

1" = 1320'

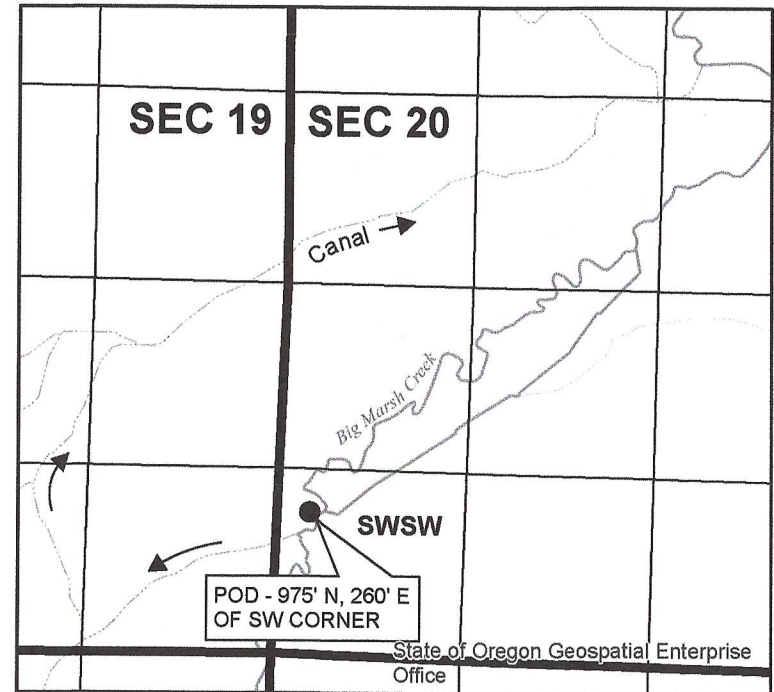

- POU OFF T-12860 (1.07 ac)
- POU OFF T-11508 (0.60 ac)
- POU IR REMAINING (20.35 ac)
- TAXLOT BOUNDARIES



RENEWAL DATE 12/31/2020

PERMANENT INSTREAM TRANSFER MAP
Diamond Meadows #1384 HOA Inc.

CERTIFICATE 91836

NOTE: THIS MAP IS NOT INTENDED TO
 PROVIDE LEGAL DIMENSIONS OR LOCATIONS
 OF PROPERTY OWNERSHIP LINES.

Date: 10/15/2019

WATER RIGHT SERVICES, LLC
 PO BOX 1830, BEND, OR 97709

CCB # 197121 WWW.OREGONWATER.US
 541-389-2837 JOHNSHORT@USA.COM