



T23S R32.5E, WM
HARNEY COUNTY, OR

Well (L-113438) Location:
70' S, 2260' W of
NE Cor Sec 21



0 1,320
Feet

1" = 1,320'

- Well & Meter
- Pipeline
-  POU IR
-  Section
- Quarter Quarter
-  Taxlot

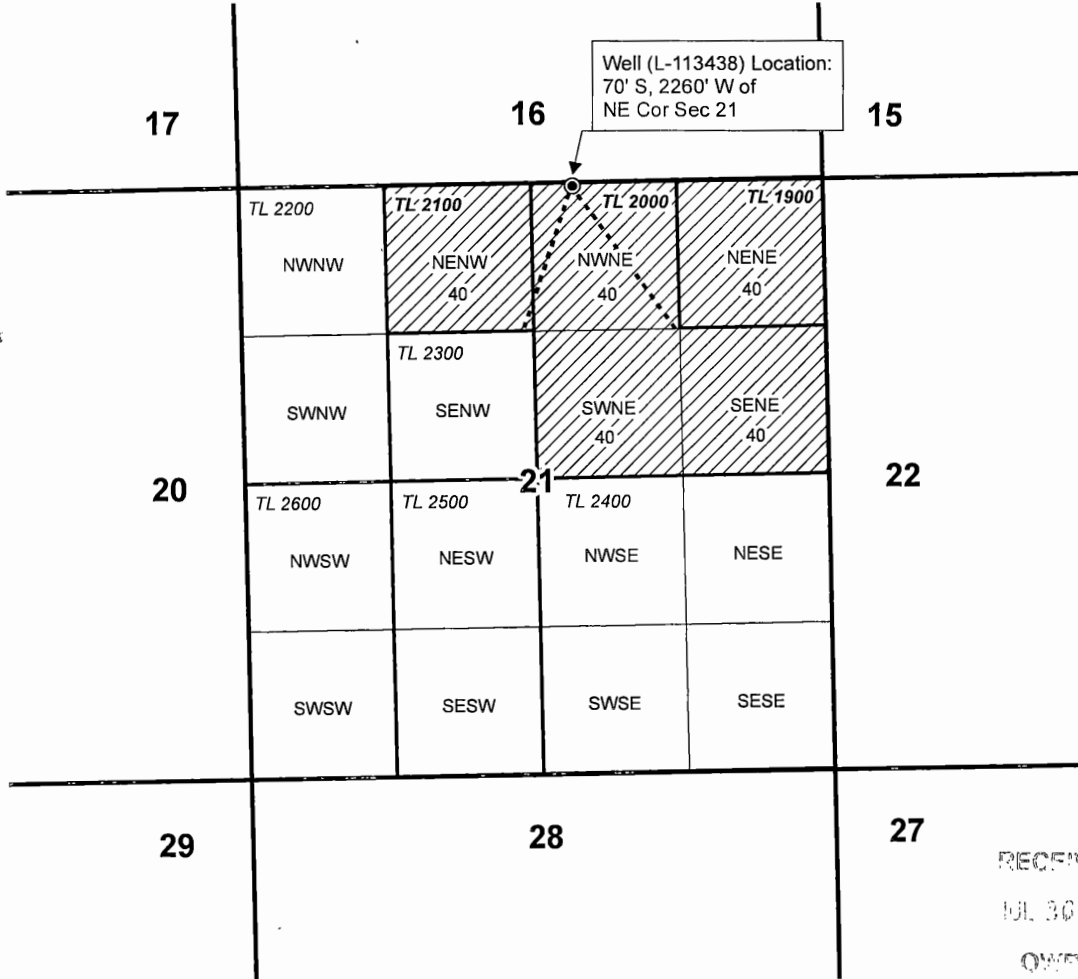

RENEWAL DATE 12/31/2019

RECEIVED

JUL 30 2019

OWR



CLAIM OF BENEFICIAL USE MAP
Ron Wedel Ranch

This map is not intended
to provide legal dimensions
or locations of property
ownership lines.

WATER RIGHT SERVICES, LLC
PO BOX 1830, BEND, OR 97709
WWW.OREGONWATER.US CCB # 197121
johnshort@usa.com 541-389-2837

Date: 6/27/2019

Ap G-17776

Permit G-17279

Project #19019