

# FINAL PROOF SURVEY MAP IN THE NAME OF DANIEL E. DAVIS

Application S-73753

Permit 52138

SECTION 6, TOWNSHIP 29 SOUTH, RANGE 14 WEST, W.M.

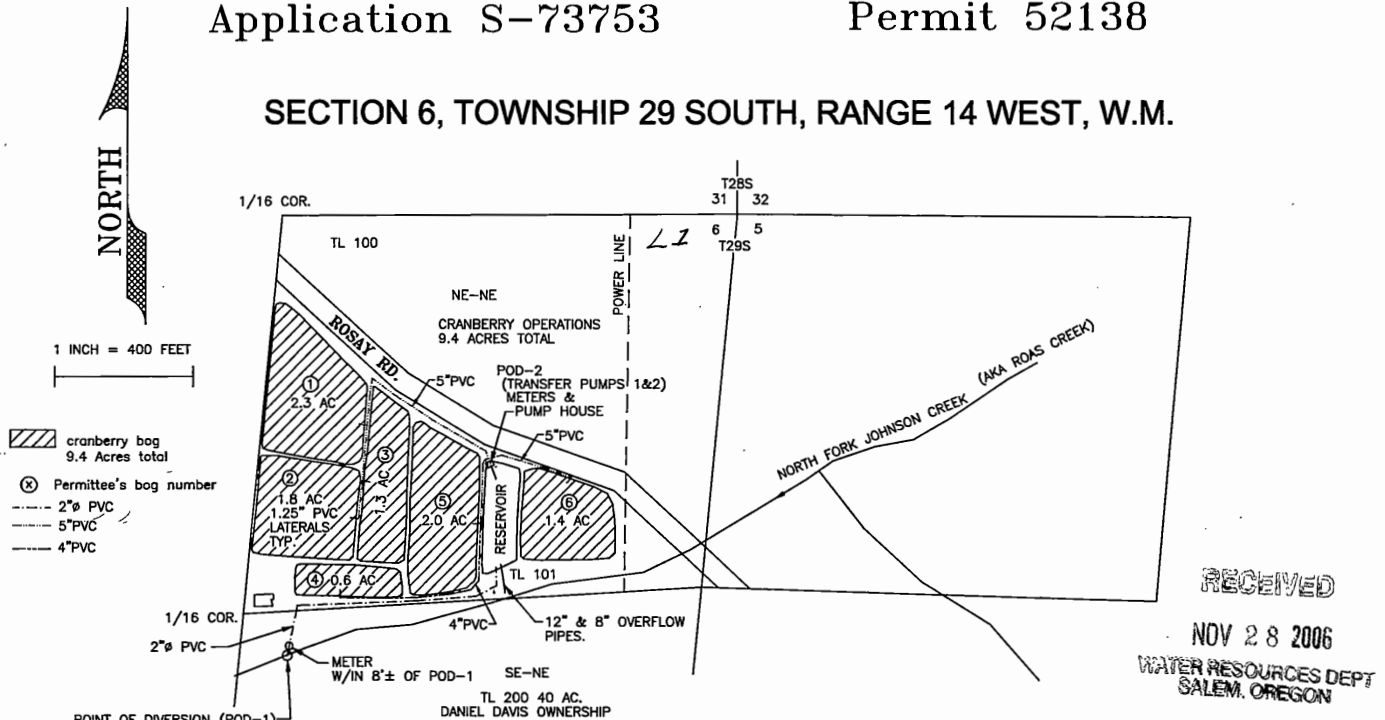

- cranberry bog  
9.4 Acres total
- Permittee's bog number
- 2" PVC
- 5" PVC
- 4" PVC

RECEIVED  
NOV 28 2006  
WATER RESOURCES DEPT  
SALEM, OREGON

**CREEK:** THE POINT OF DIVERSION IS LOCATED 1259 SOUTH AND 1297 WEST FROM THE NORTHEAST CORNER OF SECTION 6; BEING WITHIN THE SE¼ NE¼ OF SECTION 6, TOWNSHIP 29 SOUTH, RANGE 14 WEST, W.M. COOS COUNTY.

**RESERVOIR:** THE POINT OF DIVERSION IS LOCATED 718 SOUTH AND 708 WEST FROM THE NORTHEAST CORNER OF SECTION 6; BEING WITHIN THE SE¼ NE¼ OF SECTION 6, TOWNSHIP 29 SOUTH, RANGE 14 WEST, W.M. COOS COUNTY.

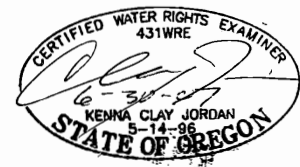

THE PURPOSE OF THIS MAP IS TO IDENTIFY THE LOCATION OF THE WATER RIGHT.  
IT IS NOT INTENDED TO PROVIDE INFORMATION RELATIVE TO THE LOCATION OF  
PROPERTY OWNERSHIP BOUNDARY LINES.

*Added gov lot # in NENE, sec. 6. MB/OWRD 7-17-15*