

**T24S R30E &  
T24S R29E, WM**  
HARNEY COUNTY  
OREGON



0 1,320  
Feet  
1" = 1,320'

● Well & Meter

----- Pipeline

 POU IR (2-19-2008)

 POU IS (2-19-2008)

 Township

 Section

----- Quarter Quarter

 Taxlot

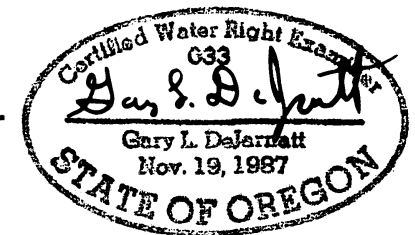

RENEWAL DATE 12/31/2019

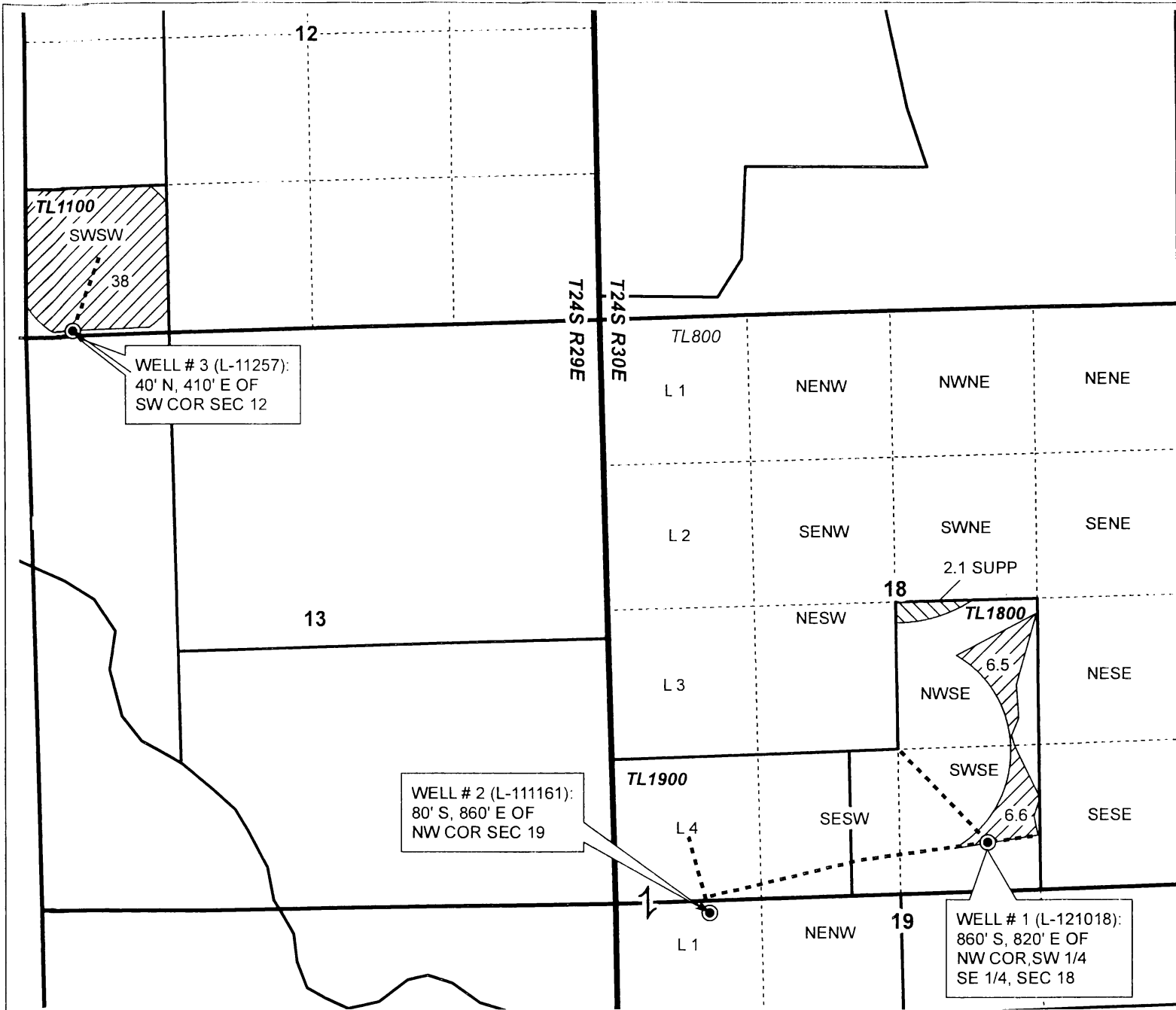

**CLAIM OF BENEFICIAL USE MAP**  
Patti Wilson / Shaun & Michelle Steinbeck

NOTE: THIS MAP IS NOT INTENDED TO  
PROVIDE LEGAL DIMENSIONS OR LOCATIONS  
OF PROPERTY OWNERSHIP LINES.

**WATER RIGHT SERVICES, LLC**

PO BOX 1830, BEND, OR 97709

CCB# 197121 [www.oregonwater.us](http://www.oregonwater.us)

**T24S R30E, WM,  
HARNEY COUNTY, OREGON**

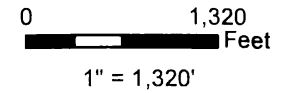

- Well & Meter
- Pipeline
- POU IR (3-31-1975)
- Township
- Section
- Quarter Quarter
- Taxlot

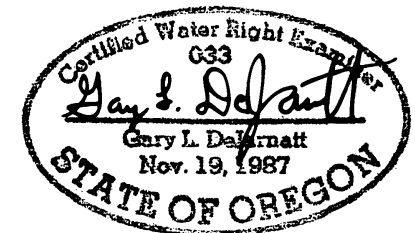

RENEWAL DATE 12/31/2019

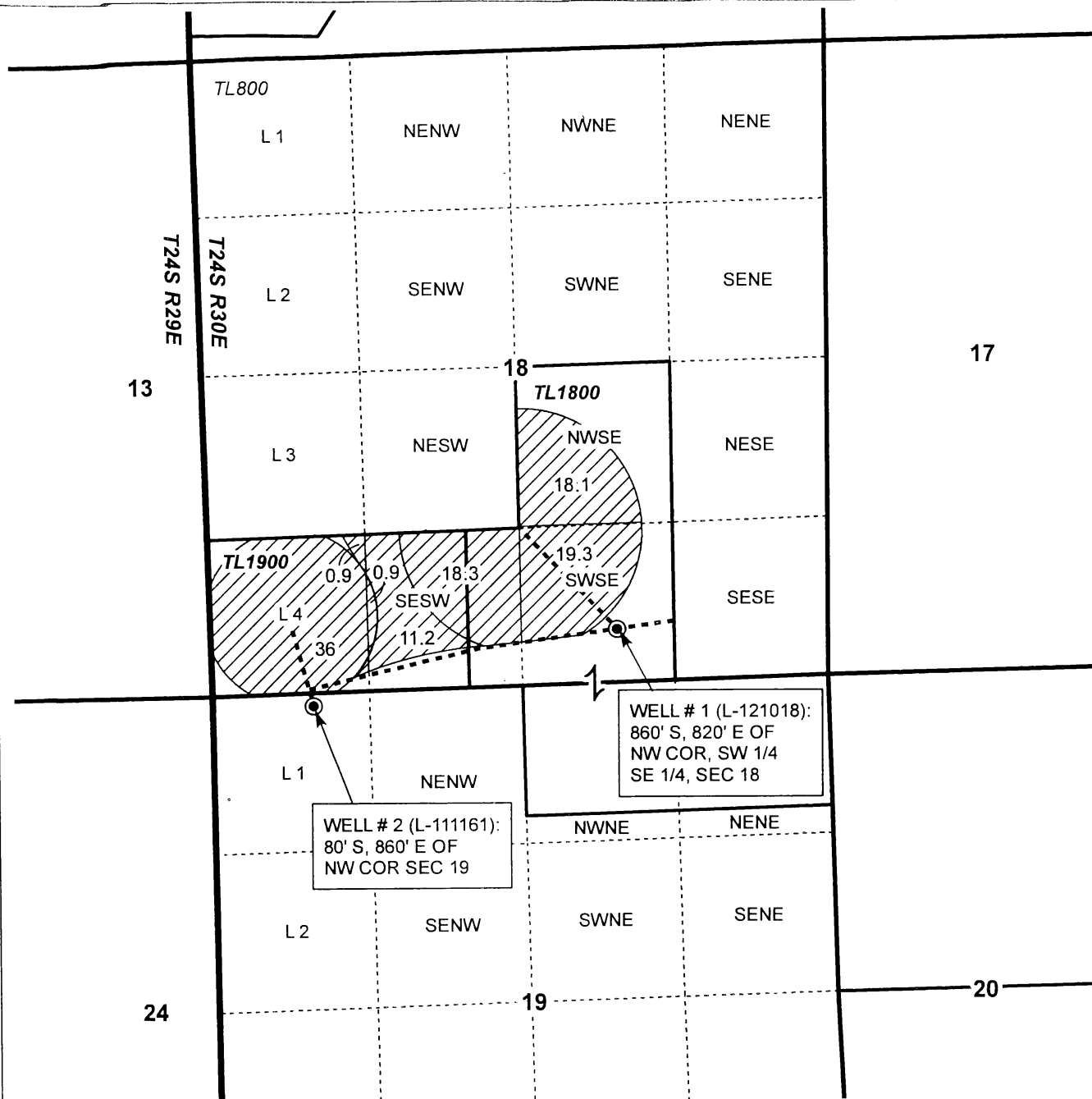

WELL # 1 (L-121018):  
860' S, 820' E OF  
NW COR, SW 1/4  
SE 1/4, SEC 18

WELL # 2 (L-111161):  
80' S, 860' E OF  
NW COR SEC 19

**CLAIM OF BENEFICIAL USE MAP**  
Patti Wilson / Shaun & Michelle Steinbeck

NOTE: THIS MAP IS NOT INTENDED TO  
PROVIDE LEGAL DIMENSIONS OR LOCATIONS  
OF PROPERTY OWNERSHIP LINES.

**WATER RIGHT SERVICES, LLC**  
PO BOX 1830, BEND, OR 97709  
CCB# 197121 [www.oregonwater.us](http://www.oregonwater.us)  
541-389-2837 [JOHNSHORT@USA.COM](mailto:JOHNSHORT@USA.COM)