

CLAIM OF BENEFICIAL USE MAP
FOR: MATTHEW BIRD
BY: NATHAN R. REED, P.E., CWRE
T26S, R3W, W.M. SECTION 9
APPLICATION NO. S-88032
PERMIT NO. S-54953
DATE SURVEYED: AUGUST 31, 2016

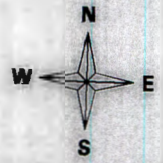

Scale: 1" = 400'

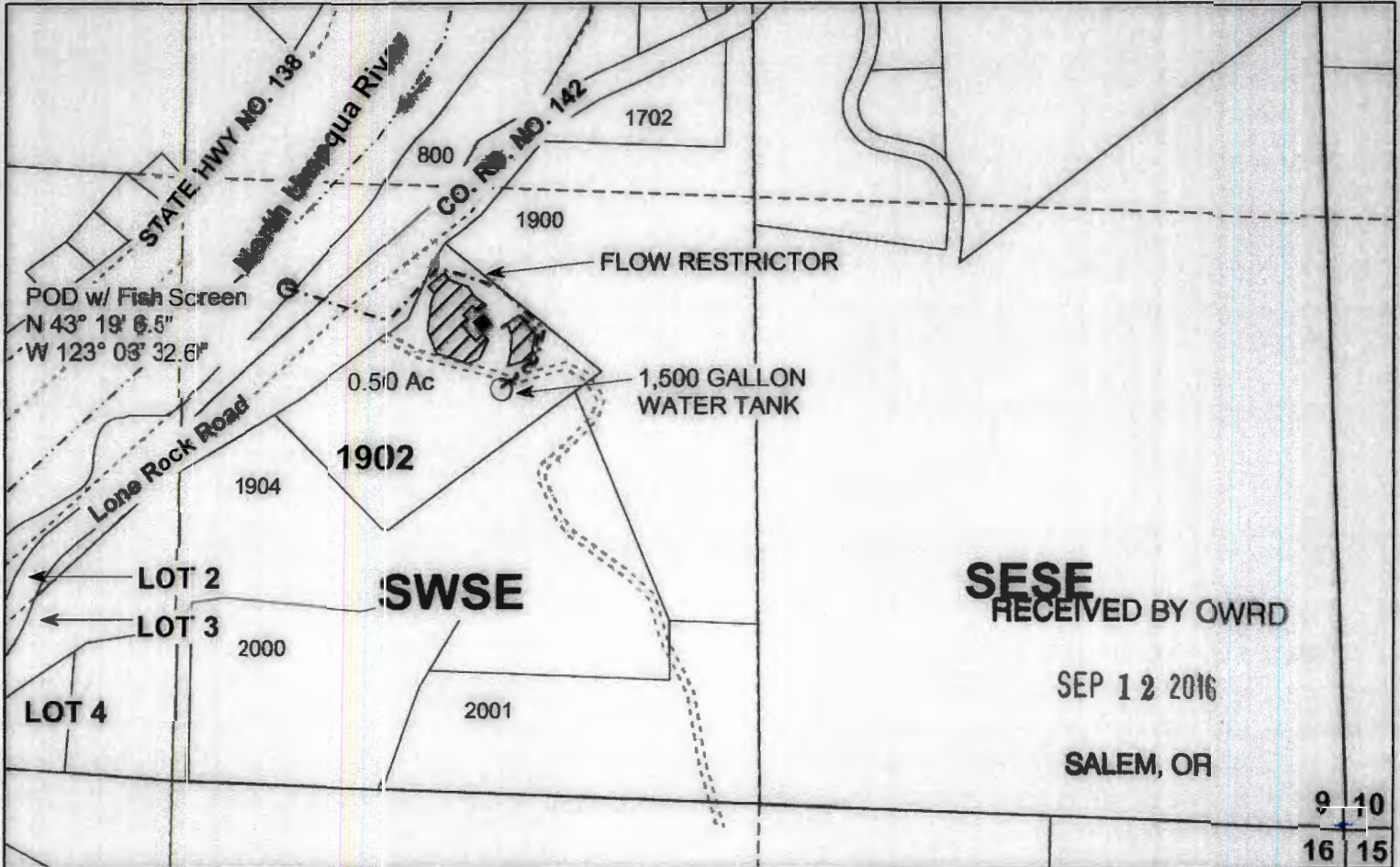

POD LOCATED 1100 FEET NORTH AND 2350 FEET WEST OF THE SE CORNER OF SECTION 9

Legend

-----	River		Irrigation		Section
→	Flow Arrow	Private Drive	----	Quarter
O	POD	■	Structures	-----	Sixteenth
O	Water Tank	-----	Gov Lot		Parcels
-----	Pipeline				

MAP PREPARED FOR:
 MATTHEW BIRD
 1291 LONE ROCK ROAD
 GLIDE, OR 97443

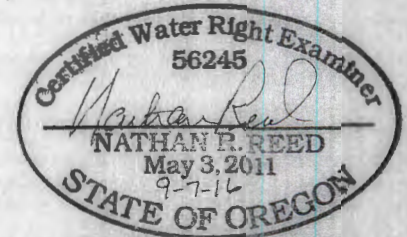

Expires Dec. 31, 2016

THE PURPOSE OF THIS MAP IS TO IDENTIFY THE LOCATION OF THE WATER RIGHT. IT IS NOT INTENDED TO PROVIDE INFORMATION RELATIVE TO THE LOCATION OF PROPERTY OWNERSHIP BOUNDARY LINES.

MAP PREPARED BY:
 NATHAN R. REED P.E., CWRE
 1113 SE CASS AV
 ROSEBURG, OR 97470