

T.8S. R.1E. Section 2 W.M.

Desantis Lane

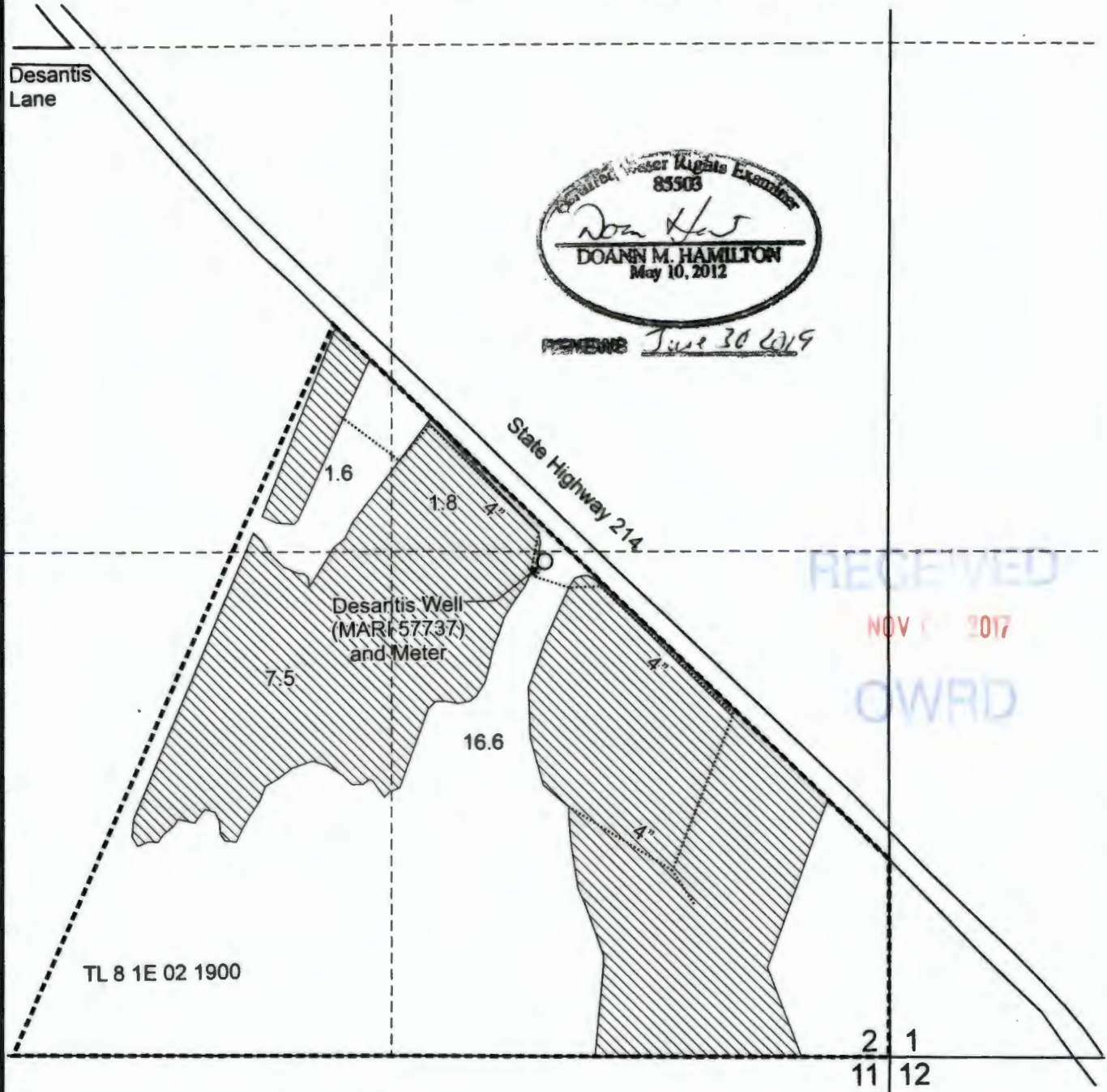

REVISED June 30 2019



RECEIVED
NOV 01 2017
CWRD

Well (MARI 57737) is located 1,280 feet north and 900 feet west from the SE corner, Section 2.

Area (27.5 Acres) covered for nursery use under Application G-16079, Permit G-15680.

Tax Lot Boundary Water system mainlines

Scale: 1" = 400'

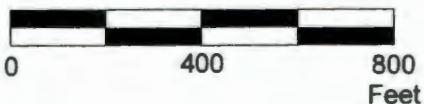

This map was prepared for the purpose of identifying the location of a water right only and is not intended to provide legal dimensions or location of property ownership lines.



Claim of Beneficial Use Map
Application G-16079, Permit G-15680

Jason Hupp
T.8S. R.1E. Section 2, W.M.

Pacific Hydro-Geology Inc.

10/2017