

CLAIM OF BENEFICIAL USE MAP

FOR: JAMES & KAREN MOON
 BY: NATHAN R. REED, P.E., CWRE
 T28S, R7W, W.M. SECTION 34 DLC 52
 APPLICATION NO. S-87859
 PERMIT NO. S-54873

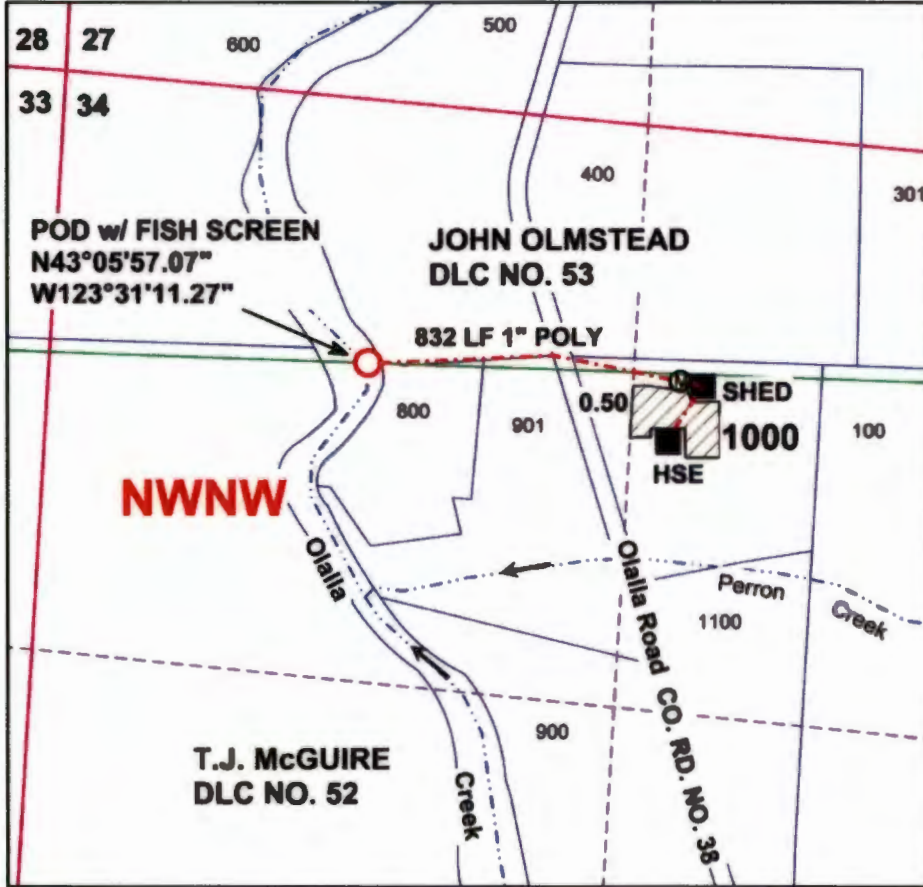

DATE SURVEYED: FEBRUARY 18, 2018



POD IS LOCATED 944 FEET NORTH AND 266 FEET WEST FROM THE C1/4 CORNER, SECTION 20.

RECEIVED
APR 09 2018
OWRD

SCALE: 1" = 400'

POD IS RE-DIVERTED ON OLALLA CREEK, 600 FEET SOUTH AND 700 FEET EAST FROM NW CORNER, SECTION 34.

Legend

	Stream		Pipeline		Section
	Flow arrow		Irrigation Area		Quarter
	POD		Structures		Sixteenth
	Meter		DLC		Parcels

MAP PREPARED FOR:
 JAMES & KAREN MOON
 1682 OLALLA ROAD
 WINSTON, OR 97496



THE PURPOSE OF THIS MAP IS TO IDENTIFY THE LOCATION OF THE WATER RIGHT. IT IS NOT INTENDED TO PROVIDE INFORMATION RELATIVE TO THE LOCATION OF PROPERTY OWNERSHIP BOUNDARY LINES.

MAP PREPARED BY:
 NATHAN R. REED, P.E., CWRE
 1113 SE CASS AV
 ROSEBURG, OR 97470