

T23S R26E, WM  
HARNEY COUNTY, OREGON

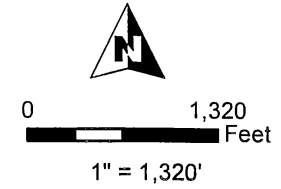

POA (HARN 50192) 50' S, 3070' W  
OF NE COR SEC 5

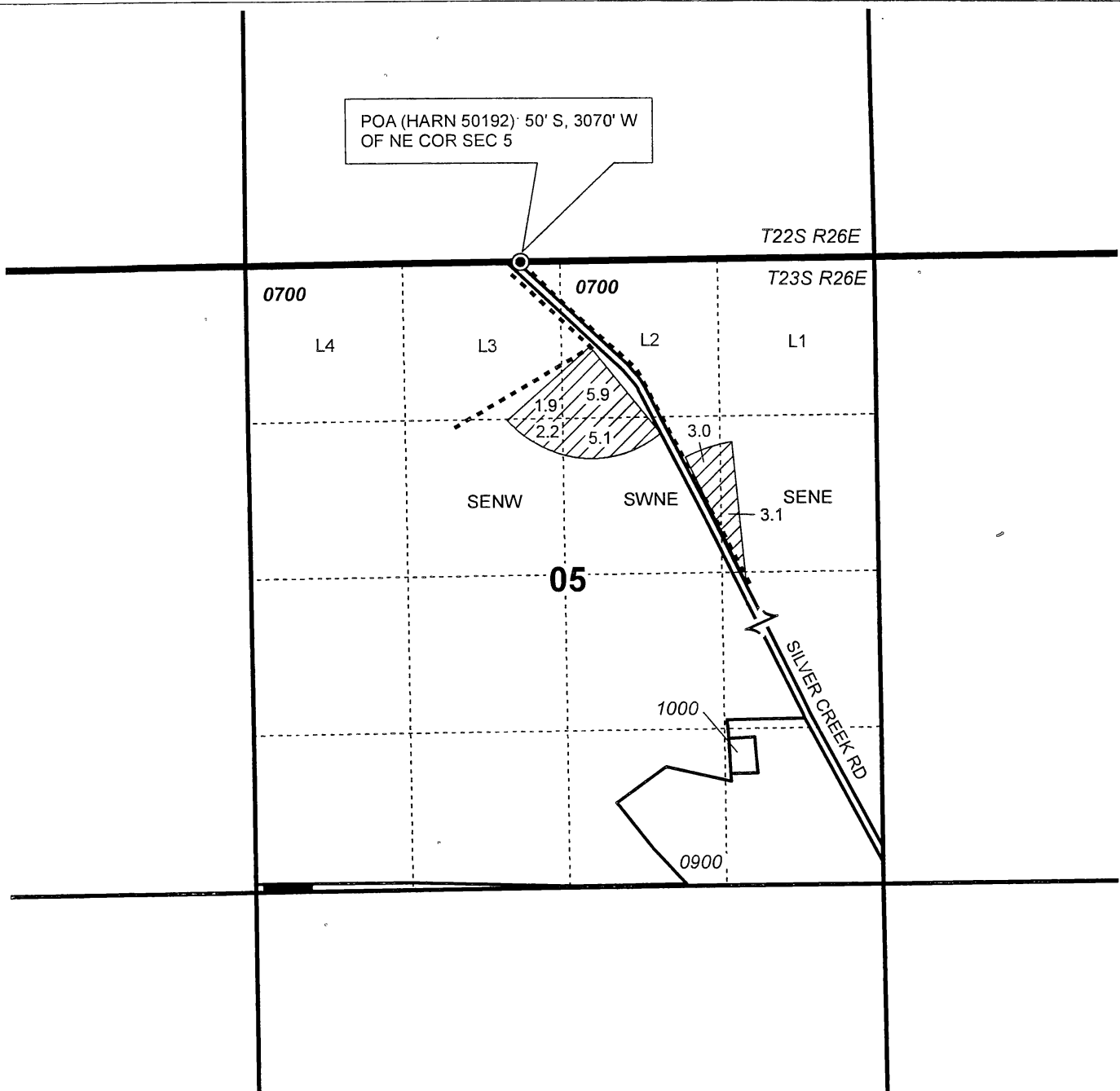

- POA & Meter
- Pipeline
- POU IS (1-8-1976) - from C-61068
- Township
- Section
- Quarter Quarter
- Tax Lot

**RECEIVED**  
**MAR 12 2020**  
**OWRD**

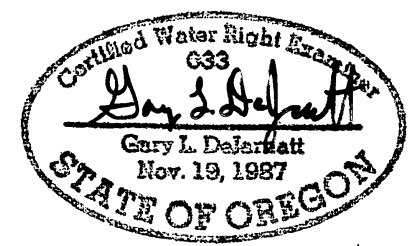

RENEWAL DATE 12/31/2021

**CLAIM OF BENEFICIAL USE MAP**  
**Dry Mountain Ranch, LLC**

NOTE: THIS MAP IS NOT INTENDED TO  
PROVIDE LEGAL DIMENSIONS OR LOCATIONS  
OF PROPERTY OWNERSHIP LINES.

**WATER RIGHT SERVICES, LLC**  
PO BOX 1830, BEND, OR 97709  
CCB# 197121 [www.oregonwater.us](http://www.oregonwater.us)  
541-389-2837 [JOHNSHORT@USA.COM](mailto:JOHNSHORT@USA.COM)