

T23S R27E, WM
HARNEY COUNTY, OREGON

T23S R26E
T23S R27E

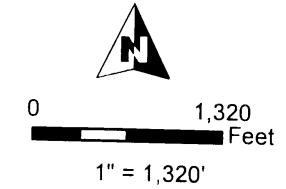

- Well & Meter #1
- ⊙ Pivot Meter #2
- Pipeline
- POU IS (2-14-1978) - from C-63570
- Township
- Section
- Quarter Quarter
- Tax Lot

RECEIVED
MAR 12 2020

OWRD

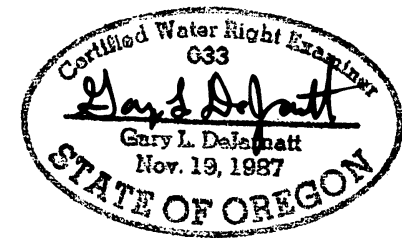

RENEWAL DATE 12/31/2021

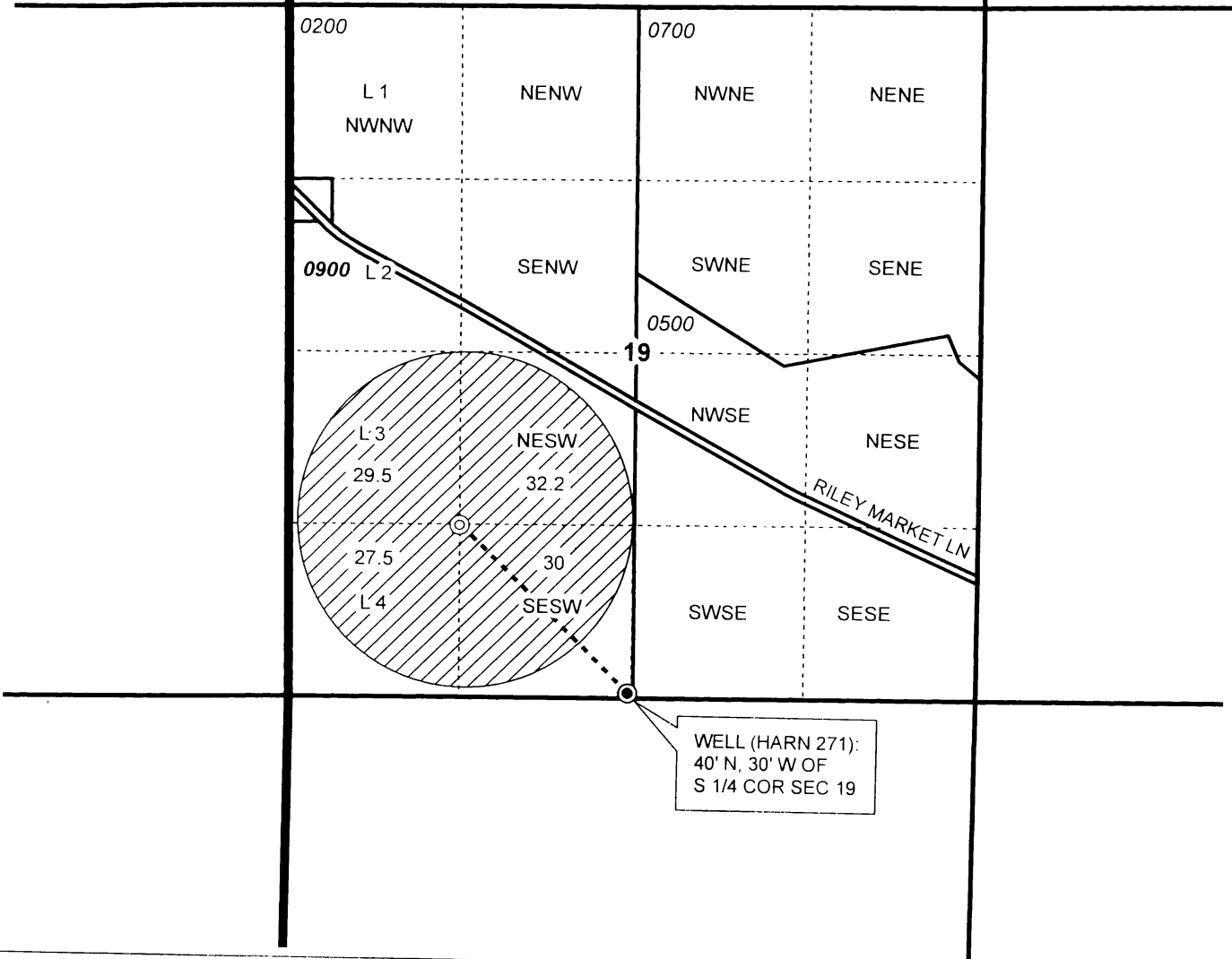

CLAIM OF BENEFICIAL USE MAP
Dry Mountain Ranch, LLC

NOTE: THIS MAP IS NOT INTENDED TO
PROVIDE LEGAL DIMENSIONS OR LOCATIONS
OF PROPERTY OWNERSHIP LINES.

WATER RIGHT SERVICES, LLC

T-12827 PG 4 (TFR OF CERTIFICATE 63570 IS)

Project #19048

Date: 1/28/2020

PO BOX 1830, BEND, OR 97709
CCB# 197121 www.oregonwater.us
541-389-2837 JOHNSHORT@USA.COM