

T.7S., R.3W., W.M

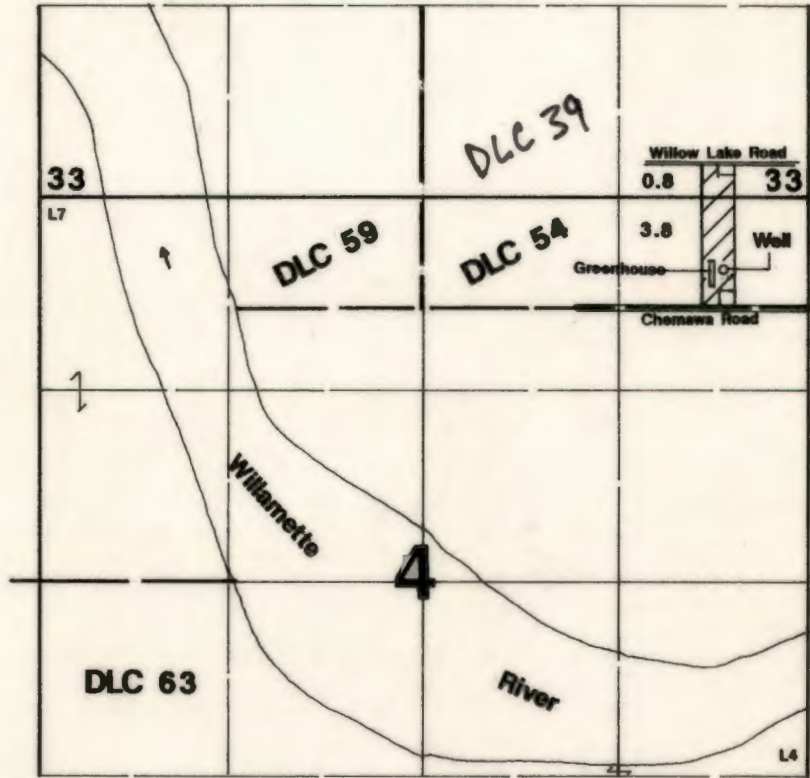

Well is located 505'S & 525'W from the NE corner of Section 4.

Final Proof Survey

Application: G-14764 Permit #: G-13612

In Name Of

Larry & Dawn Monagon

Surveyed on July 7, 2003 by JM Schuette

This Map Was Prepared For The Purpose Of Identifying The Location Of A Water Right Only And Is Not Intended To Provide Legal Dimensions Or Location Of Property Ownership Lines.

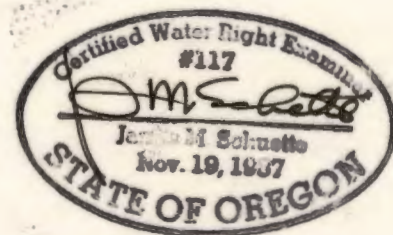

DLC 39 added to map AC/wrd 12/30/2019