

# Claim of Beneficial Use Map Permit G-10890 (Application G-11769)

Township 14 South, Range 5 West (W.M.)

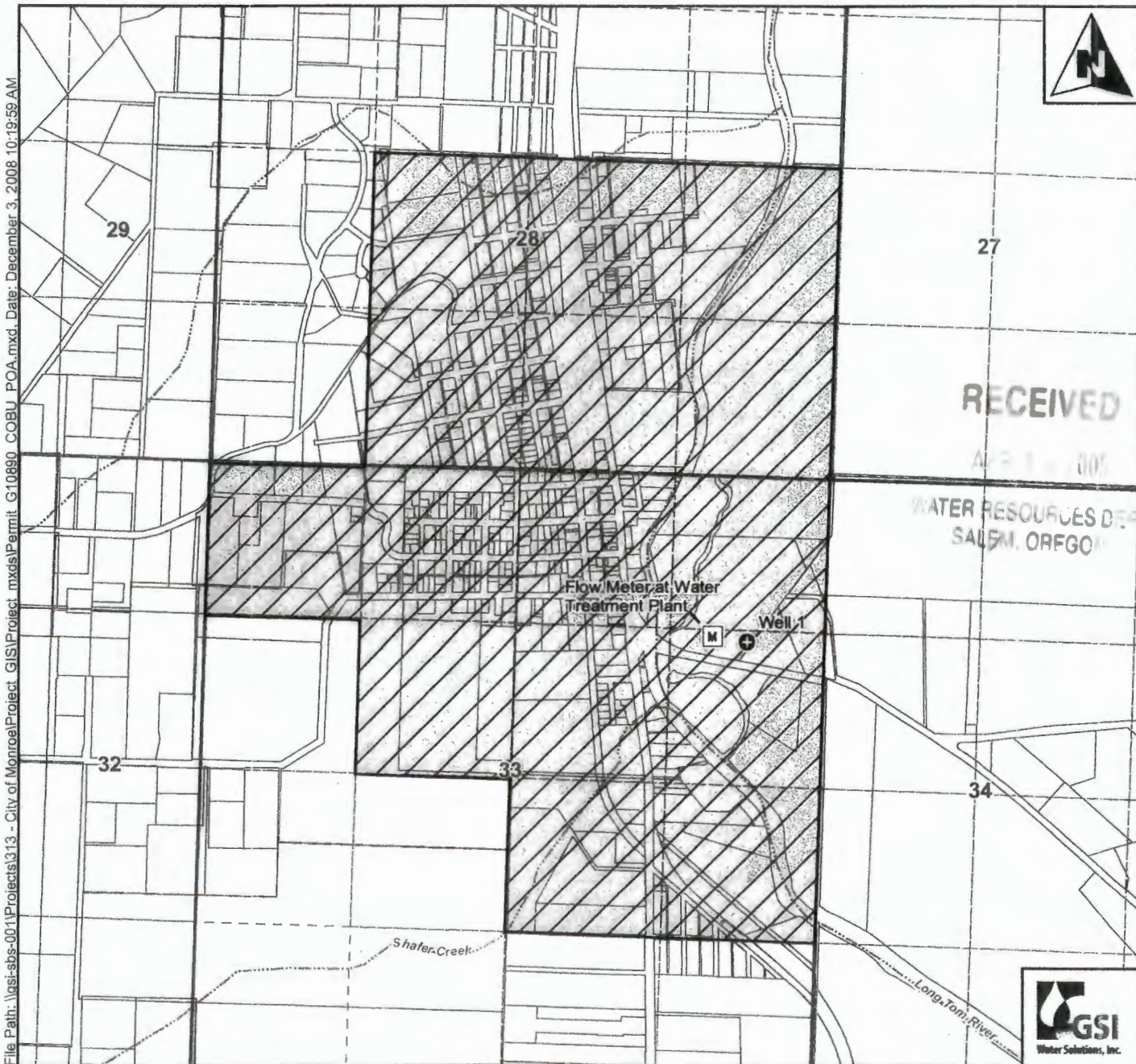

File Path: \\gsi-sbs-001\Projects\313 - City of Monroe\Protect\_GIS\Project\_mxd\Permit\_G10890\_COBU\_POA.mxd, Date: December 3, 2008 10:19:59 AM

### Legend

- ⊕ Point of Appropriation (POA)
- Place of Use (POU)  
(According to Permit G-10890)
- ⊕ Taxlots
- ~ Streets
- ~ Watercourses

### POA Legal Description

**Well 1**  
Located 1440 feet South and 710 feet West from the NE corner of Section 33, Township 14 South, Range 5 West (W.M.)

### Scale

1 inch equals 1,320 feet  
0 330 660 1,320  
Feet

### Note

This map was prepared for the purpose of identifying the location of a water right only and it is not intended to provide legal dimensions or location of property ownership lines.

### Map Information

Map Date: December 1, 2008  
Prepared By: GSI Water Solutions, Inc.

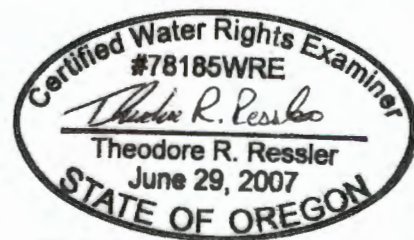

**EXPIRES: 12-31-2010**

*CWRE stamp and signature*