

T. 12 S., R. 44 E., W.M.

LEGEND

- ① Point of diversion in Burnt River is screened intake on 8 inch steel line 2265 feet South and 900 feet West of the corner common to Secs. 19, 20, 29 and 30, T. 12 S., R. 44 E., W.M.
- ② Concrete manhole access and pumping equipment.
- ③ 3 inch PVC pipe discharge line.
- ④ 14' x 26' water control building.

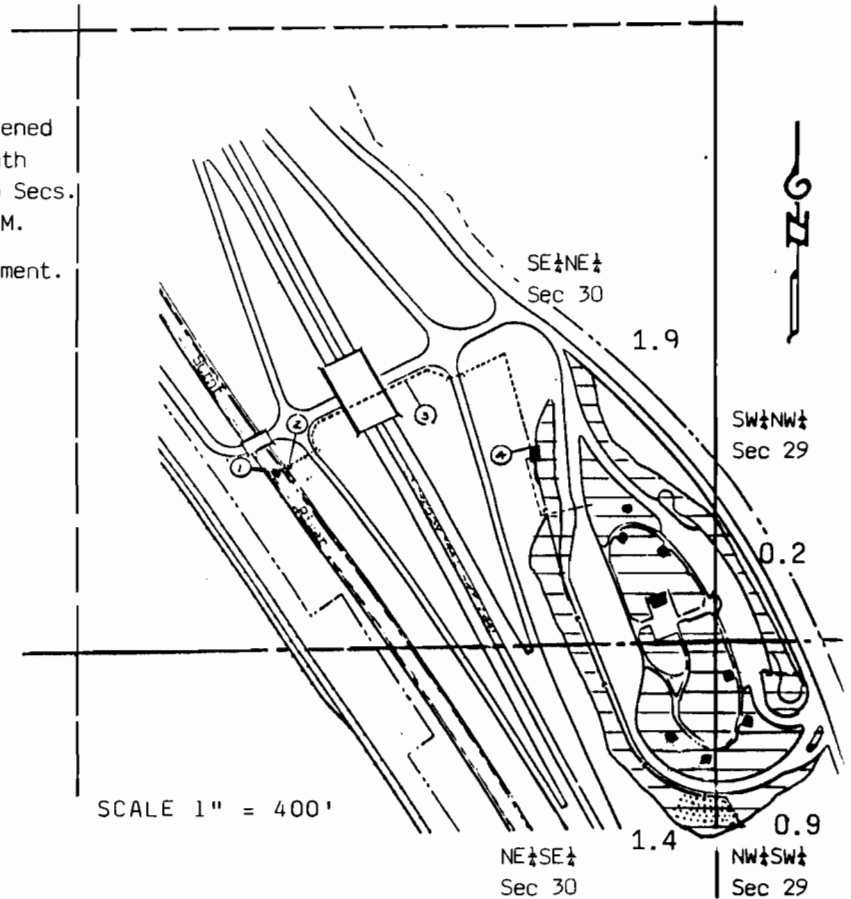

THE PURPOSE OF THIS MAP IS FOR IDENTIFYING THE LOCATION OF THE WATER RIGHT ONLY AND IS NOT INTENDED TO PROVIDE LEGAL DIMENSIONS OF PROPERTY OWNERSHIP LINES

FINAL PROOF SURVEY UNDER

Application No. 69675 Permit No. 50712

IN NAME OF
HIGHWAY DIVISION
OREGON DEPARTMENT OF TRANSPORTATION

Surveyed October 14, 1991

