

CLAIM OF BENEFICIAL USE

APPLICATION R-86565 PERMIT R-14332

APPLICATION S-86566 PERMIT S-54410

SECTION 13, TOWNSHIP 35S, RANGE 7W, W.M.

JOSEPHINE COUNTY OREGON

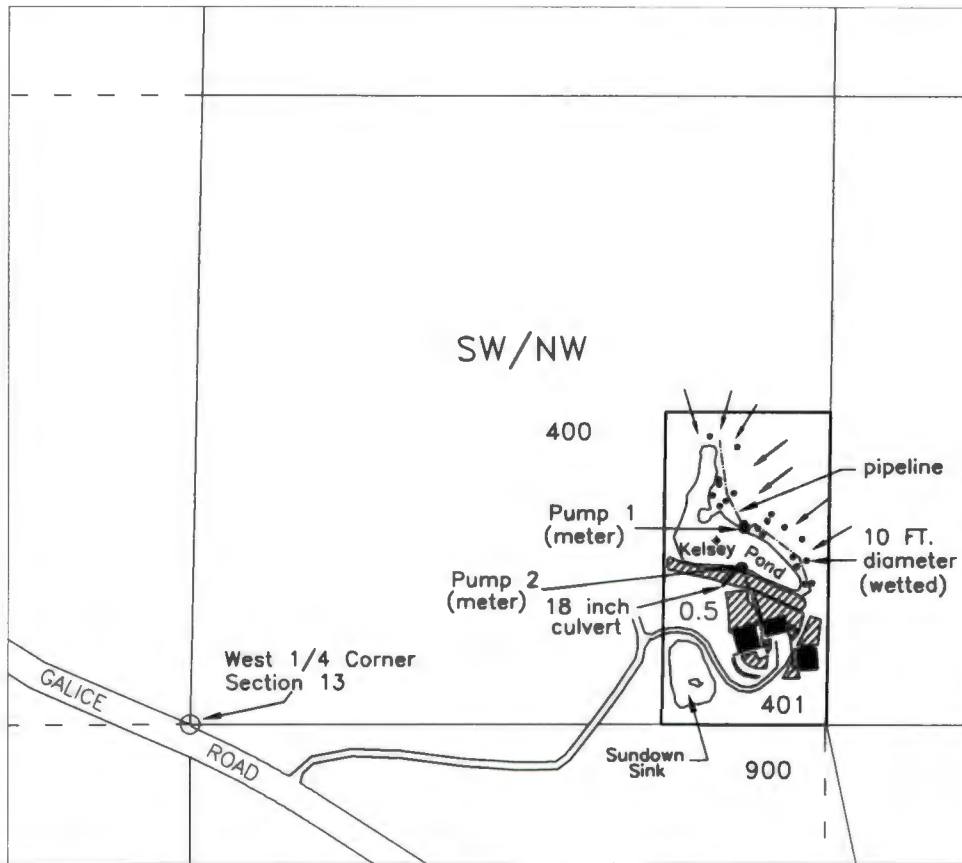



Kelsey Pond, Center -SW/NW Section 13 - 380 feet North & 1095 feet East

POD 1 -SW/NW Section 13, 330 feet North & 1145 feet East

POD 2 -SW/NW Section 13, 410 feet North & 1150 feet East

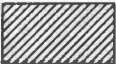
All from the WEST 1/4 Corner of Section 13

-  Irrigation of 0.5 Acres
Source: Kelsey Pond Reservoir 2 AF
-  Wetted area (approx. 10 ft. diameter)
-  Runoff



Scale

1" = 400'

Prepared For:

Harold Baima
P.O. Box 1198
Merlin, Oregon 97532

Base map Josephine County GIS tax lots over
2005 FSA aerial photo & Oregon Map Aerial Photo
downloaded 9/20/2016 and oriented to Partition
Plat 2003-47

This map is not intended to provide
legal dimensions or locations of
property ownership lines

JORDAN ENGINEERING
460 JORDAN LANE
ROSEBURG, OR 97471
(541) 673-1931