

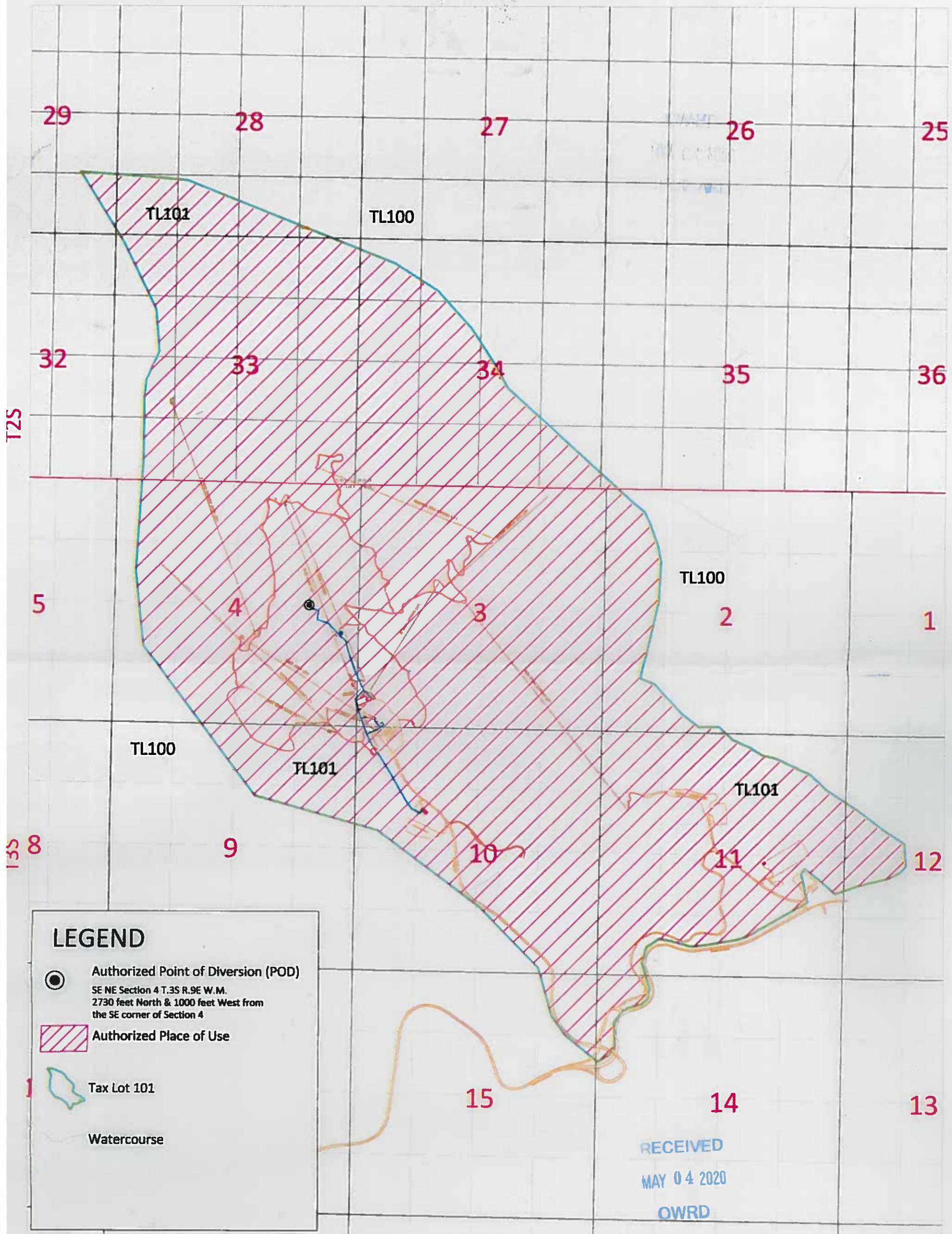



R9E



LEGEND

- 
Authorized Point of Diversion (POD)
 SE NE Section 4 T.3S R.9E W.M.
 2730 feet North & 1000 feet West from
 the SE corner of Section 4
- 
Authorized Place of Use
- 
Tax Lot 101
- 
Watercourse

RECEIVED
 MAY 04 2020
 OWRD

Final Proof Survey Map # 1 for Place of Use T-13228

MEADOWS UTILITIES, LLC
 T. 2 & 3 SOUTH R. 9 EAST W.M. HOOD RIVER COUNTY, OREGON

CERTIFIED WATER RIGHTS EXAMINER STAMP

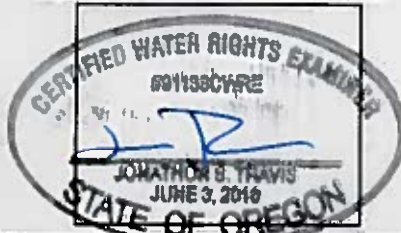

DISCLAIMER
 This map was prepared for the purpose of identifying the location of a water right only and it is not intended to provide legal dimensions or location of property ownership lines

MAP NOTES:
 Date March 30 2020
 Data Sources: USBLM, USFS, Hood River County

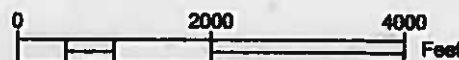



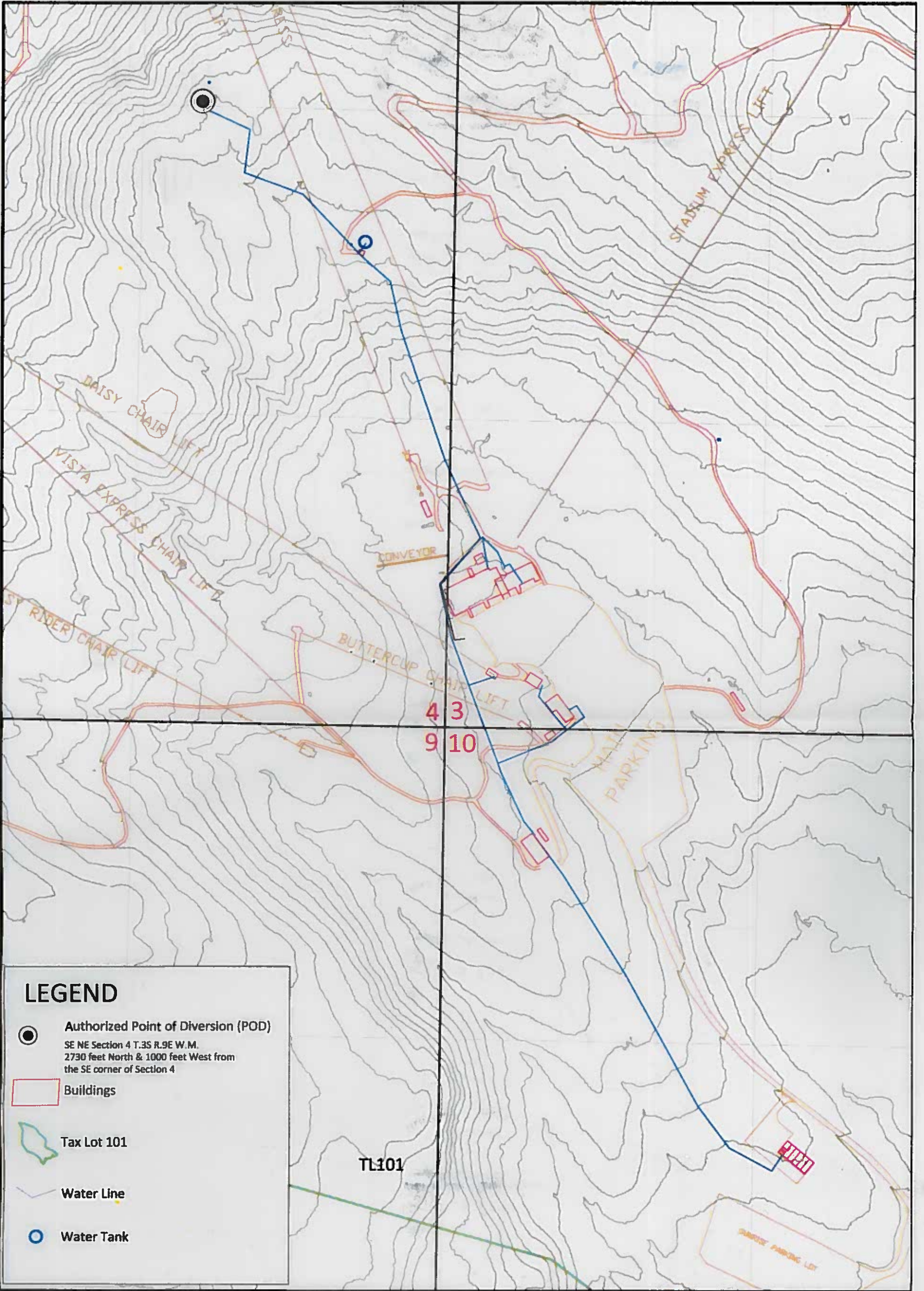

EXPIRES: 6/30/2020

R9E

T3S



LEGEND

-  Authorized Point of Diversion (POD)
SE NE Section 4 T.3S R.9E W.M.
2730 feet North & 1000 feet West from
the SE corner of Section 4
-  Buildings
-  Tax Lot 101
-  Water Line
-  Water Tank

Final Proof Survey Map # 2 for Place of Use T-13228

MEADOWS UTILITIES, LLC
T. 3 SOUTH R. 9 EAST W.M. HOOD RIVER COUNTY, OREGON

DISCLAIMER

This map was prepared for the purpose of identifying the location of a water right only and it is not intended to provide legal dimensions or location of property ownership lines

MAP NOTES:

Date April 13 2020
Data Sources: USBLM, USFS, Hood River County

CERTIFIED WATER RIGHTS EXAMINER STAMP



RECEIVED

MAY 04 2020

OWRD



EXPIRES: 6/30/2020