

982

CLAIM OF BENEFICIAL USE MAP

LOCATED IN SECTION 13 TAX LOTS 600 + 700, TOWNSHIP 3 NORTH, RANGE 2 WEST, W.M., COLUMBIA COUNTY, OREGON

COBSU MAP 982

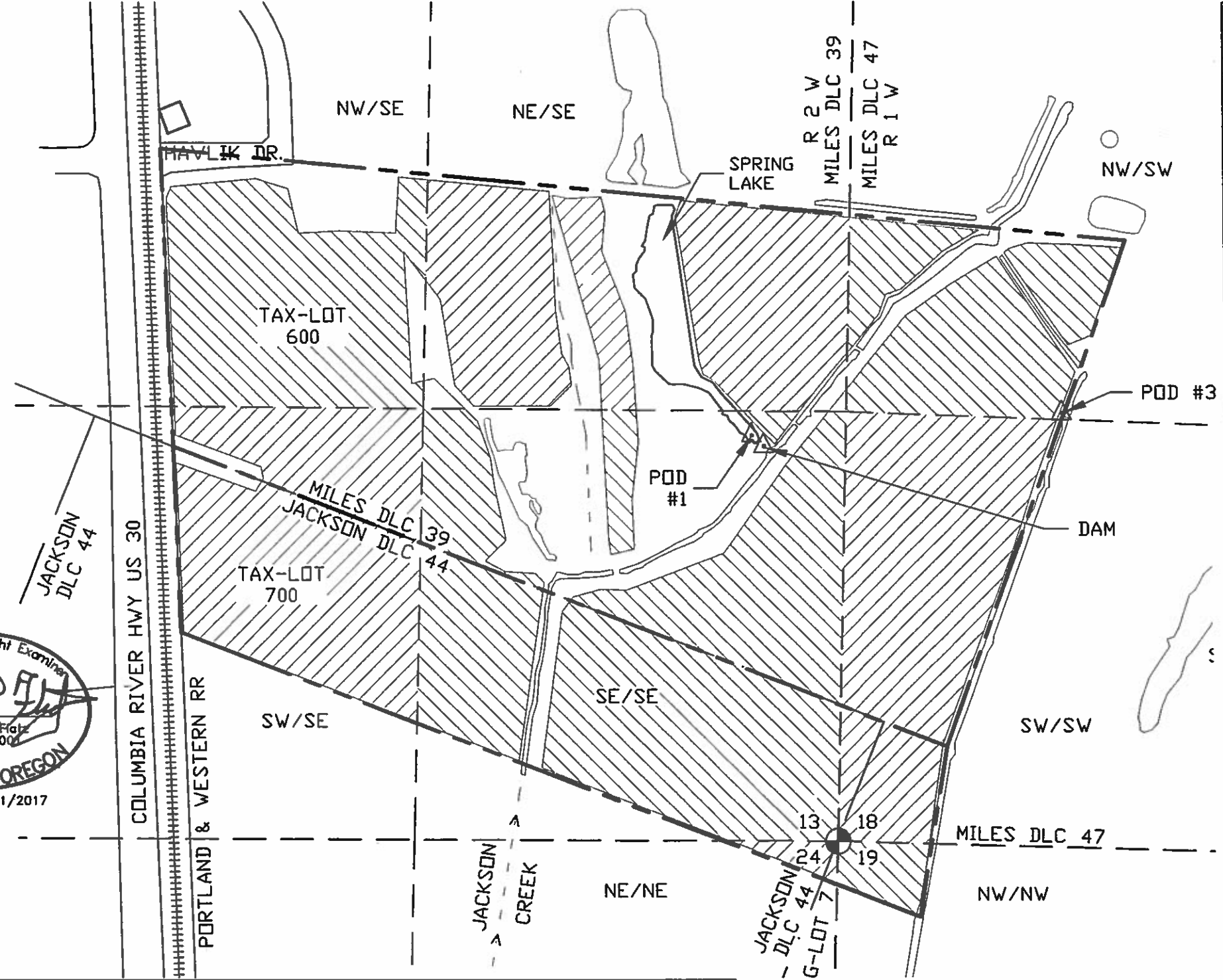

Range	Sec.	Q-Q	Taxlot	Glott	DLC	Acres P
1W	19	NW/NW	700			1.14
1W	18	SW/SW	600		47	11.30
1W	18	SW/SW	700		47	1.96
1W	18	SW/SW	700		44	0.66
1W	18	NW/SW	600		39	8.46
2W	13	SE/SE	700		44	15.58
2W	13	SE/SE	600		39	11.02
2W	13	NE/SE	500		39	14.27
2W	13	NW/SE	600		39	11.32
2W	13	SW/SE	600		39	4.62
2W	13	SW/SE	700		44	9.51
2W	24	NE/NE	700		44	0.43
2W	24	NE/NE	700	7		0.07
Total acres, Primary =						90.33



APPLICATION S-85441
PERMIT S-53955

POD #1, SPRING LAKE, 1270' N. AND 295' W.
FROM THE SE CORNER OF SECTION 13.

POD #3, DRAINAGE DITCH, 1360' N. AND 680' E.
FROM THE SW CORNER SECTION 18.

APPLICATION R-85549
PERMIT R-14010

POD DAM, SPRING LAKE, 1235' N. AND 255' W.
FROM THE SE CORNER OF SECTION 13.

LEGEND

----- PROPERTY LINES

▨ AREA OF PRIMARY IRRIGATION

Stuntzner
Engineering & Forestry, LLC
FOREST GROVE • COOS BAY • BROOKINGS

ENGINEERING * LAND SURVEYING
FORESTRY * PLANNING * WATER RIGHTS
JOB# 315-087
DRAWING : MEANS NURSERY BASE MAP.DWG
DATE: 2-18-16
2137 19TH AVENUE TEL: (503) 357-5717
FOREST GROVE, OR 97116 FAX: (503) 357-5698

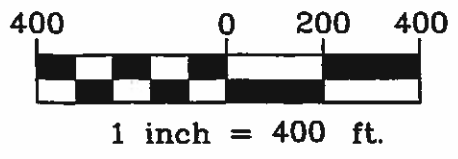

EXAMINERS DISCLAIMER STATEMENT
The preparation of this map was for the purpose of identifying the location of the Water Right only and has no intent to provide dimensions or location of property ownership lines.

IN THE NAME OF:
ETHEL HAVLIK TRUST
INSPECTED ON 1/15+20/16
by WILLIAM L. FLATZ, CWRE