

# Claim of Beneficial Use Place of Use and Point of Appropriation Map Application G-17029, Permit G-16904

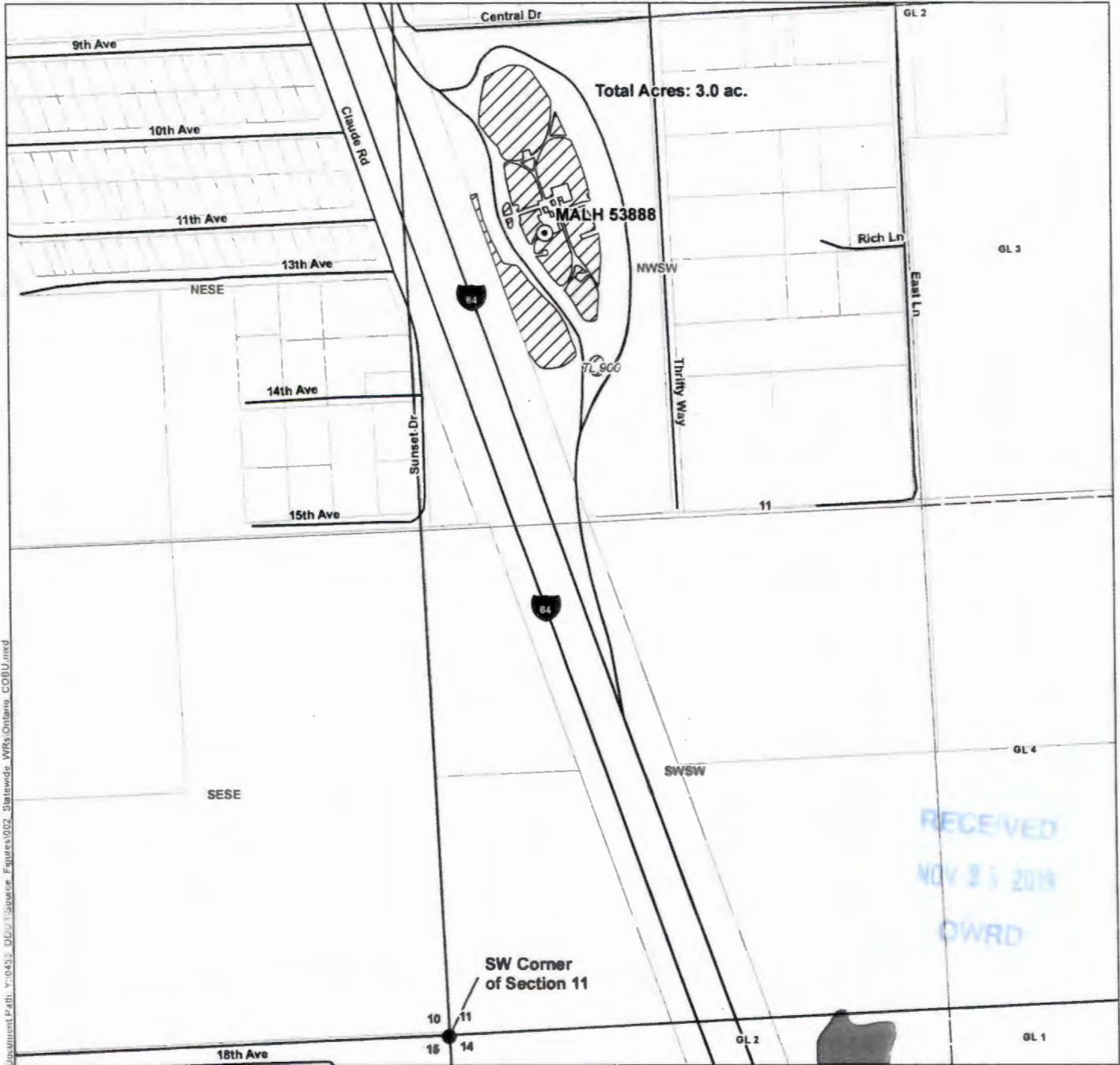





Malheur County, Oregon  
Township 18 South, Range 47 East (W.M.), Section 11



Document Path: Y:\045\000\1\Source\Figures\002\_Statewide\_WRS\Ontario\_COBU.mxd

RECEIVED  
NOV 25 2019  
OWRD

**LEGEND**

-  Point of Appropriation (POA)
-  Place of Use (POU), Irrigation, 3.0 ac.
-  Government Lot (GL)
-  Road
-  Tax Lot
-  Waterbody

**POA LOCATION DESCRIPTION**

**MALH 53888:** Located 2095 feet North and 370 feet East from the SW corner of Section 11, Township 18 South, Range 47 East (W.M.).  
**Meter Location:** 7' South and 10' East of the well.  
**System Piping:** See COBU Attachment 6.

**Certified Water Rights Examiner Stamp**



**DISCLAIMER**

This map was prepared for the purpose of identifying the location of a water right only and it is not intended to provide legal dimensions or location of property ownership lines.

**MAP NOTES**

Date: November 12, 2019  
 Data Sources: USGS, BLM, ESRI

