











Blue = Cont. 68265 (P=Primary S=Supp.)  
 Red = Cont. 68266 (P=Primary S=Supp.)

K

T. 8 S. R. 4 W. W. M.

CLAIM OF BENEFICIAL USE  
 UNDER  
 Applic. No. G-8709 Permit No. G-8684  
 Applic. No. 57240 Permit No. 44556  
 IN NAME OF  
 GREEN VILLA FARMS

Mitama Lk. D.P.#1 loc. 3110'E. & 1670'S.; Hayden Lk. D.P.#2 loc. 290'S. & 2520'N.;  
 Well 5 loc. 700' E & 200'S.; Well 3 loc. 2000'E. & 1310'N.;  
 Well 7 loc. 1485'E. & 1325'N.; all from SW Cor. Sec. 2  
 Humberg Lk. D.P.#1 loc. 2,800'W. & 850'S.; Willamette R. D.P.#2  
 loc. 1,850'S. & 40'W.; both from S.E. Cor. Hawkins DLC.86

- Permit No. G8684
  - Well No. 3 
  - Wells No. 5 & 7 
- Permit No. 44556
  - Humberg Lk. D.P.#1 } 
  - Willamette R. D.P.#2 } 
  - Mitama Lk. D.P.#8 } 
  - Hayden Lk. D.P.#9 } 
- Suppl. Acreage
  - GR-1460 
  - GR-1462 
  - GR-2937 
  - Permit 29117 

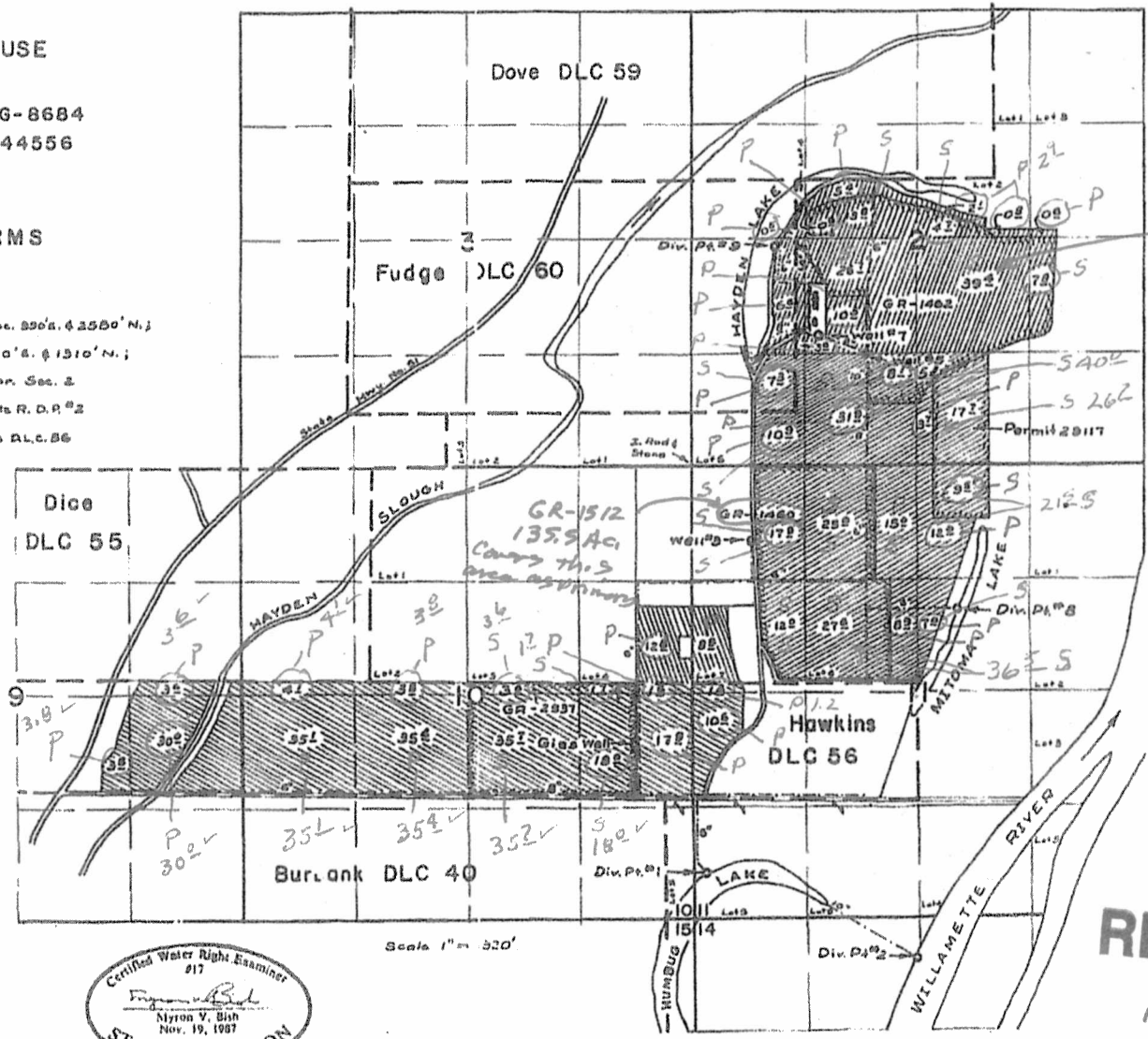

GR 1514  
 1359.9 Ac  
 Covers this  
 area as  
 Primary

THE PREPARATION OF THIS MAP IS FOR THE  
 PURPOSE OF IDENTIFYING THE LOCATION  
 OF THE WATER RIGHT ONLY AND HAS NO  
 INTENT TO PROVIDE DIMENSIONS OR LOCATION  
 OF PROPERTY OWNERSHIP LINES.

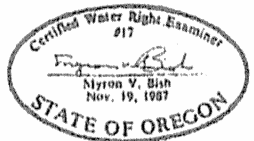

Scale 1" = 320'

RECEIVED

APR 16 2015

WATER RESOURCES DEPT  
 SALEM, OREGON

T 12035

# Halls Ferry Farms Cert 68265 New POA

New Well 5  
Lat 44.901671  
Long 123.145761

Old Well 5  
Lat 44.901528  
Long 123.145784

## Legend

GV Rights

POD\_text

 Cert 68265

 GR 1514

**RECEIVED**

APR 16 2015

WATER RESOURCES DEPT  
SALEM, OREGON

CERTIFIED WATER RIGHT EXAMINER  
30680  
*William E. McGill*  
WILLIAM E. MCGILL  
MAY 3, 2011  
STATE OF OREGON  
EXPIRES: 12-31-16

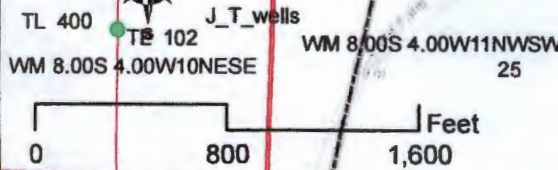

Map prepared by Brent Stevenson

Sources: Esri, DeLorme, NAVTEQ, TomTom, Intermap, increment P Corp., GEBCO, USGS, FAO, NPS, NRCAN, GeoBase, IGN, Kadaster  
Netherlands, Esri Japan, METI, Esri China (Hong Kong), swisstopo, and the GIS User Community

T 12035