

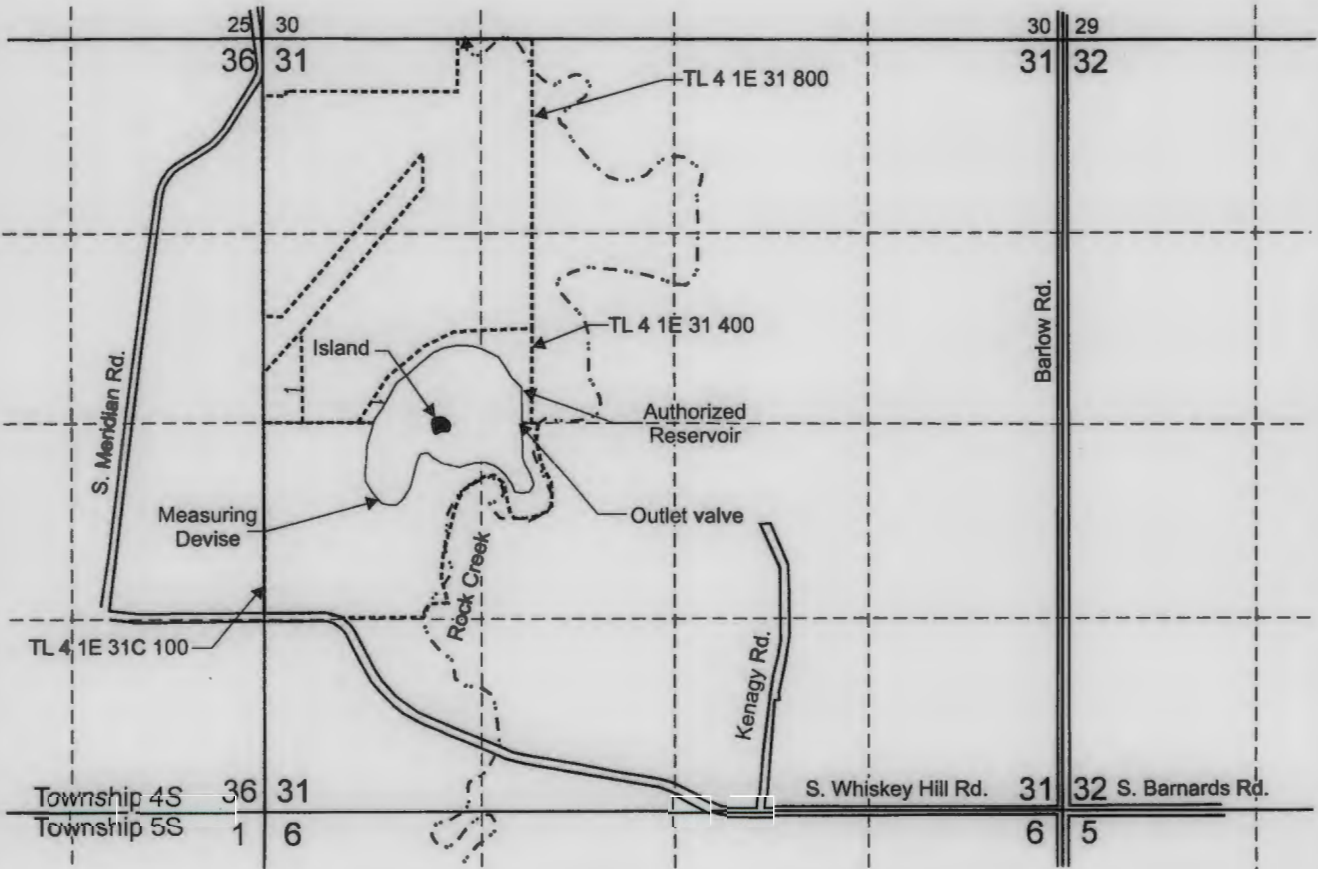

T.4S. R.1E. Section 31, W.M.



Authorized Reservoir is located in the SWNW, SENW, NESW, NWSW, Section 31, T.4S., R.1E. W.M.

Dam is located NESW, Section 31, T.4S., R.1E. W.M.

 Area (18.9 Acres) submerged at full stage by reservoir authorized under Application R-80804, Permit R-11955.

 Tax lot boundary

RECEIVED
 SEP 10 2019
OWRD

RECEIVED
 SEP 26 2019
OWRD

Don Hamilton
DOANN M. HAMILTON
 May 10, 2012

RECEIVED 6/30/2021



Scale: 1" = 1,320'



This map was prepared for the purpose of identifying the location of a water right only and is not intended to provide legal dimensions or location of property ownership lines.

Claim of Beneficial Use Map
 Application R-80804, Permit R-11955

Raymon Neuschwander
 T.4S. R.1E. Section 31, W.M.

Pacific Hydro-Geology Inc.

06/2019

NeuschwanderCOBUMMap.cdr