

**Claim of Beneficial Use Map
Place of Use
T-12083
Morrow County, Oregon
Township 4 & 5 North,
Range 25 & 26 East (W.M.)**

- LEGEND**
- Point of Appropriation (POA)
 - ▭ Port Service Area Boundary (POU)
 - Pipeline
 - ⊠ Government Lot (GL)
 - ⊕ Tax Lot
 - Major Road
 - ~ Watercourse
 - Waterbody

**RECEIVED
AUG 10 2020**

OWRD
 Certified Water Rights Examiner
 #78208WRE
Bruce Brody Heine
 Bruce Brody-Heine
 June 29, 2007
 STATE OF OREGON

EXPIRES: 12-31-21

DISCLAIMER
 This map was prepared for the purpose of identifying the location of a water right only and it is not intended to provide legal dimensions or location of property ownership lines.

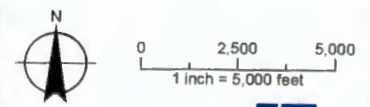

Date: July 10, 2020
 Data Sources: USGS, BLM, ESRI, Morrow Co.

Docuement Path: Y:\0281_Portal\Morrow_Source_Figures\015_WR_Support\POU_T12083.mxd skammion

Claim of Beneficial Use Map Points of Appropriation T-12083 Morrow County, Oregon Township 4 North, Range 25 East (W.M.)

RECEIVED
OCT 13 2020
OWRD

POA LOCATION DESCRIPTION
EB Well #1 (MORR 51515) Located 1377 feet South and 3659 feet West from the NE Corner of Section 2, Township 4 North, Range 25 East (W.M.)
Meter Located 40.8' South and 14.5' West of EB Well #1.
EB Well #2 (MORR 51427) Located 1448 feet South and 3724 feet West from the NE Corner of Section 2, Township 4 North, Range 25 East (W.M.)
Meter Located 4.0' South and 8.5' East of EB Well #2.
EB Well #3 (MORR 51545) Located 1590 feet South and 3845 feet West from the NE Corner of Section 2, Township 4 North, Range 25 East (W.M.)
Meter Located 8.5' South and 9.3' East of EB Well #3.
Sump Well 1: Located 1213 feet North and 427 feet West from the E 1/4 Corner of Section 10, Township 4 North, Range 25 East (W.M.)
Meter Located 258' North and 2,267' West of Sump Well 1.

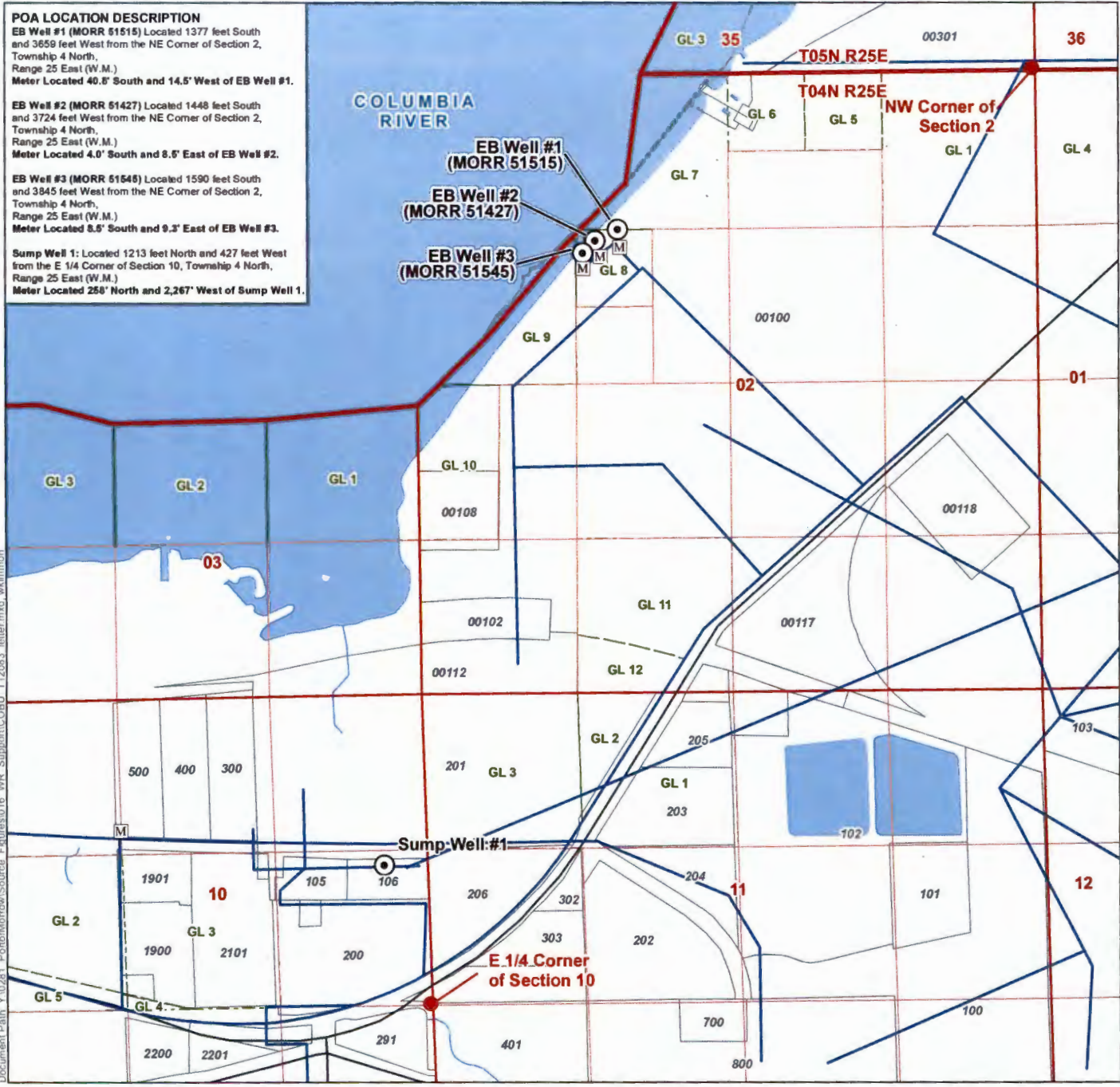

- LEGEND**
- ⊙ Point of Appropriation (POA)
 - M Totalizing Flowmeter
 - Pipelines
 - Government Lot (GL)
 - ⊕ Tax Lot
 - Major Road
 - ~ Watercourse
 - Waterbody

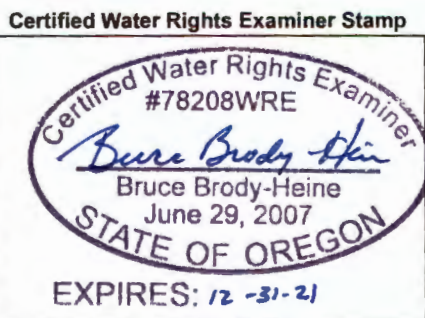

DISCLAIMER
 This map was prepared for the purpose of identifying the location of a water right only and it is not intended to provide legal dimensions or location of property ownership lines.

MAP NOTES
 Date: October 7, 2020
 Data Sources: USGS, BLM, ESRI, Morrow Co.

DISCLAIMER
 This map was prepared for the purpose of identifying the location of a water right only and it is not intended to provide legal dimensions or location of property ownership lines.

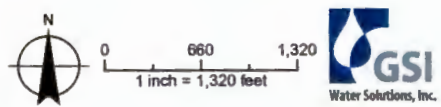

Document Path: Y:\0281_PortofMorrow\Source Figures\016_WR_Support\COBU_T12083_letter.mxd, wklimmon