

**Claim of Beneficial Use Map**  
**Place of Use**  
**T-12081**  
 Morrow County, Oregon  
 Township 4 & 5 North,  
 Range 25 & 26 East (W.M.)

- LEGEND**
- Point of Appropriation (POA)
  - ▭ Port Service Area Boundary (POU)
  - Pipeline
  - ⊠ Government Lot (GL)
  - ⊕ Tax Lot
  - Major Road
  - ~ Watercourse
  - Waterbody

Certified Water Rights Examiner  
 #78208WRE  
*Bruce Brody-Heine*  
 Bruce Brody-Heine  
 June 29, 2007  
 STATE OF OREGON

EXPIRES: 12-31-21  
**RECEIVED**  
 AUG 17 2020

**DISCLAIMER**  
 This map was prepared for the purpose of determining the location of a water right only and it is not intended to provide legal dimensions or location of property ownership lines.



Date: July 10, 2020  
 Data Sources: USGS, BLM, ESRI, Morrow Co.



**POA LOCATION DESCRIPTION**

**EB Well #1 (MORR 51515)** Located 1377 feet South and 3659 feet West from the NE Corner of Section 2, Township 4 North, Range 25 East (W.M.)  
 Meter Located 40.8' South and 14.8' West of EB Well #1.

**EB Well #2 (MORR 51427)** Located 1448 feet South and 3724 feet West from the NE Corner of Section 2, Township 4 North, Range 25 East (W.M.)  
 Meter Located 4.0' South and 8.6' East of EB Well #2.

**EB Well #3 (MORR 51545)** Located 1590 feet South and 3845 feet West from the NE Corner of Section 2, Township 4 North, Range 25 East (W.M.)  
 Meter Located 6.6' South and 9.3' East of EB Well #3.

**Port Well #3 (MORR 757)** Located 1073 feet South and 1348 feet East from the NW Corner of Section 10, Township 4 North, Range 25 East (W.M.)  
 Meter Located 20' South and 1,264' East of Port Well #3

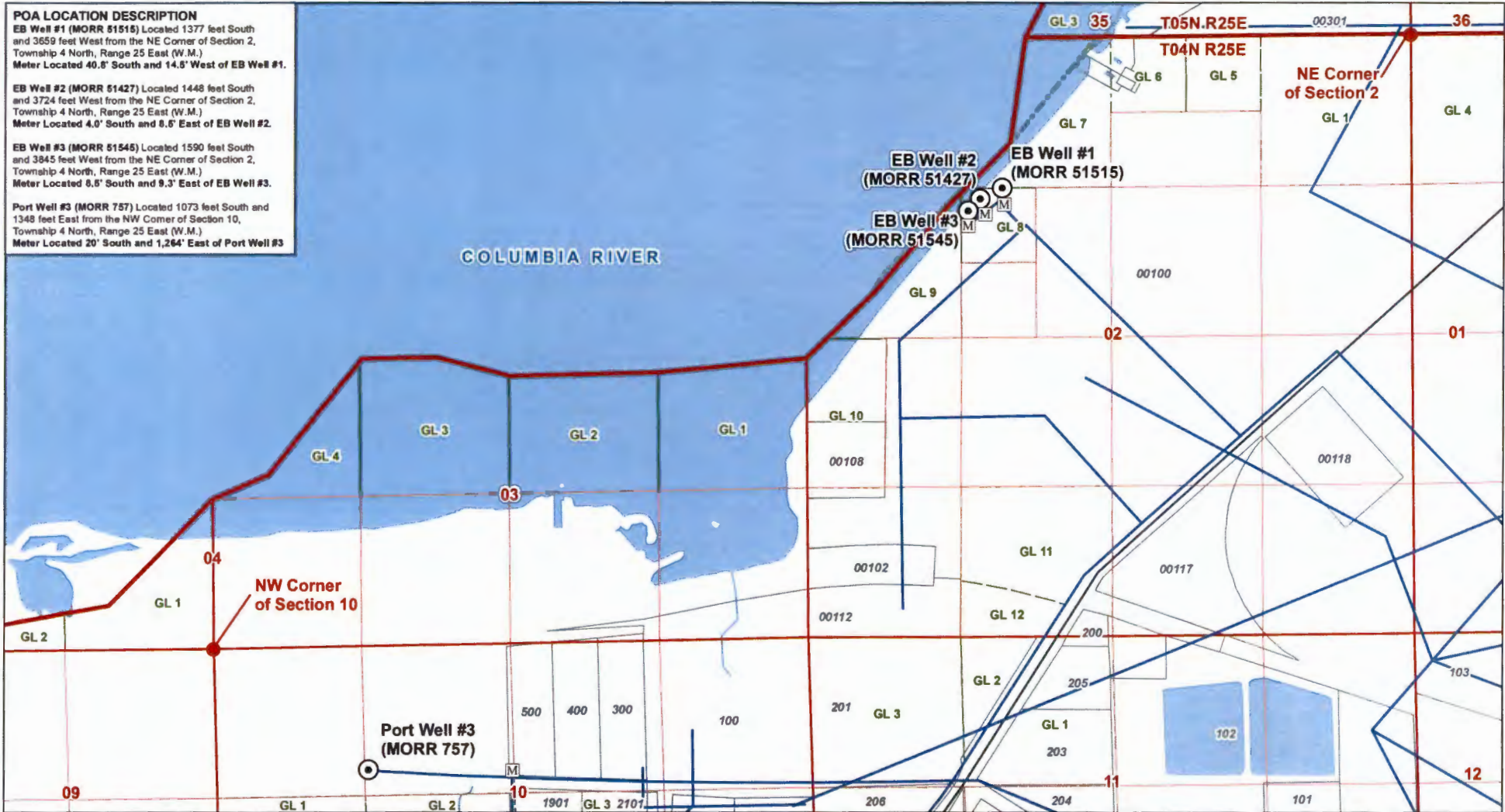

**LEGEND**

- Point of Appropriation (POA)
- Tax Lot
- Totalizing Flowmeter
- Major Road
- Pipeline
- Watercourse
- Government Lot (GL)
- Waterbody

**DISCLAIMER**

This map was prepared for the purpose of identifying the location of a water right only and it is not intended to provide legal dimensions or location of property ownership lines.

Date: October 7, 2020  
 Data Sources: USGS, BLM, ESR1, Morrow Co.

**Certified Water Rights Examiner Stamp**

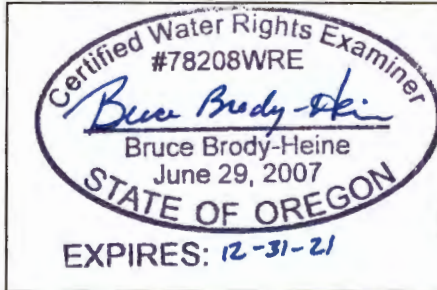

**Claim of Beneficial Use Map  
 Points of Appropriation**

**T-12081**  
 Morrow County, Oregon  
 Township 4 North, Range 25 East (W.M.)

RECEIVED

OCT 13 2020

OWRD



0 660 1,320  
 1 inch = 1,320 feet

