

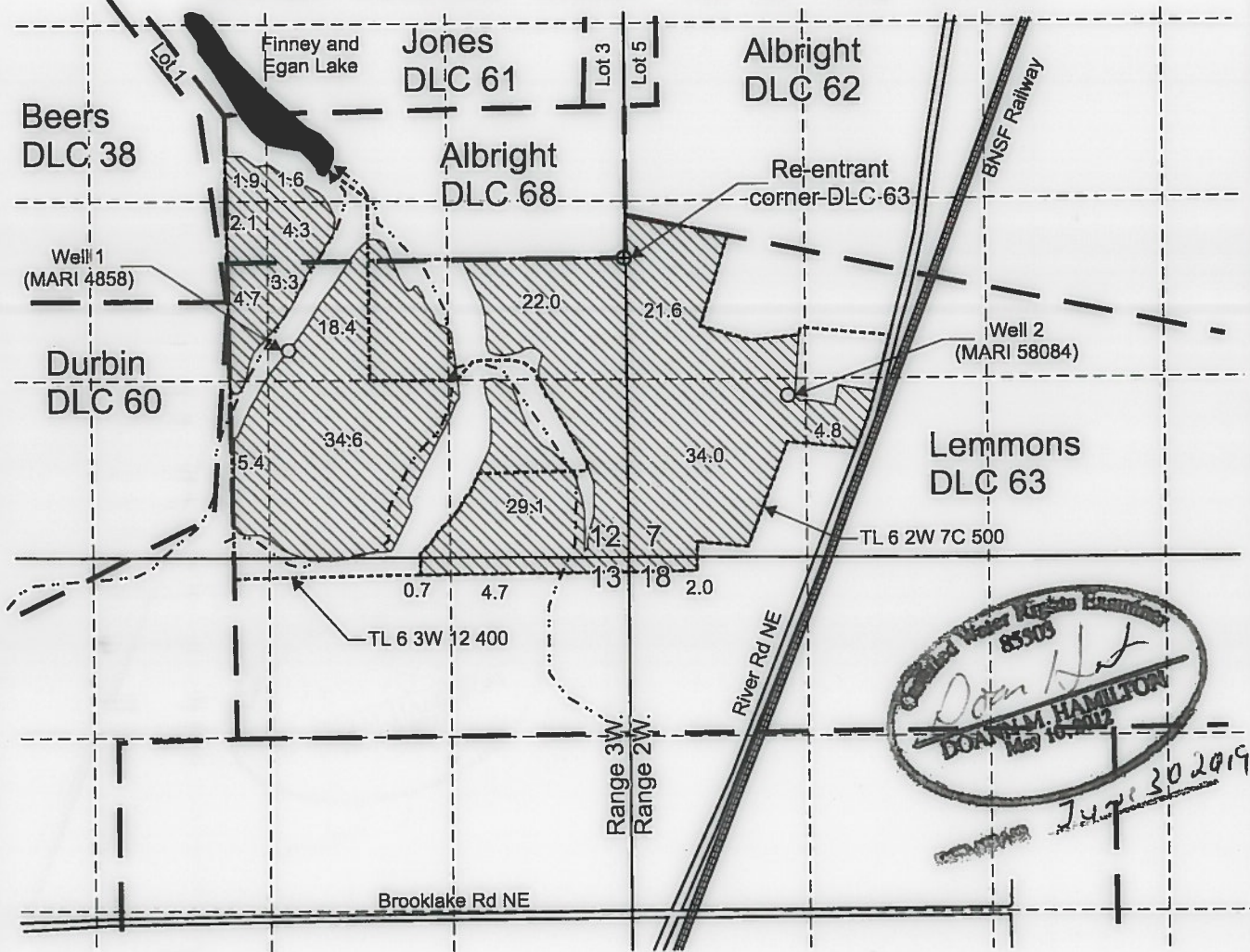

T.6S. R.2W. Sec. 7 & 18 T.6S. R.3W. Sec. 12 & 13, W.M.



Well 1 (MARI 4858) is located 700 feet south and 2,470 feet west from the S re-entrant corner, DLC 68.

Well 2 (MARI 58084) is located 1,025 feet south and 1,205 feet east from the S re-entrant corner, DLC 68.

 Area (195.2 Acres) irrigated under T-9240, priority date: December 13, 1965.

 Tax lot boundary

 Donation Land Claim boundary

RECEIVED

JUN 29 2018

OWRD

This map was prepared for the purpose of identifying the location of a water right only and is not intended to provide legal dimensions or location of property ownership lines.

Scale: 1" = 1,320'



Claim of Beneficial Use Map
T-9240

Chapin Investments, LLC, Brent and Vanessa LaFollette
T.6S. R.2W. Sec. 7 & 18,
T.6S. R.3W. Sec. 12 & 13, W.M.

Pacific Hydro-Geology Inc.

06/2018