

WHOAHINK LAKE

WHOAHINK LAKE

22 23
27 26

RECEIVED

OCT 07 2019

OWRD

NW 1/4 NE 1/4

NE 1/4 NE 1/4

(SE 1/4 NE 1/4)
GOV'T LOT 4

SW 1/4 NE 1/4

THIS MAP IS FOR THE PURPOSE
OF IDENTIFYING THE LOCATION
OF THE WATER RIGHT ONLY.
THERE IS NO INTENT TO PROVIDE
DIMENSIONS OR LOCATION OF
PROPERTY OWNERSHIP LINES.

METER FOR POD 1
IS NORTH 77 FEET AND
WEST 643 FEET FROM
THE WCMC TO SECTION 27
AND SECTION 26.

METER FOR POD 2
IS NORTH 58 FEET AND
WEST 496 FEET FROM
THE WCMC TO SECTION 27
AND SECTION 26.

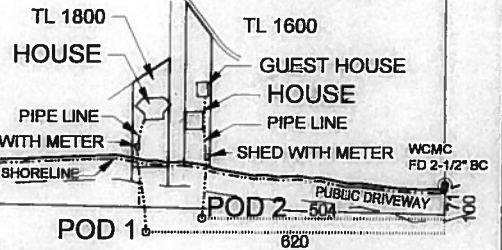

POINT OF DIVERSION POD 1
AND FISH SCREEN
IS SOUTH 71 FEET AND
WEST 620 FEET FROM
THE WCMC TO SECTION 27
AND SECTION 26.

POINT OF DIVERSION POD 2
AND FISH SCREEN
IS SOUTH 100 FEET AND
WEST 504 FEET FROM
THE WCMC TO SECTION 27
AND SECTION 26.

COBU MAP # 201 A-7 TSILTCOOS LAKE (NE 1/4 SE 1/4)

**FINAL PROOF SURVEY
CLAIM OF BENEFICIAL USE
WATER RIGHTS MAP
MID COAST BASIN**

UNDER PERMIT S-55092
APPLICATION S-88267

19-12-27-1-4, TL 1600 & 1800
SE 1/4 NE 1/4, SEC. 27, T19S, R12W, W.M.
NE 1/4 SE 1/4, SEC. 27, T19S, R12W, W.M.
LANE COUNTY, OREGON

FOR: GEORGE R. & HEATHER. S. NELSON
P. O. BOX 175
WESTLAKE, OREGON 97493

PREPARED BY: WOBBE & ASSOCIATES, INC.
510 KINGWOOD ST. / P.O. BOX 3093
FLORENCE, OR 97439
DATE: SEPTEMBER 27, 2019

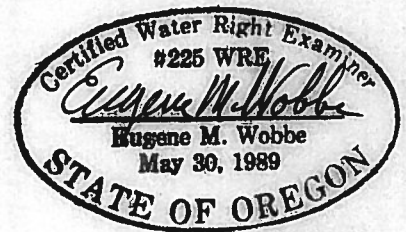

exp 6-30-2020

