

# T.7S., R.1W., W.M.

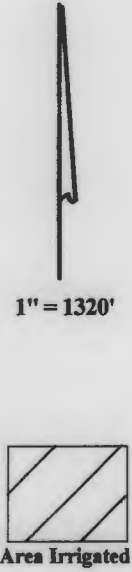
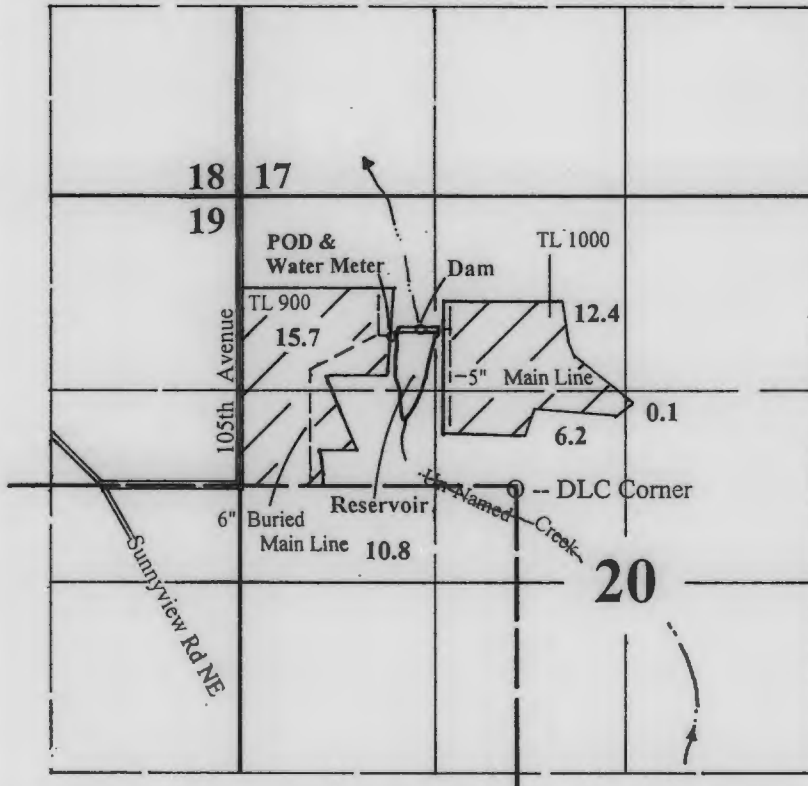

Dam is located 1085' N & 670' W from the NE corner of Dunbar DLC 48.  
 POD is located 1071' N & 820' W from the NE corner of Dunbar DLC 48.

RECEIVED

FEB 26 2018  
 OWRD

## Claim of Beneficial Use

In the Name of

# Robert and Nancy Simmons

Application #: R-73345      Permit #: R-11503  
 Application #: S-73346      Permit #: S-51540

Surveyed on October 30, 2017 by JM Schuette

This Map was Prepared for the Purpose of Identifying the Location of a Water Right Only and is Not Intended to Provide Legal Dimensions or Location of Property Ownership Lines.



EXPIRES: 6.30.2018