

T. 25 S., R. 7 W., W.M.  
SECTIONS 29 AND 30.

RECEIVED

DEC 24 2020

OWRD

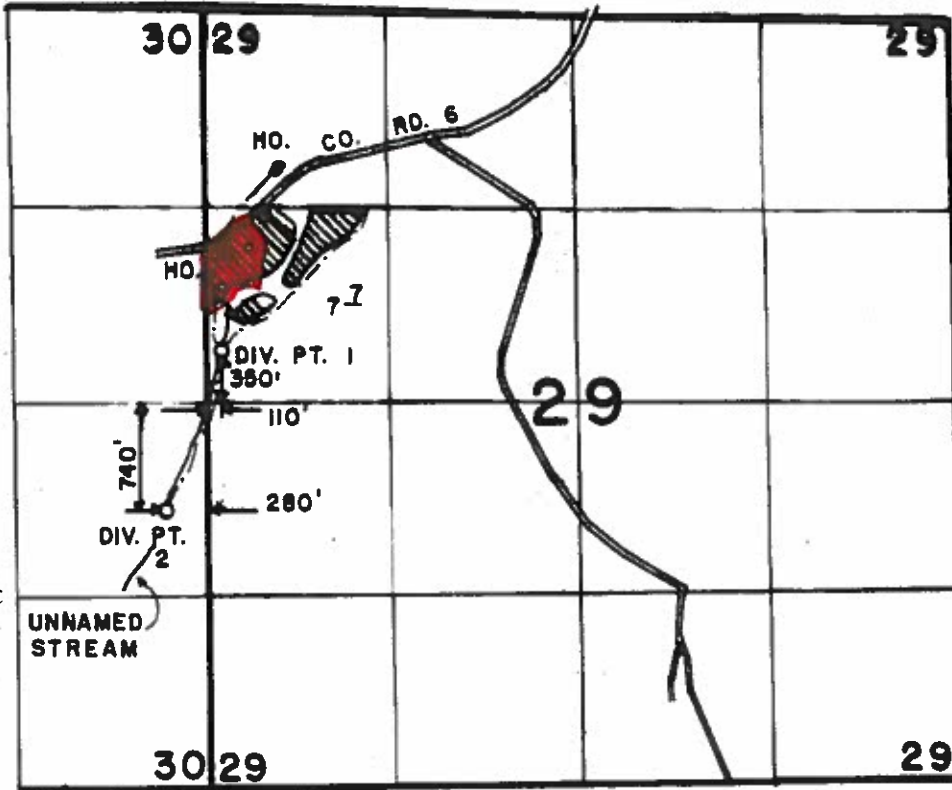

Red=  
Part Cancel  
→ one family  
Domestic  
#2.3 acres  
Irrigation  
(Tax Lot 900)

Remaining Right:  
5.4 acres of  
irrigation in  
SWNW; domestic  
use for one  
household in  
NWNW

SCALE: 4" = 1 MILE

FINAL PROOF SURVEY  
UNDER

Application No. 66412... Permit No. 48060...  
IN NAME OF

H.B. AND MELBA L. GERMOND

Surveyed OCT. 13... 19.87., by J.M. SCHMORDE