

FINAL PROOF MAP

TO ADD POINTS OF APPROPRIATION
FOR TRANSFER T-12536
MARY H. CARPENTER

TOWNSHIP 25 SOUTH, RANGE 30 EAST, SECTION 34, W.M.
TAX LOTS: 2001 AND 3900

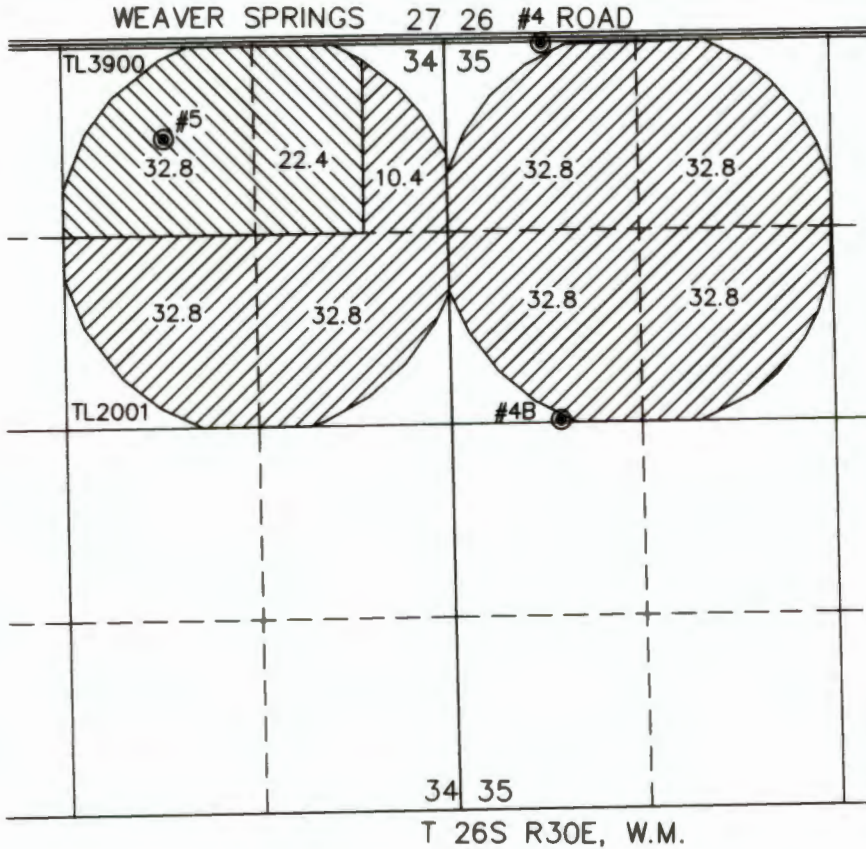

WELL 4 (HARN 1099)

- LOCATED IN THE NW 1/4 NW 1/4 SECTION 35, T25S R30E, W.M. AND 40 FEET SOUTH AND 670 FEET EAST FROM THE NW CORNER OF SECTION 35. NO FLOWMETER FOUND.

WELL 5 (HARN 1863)

- LOCATED IN THE NW 1/4 NE 1/4 SECTION 34, T25S R30E, W.M. AND 660 FEET SOUTH AND 700 FEET EAST FROM THE N 1/4 CORNER OF SECTION 34. FLOWMETER IS LOCATED 6 FEET SOUTH OF WELL.

WELL 4B (HARN 52585)

- LOCATED IN THE SW 1/4 NW 1/4 SECTION 35, T25S R30E, W.M. AND 2640 FEET SOUTH AND 755 FEET EAST FROM THE NW CORNER OF SECTION 35. FLOWMETER IS LOCATED 7 FEET NORTH OF WELL.

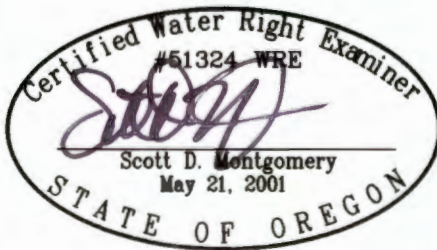

RENEWAL DATE: 12/31/2018



55.2 ACRES PRIMARY RIGHTS FROM WELLS 5 & 4B PER T-12536 (G-1530), AS SHOWN.



207.2 ACRES PRIMARY RIGHTS FROM WELLS 4B & 5 PER T-12536 (G-11242), AS SHOWN.

THIS MAP IS FOR THE PURPOSE OF LOCATING A WATER RIGHT ONLY AND HAS NO INTENT TO PROVIDE LEGAL DIMENSIONS OR THE LOCATION OF PROPERTY LINES.

RECEIVED

OCT 05 2018

OWRD

PREPARED FOR:

MARY CARPENTER
29328 WEAVER SPRINGS LANE
BURNS, OR 97720

PREPARED BY:



ALL POINTS ENGINEERING AND SURVEYING, INC.
P.O. BOX 767 (CRR) TERREBONNE, OR 97760
(541) 548-5833
www.APEandS.com