





T.9S. R.5W. Section 22, W.M.

Point of Re-diversion is located 1,055 feet south and 870 feet east from the center, Section 22.

Point of Diversion is located 1,315 feet south and 750 feet east from the center, Section 22. (Same location as referenced to SE corner, Section 22 in application T-12422)

-  Area (2.2 Acres) nursery use under T-12442.
-  Tax lot boundary
-  Donation Land Claim boundary
-  Mainlines

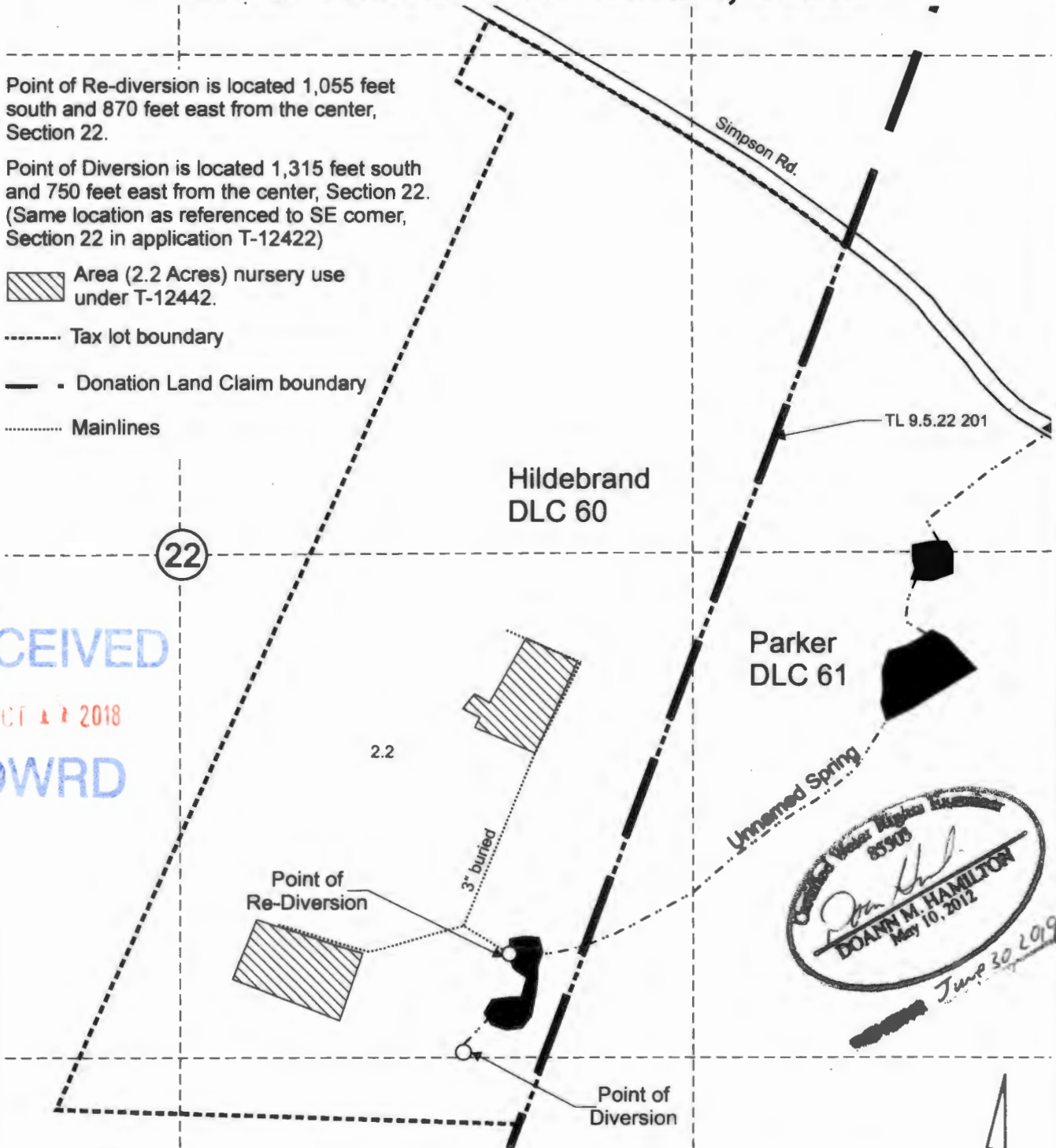

RECEIVED
OCT 17 2018
COURT

Water Rights Examiner
85503
Doann M. Hamilton
DOANN M. HAMILTON
May 10, 2012
June 30, 2019

Scale: 1" = 400'



This map was prepared for the purpose of identifying the location of a water right only and is not intended to provide legal dimensions or location of property ownership lines.



Griffin T-12422COBUMap.cdr

Pacific Hydro-Geology Inc.

09/2018

Claim of Beneficial Use Map
T-12422

Robert Leroy and Dian Griffin
T.9S. R.25W. Section 22, W.M.