

# T14S R39E Sections 20 and 21, W.M.

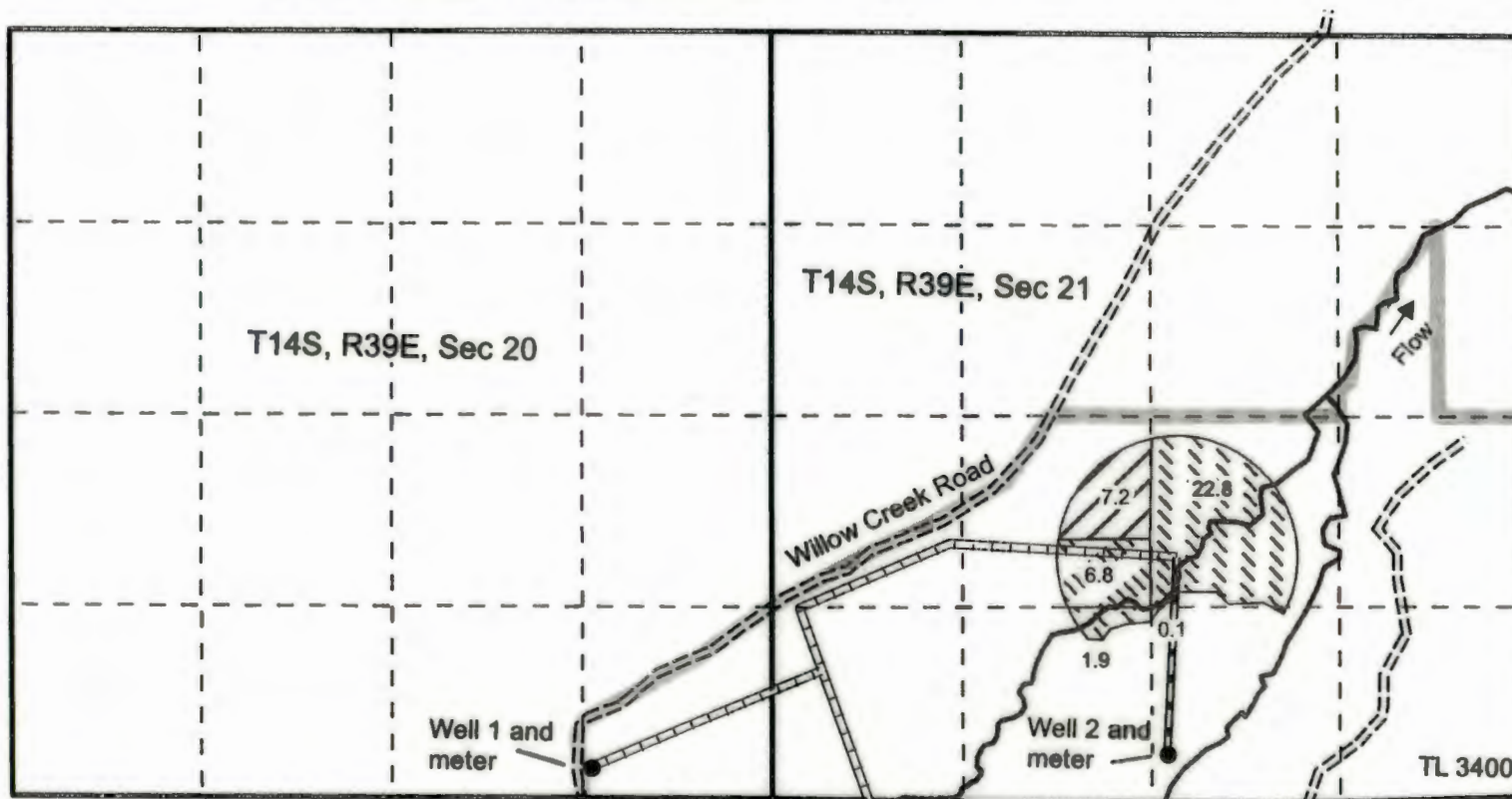

T17601 (priority 8/11/1989)

- Irrigated by well 1
- Irrigated by well 2

- Well and meter
- Stream
- 10-inch PVC pipeline
- 8-inch PVC pipeline
- Dirt road
- Paved road
- Section lines
- Quarter quarter line
- Tax lot lines

Well 1 (Malh 023) is located 200 feet north and 1,270 feet west of the SE 1/4 of Section 20.

Well 2 (Malh 026) is located 350 feet north from the S 1/4 corner of Section 21.

This map is not intended to provide legal dimensions or locations of property ownership lines.

0 660 1,320  
 Feet  
 1 inch = 1,320 feet



Final Proof Map  
 Christopher James Ray and Anne R. Ray  
 Transfer T11413, Priority 8/11/1989  
 Tax lot 3400  
 Nancy Rorick Consulting