

T.2S.R.2E.W.M.

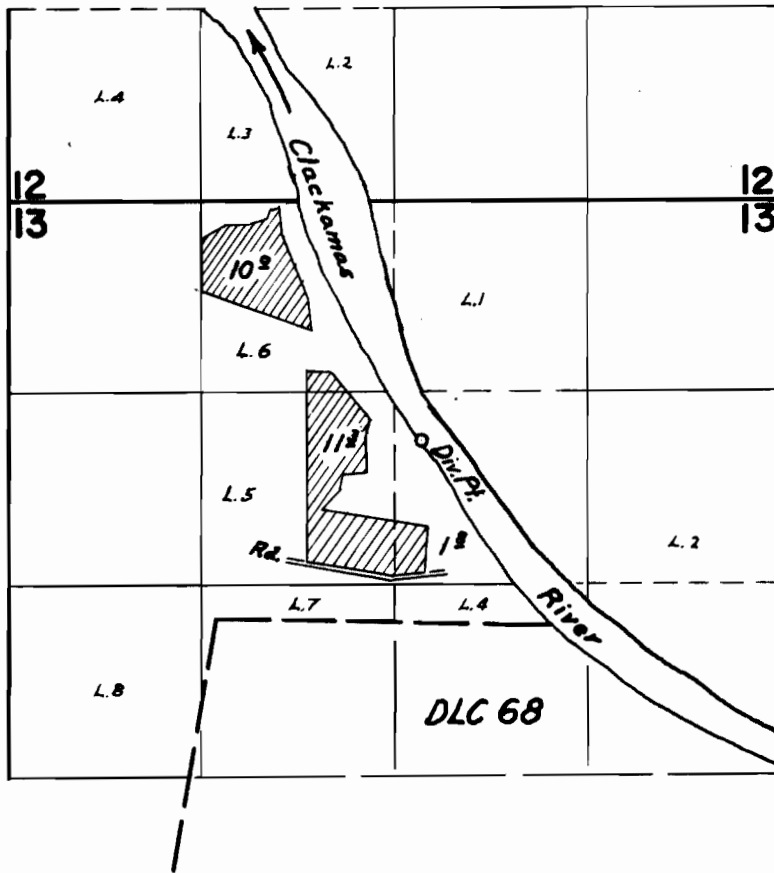

FINAL PROOF SURVEY UNDER

Application No. 32667 Permit No. 25796
IN NAME OF

Mrs. A. R. Smith

Surveyed May 16, 1962, by Thomas B. Lauer

Section 13, T2S, R2E, W.M., Clackamas County, Oregon
 AMENDED TRANSFER APPLICATION MAP
 Transfer T-13474
 Cal Farms Inc.

RECEIVED
 DEC 29 2020
 OWRD

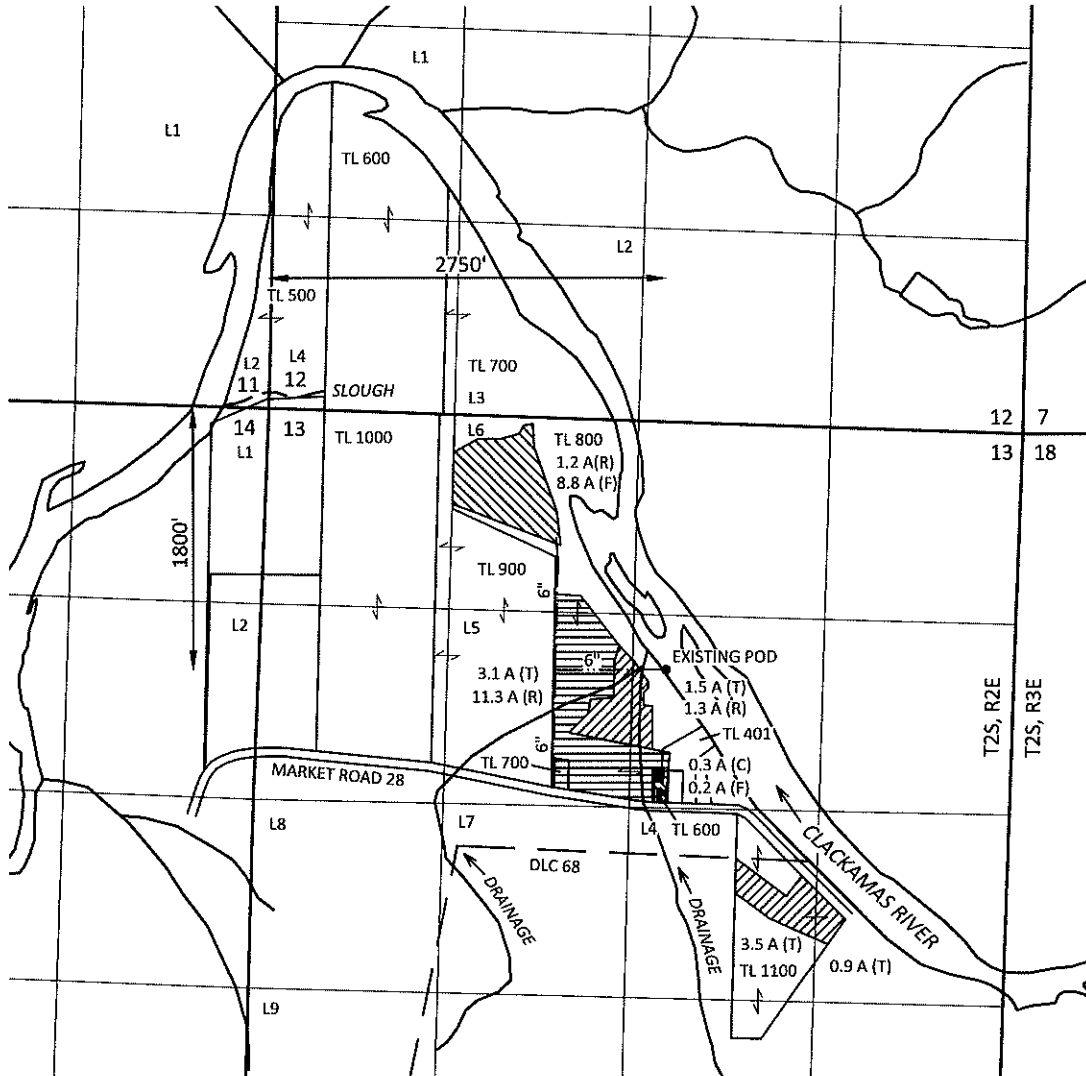

EXPLANATION

FROM LANDS (F)

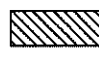
 CERTIFICATE 30928
 PRIORITY: 9/29/1958
 9.0 ACRES

TO LANDS (T)

 CERTIFICATE 30928
 PRIORITY: 9/29/1958
 9.0 ACRES

REMAINING RIGHTS (R)

 CERTIFICATE 30928
 PRIORITY: 9/29/1958
 13.8 ACRES

CANCELED RIGHTS (C)

 CERTIFICATE 30928
 PRIORITY: 9/29/1958
 0.3 ACRES

 POINT OF DIVERSION (POD)

 PIPELINE (APPROX.)

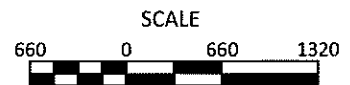

December 24, 2020

This map is not intended to provide legal dimensions or locations of property ownership lines

Figure 1

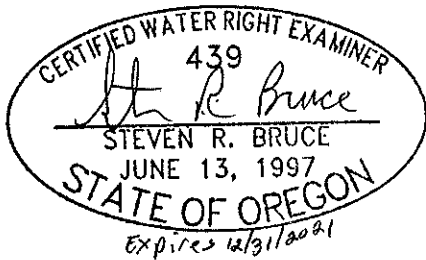

SKOOKUM
 WATER ASSOCIATES INC

1626 VICTORIAN WAY
 EUGENE, OR 97401
 (503) 319-8926

SUPERSEDING

Section 13, T2S, R2E, W.M., Clackamas County, Oregon
EVIDENCE-OF-USE AERIAL IMAGE
Transfer T-13474
Cal Farms Inc.

RECEIVED
DEC 29 2020
OWRD



Aerial Image Source: USDA/NAIP
Acquisition Date: 6/5/2016

EXPLANATION



CERTIFICATE 30928
PRIORITY: 9/29/1958
TAXLOT 600 LAWN/GARDEN/LANDSCAPING 0.2 A



SCALE



1 INCH = 200 FEET

December 24, 2020

This map is not intended to provide legal
dimensions or locations of property
ownership lines

SKOOKUM
WATER ASSOCIATES INC

1626 VICTORIAN WAY
EUGENE, OR 97401
(503) 319-8926

SUPERSEDING

Figure 2