

**T26S R33E, SECTION 13 &
T26S R34E, SECTION 18, WM**

HARNEY COUNTY, OREGON

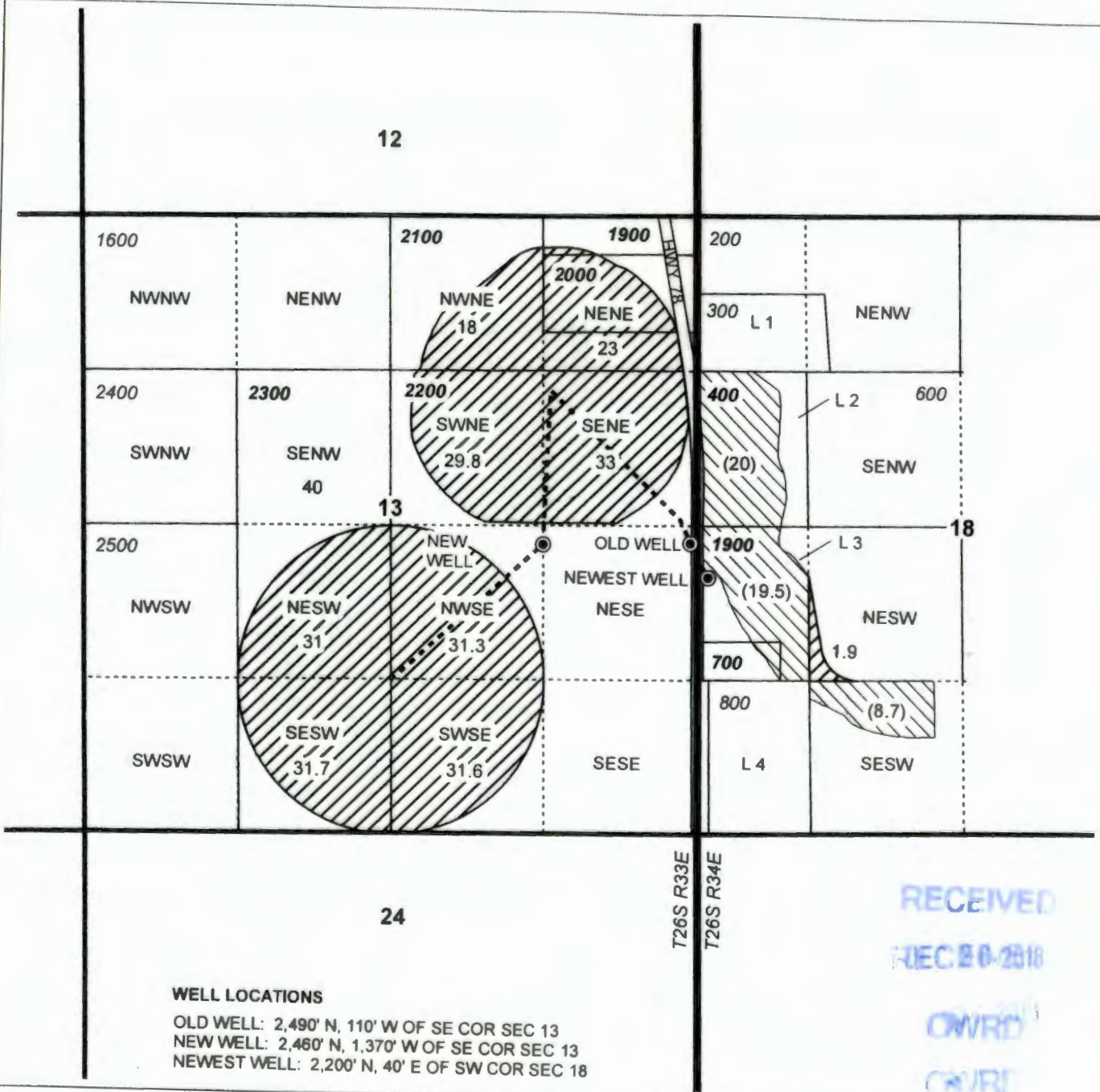

- POU IR 9/10/1974
- POU (IS) 9/10/1974
- Township
- Section
- Quarter Quarter
- Tax Lot
- Well & Meter
- Pipeline

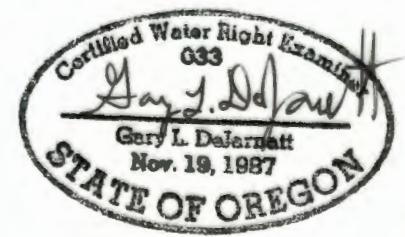

RENEWAL DATE 12/31/2019



WELL LOCATIONS
 OLD WELL: 2,490' N, 110' W OF SE COR SEC 13
 NEW WELL: 2,460' N, 1,370' W OF SE COR SEC 13
 NEWEST WELL: 2,200' N, 40' E OF SW COR SEC 18

RECEIVED
 DEC 20 2018
 OWRD
 CWRT

CLAIM OF BENEFICIAL USE MAP
 Thompson Ranch
 T-12378

NOTE: THIS MAP IS NOT INTENDED TO
 PROVIDE LEGAL DIMENSIONS OR LOCATIONS
 OF PROPERTY OWNERSHIP LINES.

WATER RIGHT SERVICES, LLC
 PO BOX 1830, BEND, OR 97709
 CCB# 197121 www.oregonwater.us
 541-389-2837 JOHNSHORT@USA.COM

**T26S R34E,
SECTIONS 19 & 20, WM**
HARNEY COUNTY, OREGON

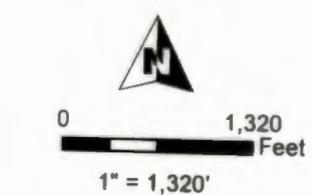
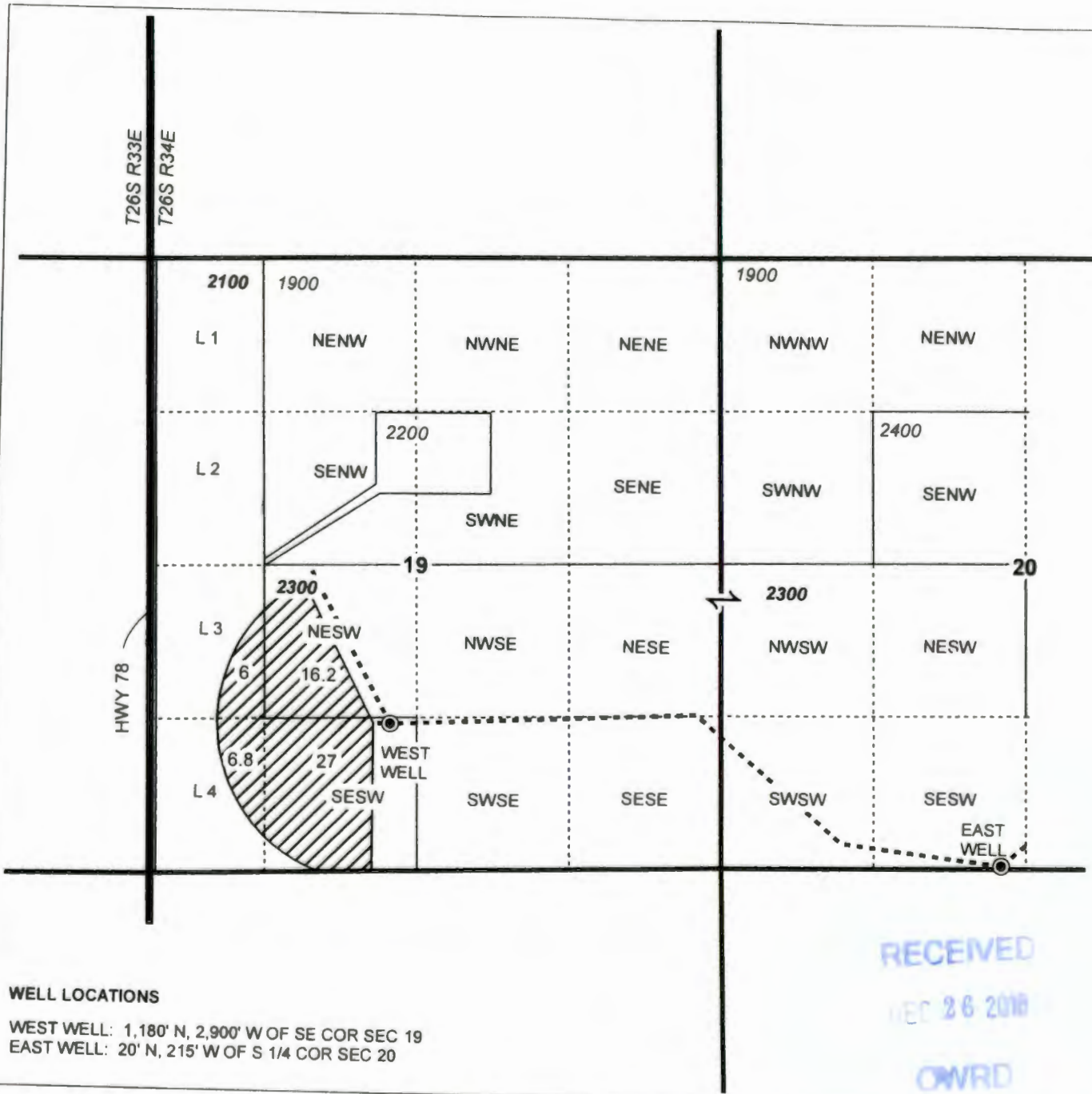

- POU IR 9/10/1974
- Township
- Section
- Quarter Quarter
- Tax Lot
- Well & Meter
- Pipeline



RECEIVED
DEC 26 2018
OWRD

RENEWAL DATE 12/31/2019



WELL LOCATIONS
WEST WELL: 1,180' N, 2,900' W OF SE COR SEC 19
EAST WELL: 20' N, 215' W OF S 1/4 COR SEC 20

CLAIM OF BENEFICIAL USE MAP
Thompson Ranch
T-12378

PG 7 OF 7

NOTE: THIS MAP IS NOT INTENDED TO
PROVIDE LEGAL DIMENSIONS OR LOCATIONS
OF PROPERTY OWNERSHIP LINES.

PROJECT #18047

Date: 12/10/2018

WATER RIGHT SERVICES, LLC
PO BOX 1830, BEND, OR 97709
CCB# 197121 www.oregonwater.us
541-389-2837 JOHNSHORT@USA.COM