

T24S R33E, WM  
HARNEY COUNTY, OR

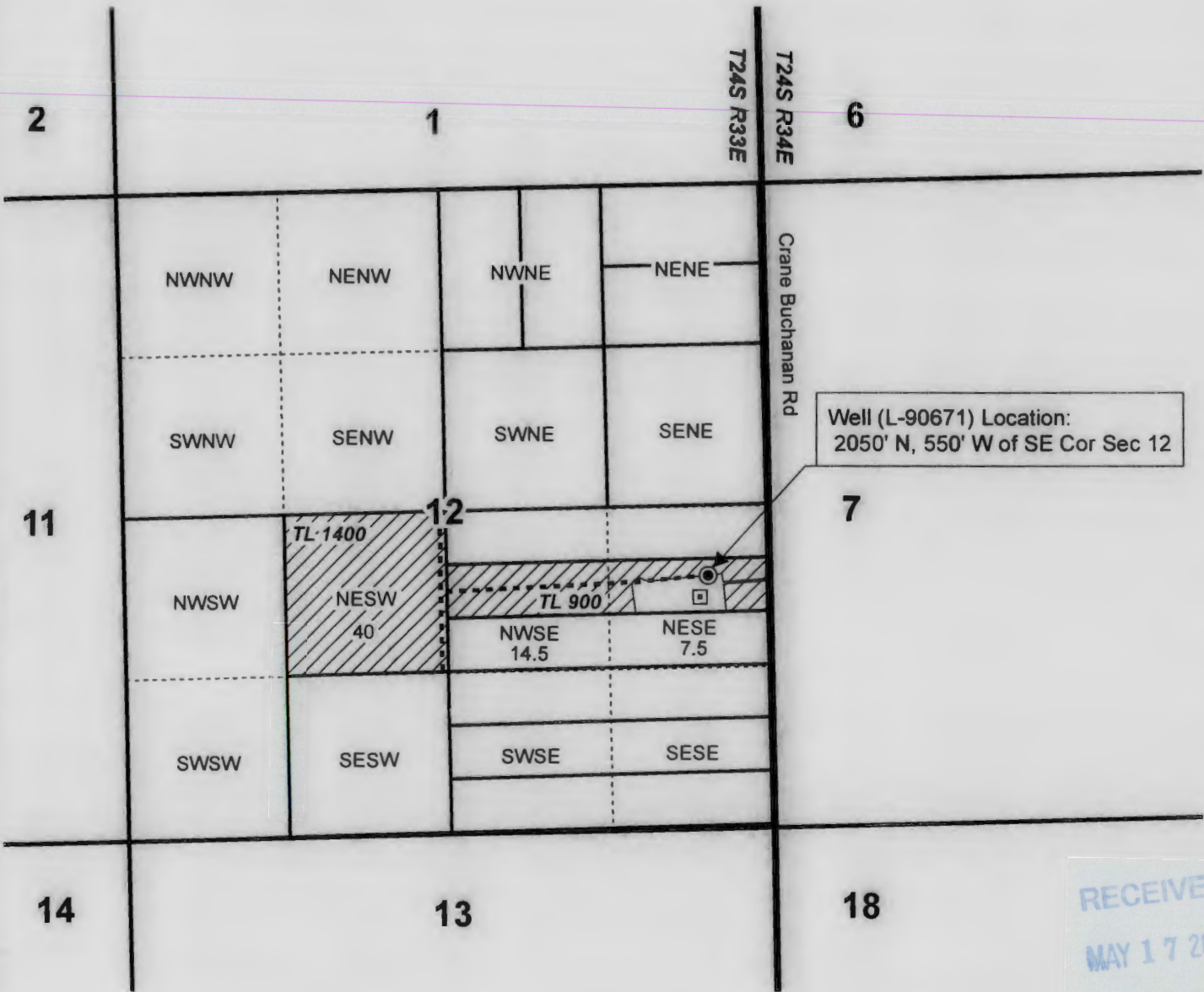

Well (L-90671) Location:  
2050' N, 550' W of SE Cor Sec 12

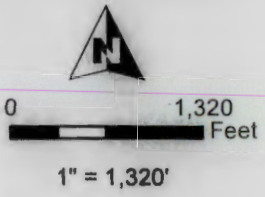

- ⊙ Well
- Meter
- Pipeline
- POU IR
- Township
- Section
- Quarter Quarter
- Taxlot

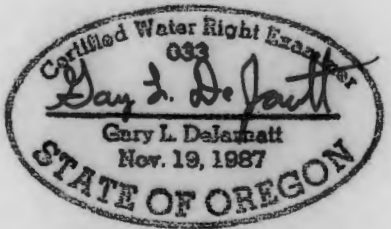

RENEWAL DATE 12/31/2019

RECEIVED  
MAY 17 2019  
OWRD



**CLAIM OF BENEFICIAL USE MAP**  
**RONALD KRETTINGER**

Date: 4/27/2019      Ap G-16969      Permit G-16395      Project #19011

This map is not intended  
to provide legal dimensions  
or locations of property  
ownership lines.

**WATER RIGHT SERVICES, LLC**  
PO BOX 1830, BEND, OR 97709  
[WWW.OREGONWATER.US](http://WWW.OREGONWATER.US)      CCB # 197121  
johnshort@usa.com      541-389-2837