

**T13S R13E, WM**  
**JEFFERSON COUNTY, OREGON**

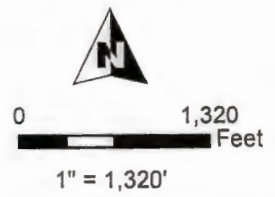

- POD, Fish Screen, & Meter
- River
- Pipeline
- POU IR 2-23-1946 Priority
- Township
- Section
- Quarter Quarter
- Tax Lot

POD LOCATION:  
 1,250' N, 2,200' E OF SW COR SEC 34

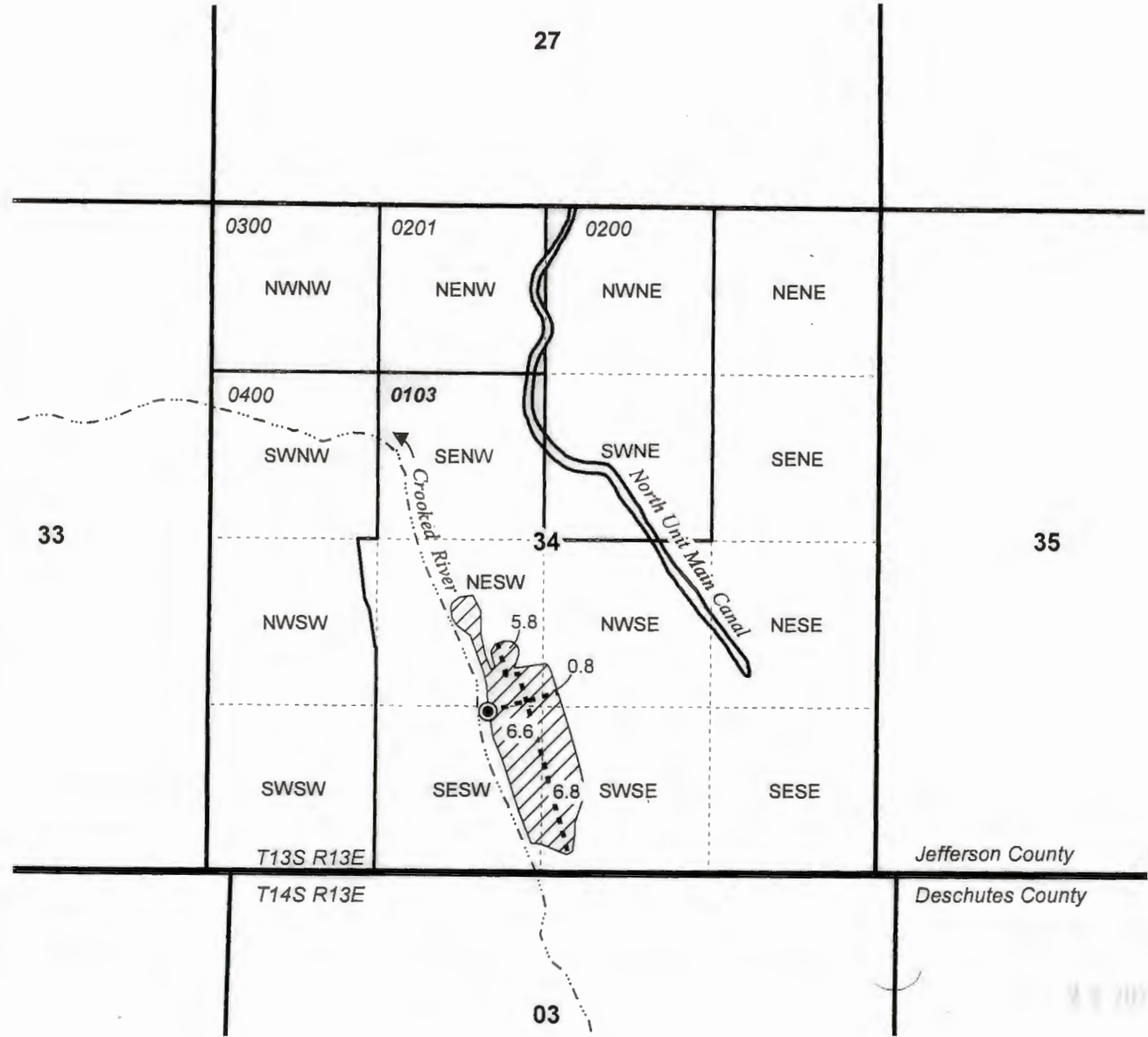
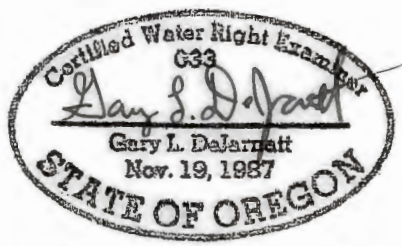

RENEWAL DATE 12/31/2021

**CLAIM OF BENEFICIAL USE MAP**  
**Knight Ranch**

PROJECT #20062

T-12795

Date: 10/8/2020

This map is not intended  
 to provide legal dimensions  
 or locations of property  
 ownership lines.

**WATER RIGHT SERVICES, LLC**  
 PO BOX 1830, BEND, OR 97709  
**WWW.OREGONWATER.US** CCB # 197121  
 johnshort@usa.com 541-389-2837