

T4S, R3W, WM, Sec 33 & 34, and T5S, R3W, Sec 3  
**TRANSFER 11558**  
**YAMHILL COUNTY**

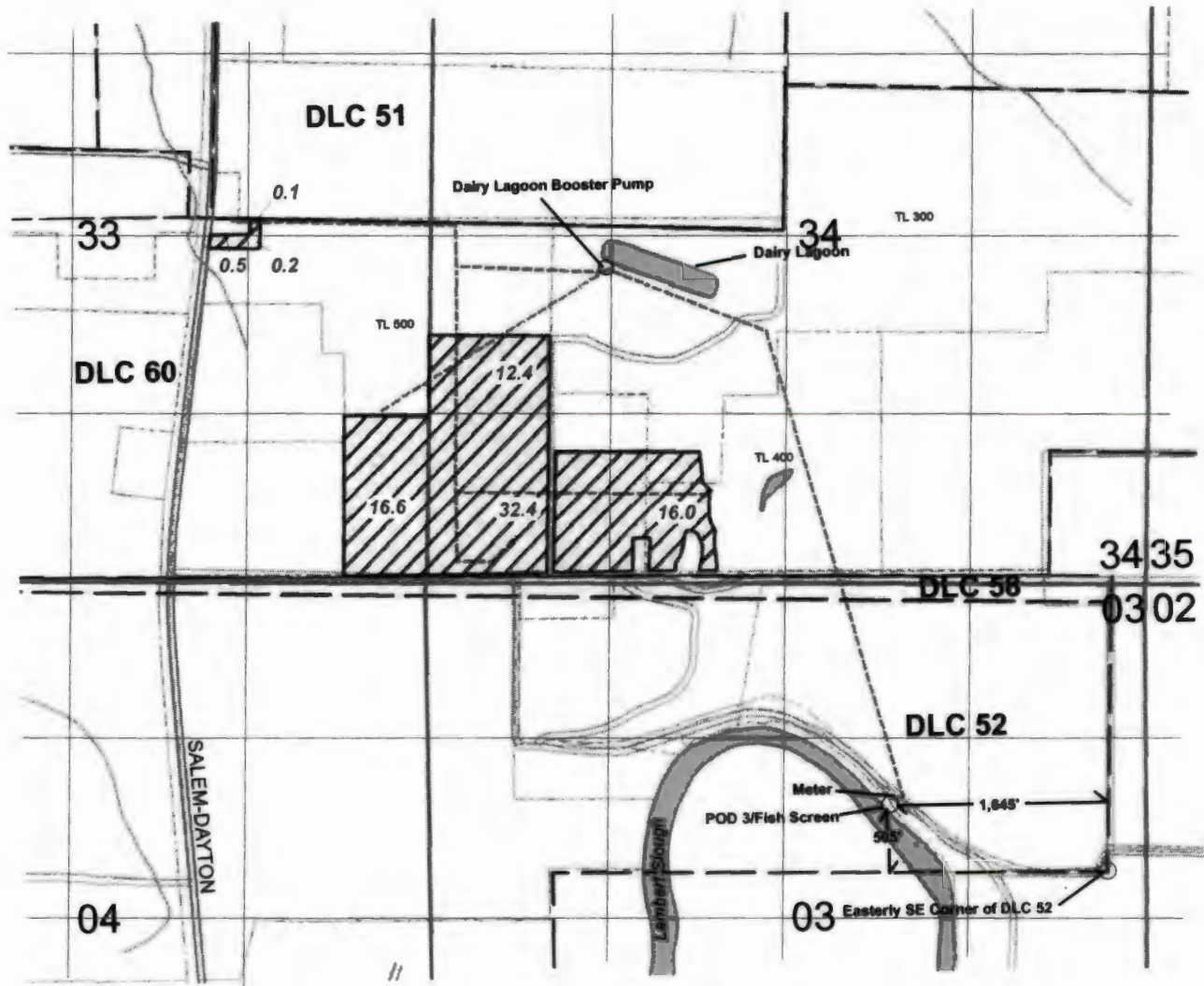

POD is located 505' N and 1,645' W from the Easterly SE corner of DLC 52

1 inch = 1,320 Feet

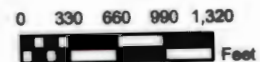

- Explanation**
- Point of Diversion (POD)/POD Pump
  - ▨ Place of Use (POU = 78.2 Acres)
  - ▭ Donation Land Claim (DLC) & ID
  - ▭ Yamhill County Tax Lot & ID
  - ▭ Water Features
  - Main Line (10-inch diameter mainline, buried to Dairy Lagoon booster pump)
  - == Roads

World Geodetic System (WGS)  
 Datum of 1984  
 Prepared October 4, 2016

Sources: BLM CadNSDI PLSS (GeoCommunicator LSIS, 2014); The Oregon Map (ORMAP tax lots, 2016); available County roads, lakes, and rivers GIS shapefiles (EnviroLogic Resources, ArcGIS Backup Files, 2016)

This map was prepared for the purpose of identifying the location of a water right only and is not intended to provide legal dimensions or locations of property

**EnviroLogic Resources, Inc.**  
 ENVIRONMENTAL • WATER RESOURCES SCIENTISTS



**CLAIM OF BENEFICIAL USE MAP**  
**T-11558**