

Section 33, T5S, R5W, W.M., Yamhill County, Oregon

Transfer T-11876
CLAIM OF BENEFICIAL USE MAP
Zach Christensen

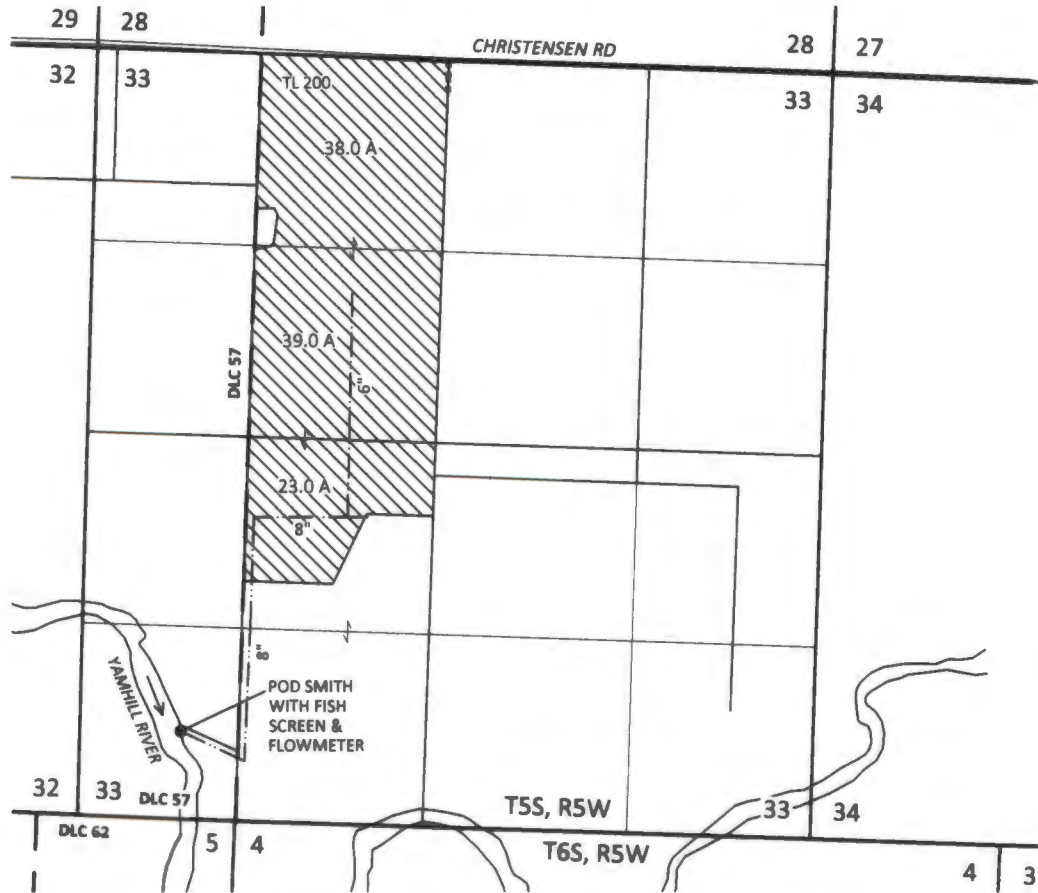

POD SMITH LOCATION: 570 FT N AND 710 FT E
FROM SW CORNER OF SECTION 33, T5S, R5W, W.M.



SITE INSPECTION CONDUCTED JULY 26, 2016

RECEIVED

SEP 07 2016

WATER RESOURCES DEPT
SALEM, OREGON

EXPLANATION

-  CANCELED CERTIFICATE 62271
100.0 ACRES
PRIORITY: 3/3/1978
-  POINT OF DIVERSION (POD)
-  PIPELINE

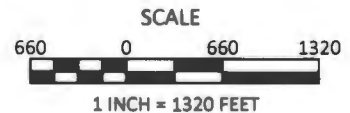

SKOOKUM
WATER ASSOCIATES INC

1626 VICTORIAN WAY
EUGENE, OR 97401
(503) 319-8926

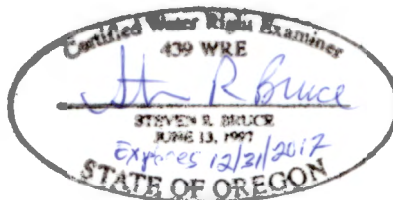

August 24, 2016

This map is not intended to provide legal
dimensions or locations of property
ownership lines

Figure 1