

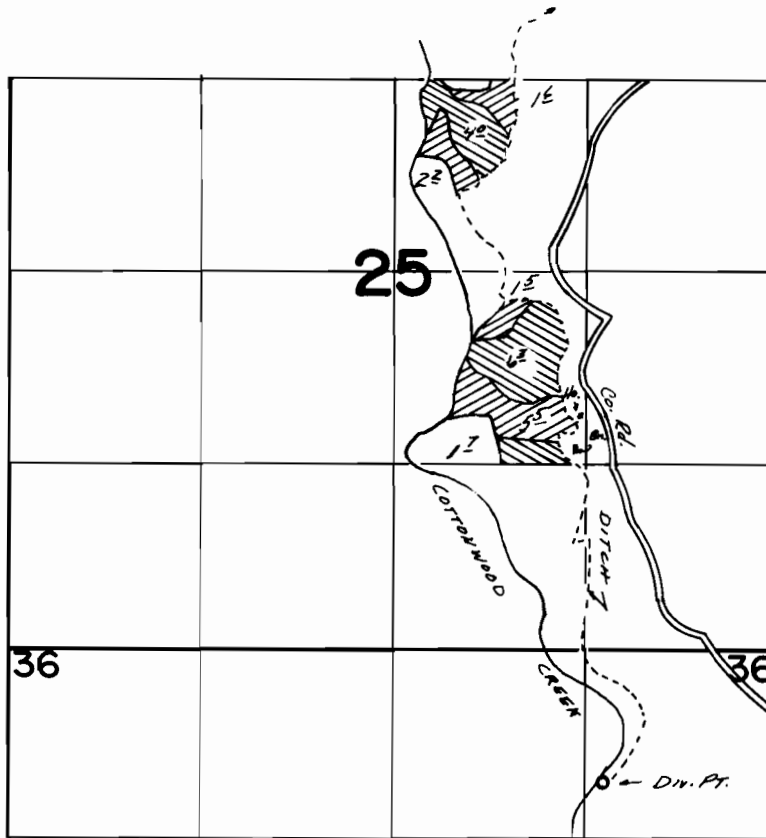

T.10 S. R.27 E. W.M.



Div. Pt. Loc. 900' S of 1180' W From NE Cor. Sec. 36

PRIMARY → 
SUPPL. TO → 
CERT. # 20306 →

FINAL PROOF SURVEY UNDER

Application No. 54622 Permit No. 40984
IN NAME OF

BERNARD B. & GRACE G. FITZ

Surveyed Oct. 15, 1977, by S.C. BROWN

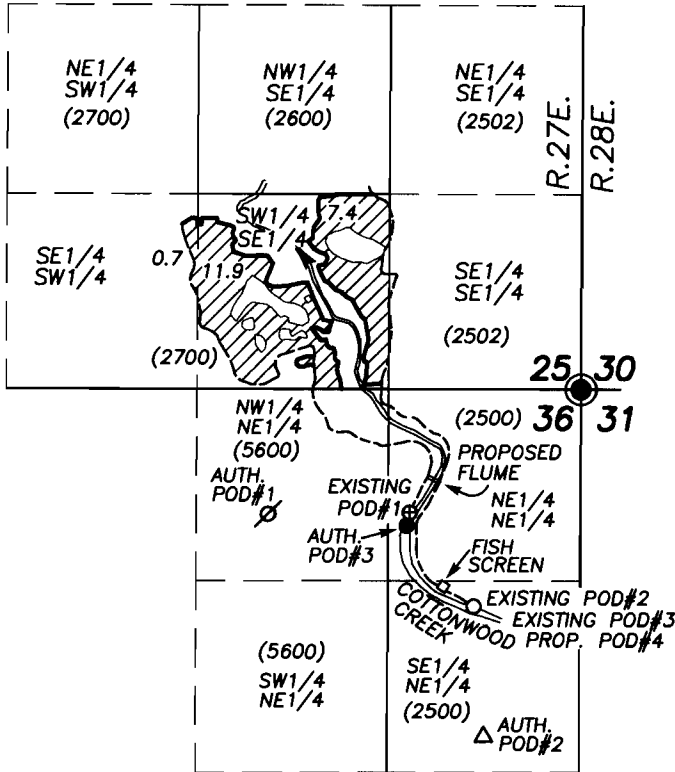

SCALE: 1" = 1320'

**APPLICATION MAP
FOR
CHANGE OF POINT OF DIVERSION
FOR
GARY ENGLE**

BY

ROBERT D. BAGETT
217 N. CANYON BLVD.
JOHN DAY, OREGON
(541) 575-1251

NOVEMBER 11, 2009

- ∅ AUTHORIZED POD#1: PER PERMIT 1239
858 FT. SOUTH & 2145 FT. WEST OF NE COR. SEC. 36
- ⊕ HISTORIC AND CURRENT LOCATION POD#1:
850 FT. SOUTH & 1170 FT. WEST OF NE COR. SEC. 36

- △ AUTHORIZED POD #2: PER PERMIT 1239
2392 FT. SOUTH & 660 FT. WEST OF NE COR. SEC. 36
- HISTORIC AND CURRENT LOCATION POD#2:
1500 FT. SOUTH & 730 FT. WEST OF NE COR. SEC. 36

- AUTHORIZED POD #3: PER CERTIFICATE 47400
900 FT. SOUTH & 1180 FT. WEST OF NE COR. SEC. 36
- HISTORIC AND CURRENT LOCATION POD#3:
1500 FT. SOUTH & 730 FT. WEST OF NE COR. SEC. 36

- PROPOSED POD #4:
1500 FT. SOUTH & 730 FT. WEST OF NE COR. SEC. 36

C-946

FD. GRANT COUNTY SURVEYOR
BRASS CAP

----- DITCH

() TAX LOT NO.

NOTE: LOCATION OF THE CURRENT EXISTING POD'S AND IRRIGATED FIELDS IS THE RESULT OF AN ON THE GROUND SURVEY FOR THIS TRANSFER.

T 10997

NOTE: THE PREPARATION OF THIS MAP WAS FOR THE PURPOSE OF IDENTIFYING THE LOCATION OF THE PROPOSED WATER RIGHT AND HAS NO INTENT TO PROVIDE DIMENSIONS OR LOCATION OF PROPERTY OWNERSHIP LINES.

RECEIVED
DEC 9 8 2009
WATER RESOURCES DEPT
SALEM, OREGON

