

**JASON & RUTH SCHROCK TRUST
PAUL & MARY ZEHR TRUST
CLAIM OF BENEFICIAL USE
EXHIBIT MAP 1 OF 2**

JANUARY 16, 2021

TAX MAP 14S04W11

located in
SECTION 11, TOWNSHIP 14 SOUTH,
RANGE 4 WEST, WILLAMETTE
MERIDIAN LINN COUNTY, OREGON

TRANSFER T-12194

PLACE OF USE

AREA A

JASON & RUTH SCHROCK TRUST
20.6 PRIMARY IRRIGATED ACRES
TAX LOT 200
NE 1/4, NE 1/4, SECTION 11,
T 14S, R 04W, W.M.

AREA B

JASON & RUTH SCHROCK TRUST
2.7 PRIMARY IRRIGATED ACRES
TAX LOT 200
NW 1/4, NE 1/4, SECTION 11,
T 14S, R 04W, W.M.

AREA C

PAUL & MARY ZEHR TRUST
0.7 PRIMARY IRRIGATED ACRES
TAX LOT 202
NW 1/4, NE 1/4, SECTION 11,
T 14S, R 04W, W.M.

AREA D

PAUL & MARY ZEHR TRUST
13.1 PRIMARY IRRIGATED ACRES
TAX LOT 202
SW 1/4, NE 1/4, SECTION 11,
T 14S, R 04W, W.M.

RECEIVED

JAN 22 2021

OWRD

AREA B

AREA C

AREA D

MUDDY CREEK

200

AREA A

202

2 1
11 12

POWERLINE ROAD

BASIS OF BEARINGS: CS 21612

PLACE OF USE RELATIVE TO NE CORNER OF SECTION 11 ARE BASED ON A GPS SURVEY

THIS MAP IS NOT INTENDED TO PROVIDE LEGAL DIMENSIONS OR LOCATION OF PROPERTY OWNERSHIP LINES

LEGEND

- ← MUDDY CREEK
- SECTION LINE
- - - QTR-QTR SECTION LINE
- - - TAX LOT LINE
- SECTION CORNER, AS NOTED



SCALE: 1" = 400'

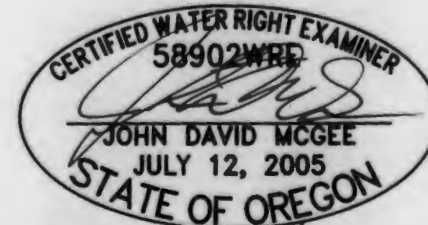

RENEWS: 12/31/2022

JDMcGee, Inc.

Engineering &
Surveying Planning
Wastewater Design
"Solving Problems for You"

1215 Main Street
PO Box 1472
Prineas, OR 97370
(541) 929-4226
(541) 929-4227 fax

DRAWN BY: KP
JDM PROJECT #: 20-35

CHECKED BY: JDM

This map is not intended to provide legal dimensions or locations of property ownership lines.

T14S R4W, W.M.

RECEIVED BY OWRD

OCT 26 2015

Transfer T- In the name of **Muddy Creeks Irrigation District** Certificate # 75255

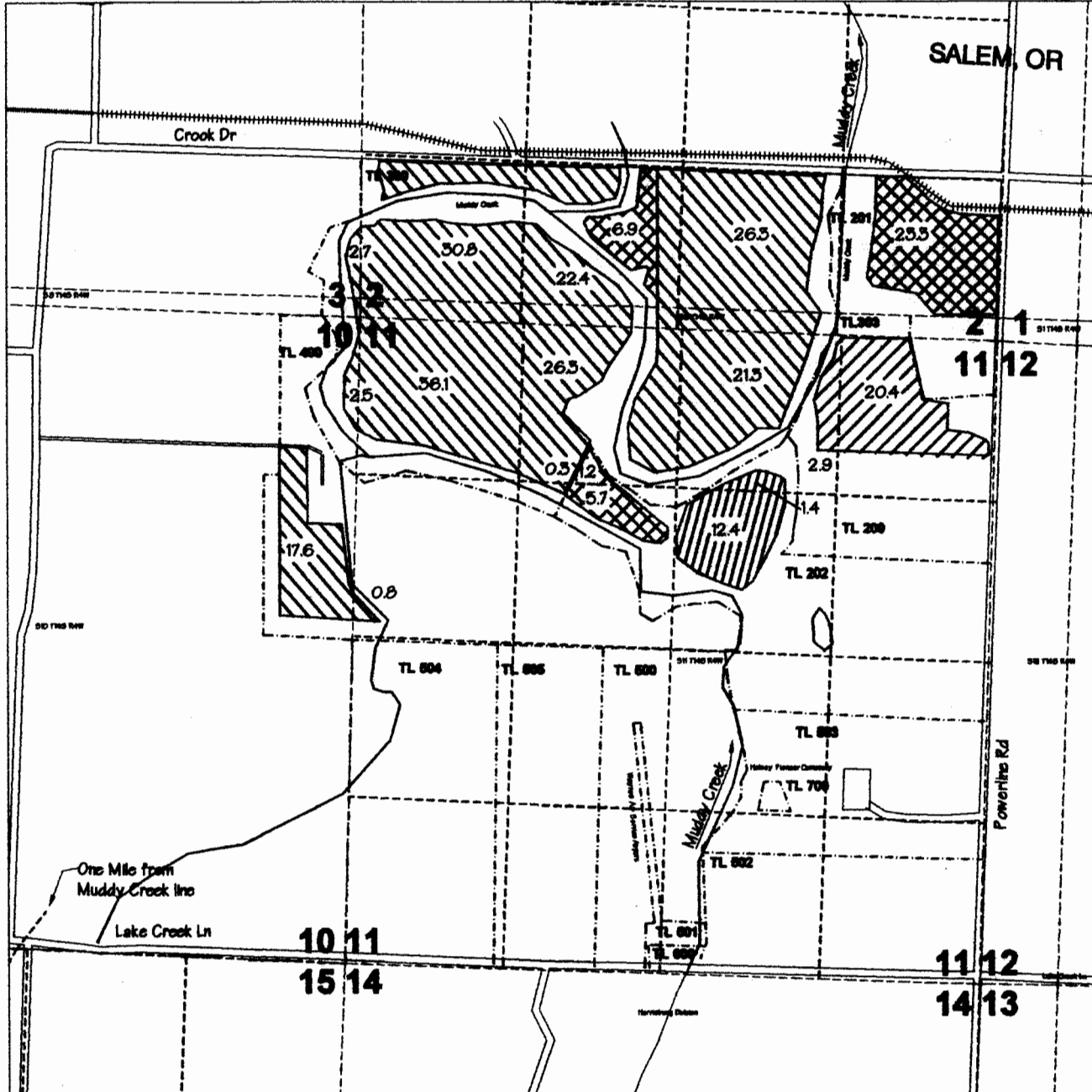

From: 

To: 

Remaining: 

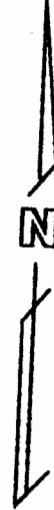

Prepared by
Walter L. Trimmer
CWRE #332
Trimmer Engineering Inc.
3924 NW Walnut Place
Corvallis, OR 97330
541-754-2819

Scale 1" = 1320'
September 28, 2015
Layout: Zehr
File: Muddy_Crks.dwg
Based on USGS Halsey Quad
DWG 1 of 1

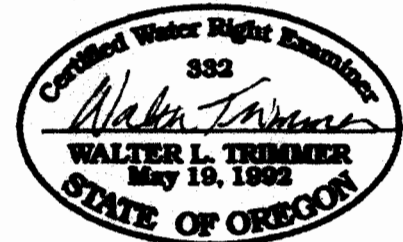

Expires 6/30/2016

JASON & RUTH SCHROCK TRUST
CLAIM OF BENEFICIAL USE
EXHIBIT MAP 2 OF 2

MAY 1, 2020

TAX MAP 14S04W11
 located in
 SECTION 11, TOWNSHIP 14 SOUTH,
 RANGE 4 WEST, WILLAMETTE
 MERIDIAN LINN COUNTY, OREGON

TRANSFER T-12194

D.L.C. 38
 J. SPORES

901

1701

1602

1601

1600

MUDDY CREEK

1801

1802

1800

2000

MCKENZIE RIVER

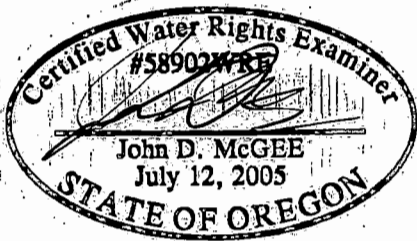

RENEWAL DATE: 12/31/2020

LEGEND

- MUDDY CREEK
- SECTION/QTR-SECTION LINE
- TAX LOT LINE
- DLC LINE
- EXISTING POINT OF DIVERSION
- D.L.C. CORNER, AS NOTED



SCALE: 1" = 400'

JDMcGee, Inc.

Engineering & Surveying
 Land Use Planning
 Wastewater Design
 "Solving Problems for You"

1215 Main Street
 P.O. Box 1472
 Philomath, OR 97370
 (541) 929-4226
 (541) 929-4227 fax

DRAWN BY: KP
 JDM PROJECT #: 20-35

CHECKED BY: JDM

SOUTH 1/4
 SECTION 4

D.L.C. 44 E. RHEA

NW CORNER D.L.C. 43
 G. ARMITAGE

P.O.D.
 EXISTING POINT OF DIVERSION
 LOCATED 727' N AND 2500' E
 OF NW CORNER D.L.C. 43 G. ARMITAGE
 LOCATED 4440' S AND 5250' E
 OF SE CORNER D.L.C. 79 J. MANSFIELD

THIS MAP IS NOT INTENDED TO PROVIDE LEGAL DIMENSIONS
 OR LOCATION OF PROPERTY OWNERSHIP LINES

DLC 43 G. ARMITAGE

OWRD

JUN 02 2020

RECEIVED