

# T6N R35E, WM, SECTIONS 27, 28, 34 & 35 - UMATILLA COUNTY

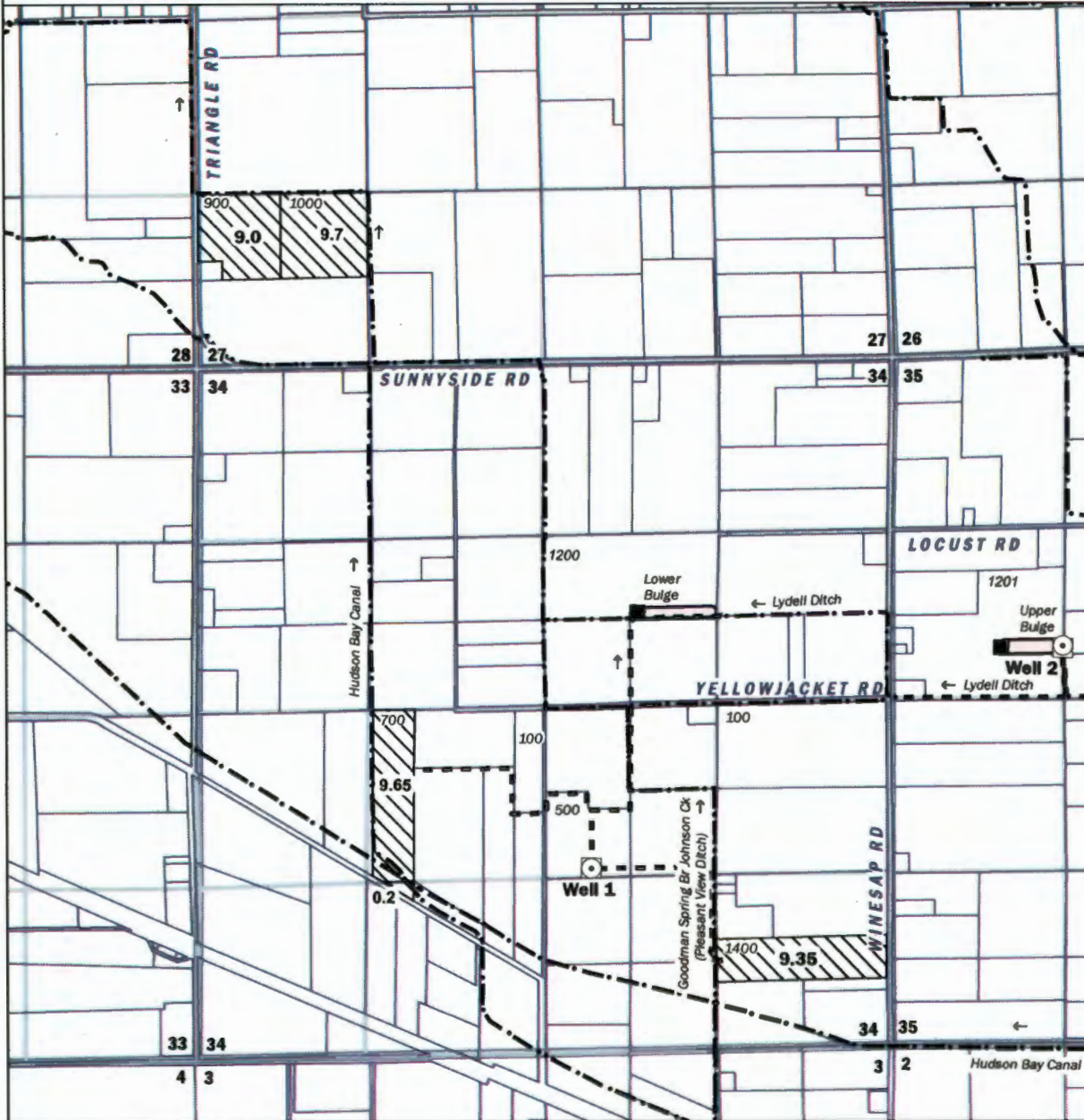

**POU TO**

Transfer supplemental irrigation of 37.9 acres and temperature control TO:

SECTION 27  
SW SW 18.5 ac

SECTION 34  
NE SW 9.55 ac  
SE SE 9.85 ac

**STACKED WATER RIGHTS**

TL 900  
GR-3349 (1912)  
Cert 92687 (1913)  
Cert 92687 (1959)  
Cert 92686 (1983)

TL 1000  
Cert 92687 (1913)  
Cert 92687 (1959)  
Cert 92685 (1928)  
Cert 92685 (1958)

TL 700  
Cert 92923 (1912)  
GR-2018 (1914)  
Cert 92923 (1959)  
Cert 87556 (1978)

TL 1400  
GR-1155 (1908)  
Cert 87556 (1978)  
Cert 83957 (2000)

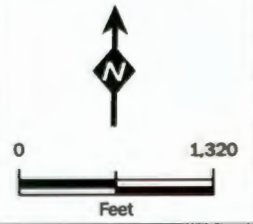

**Well**

Well 1 is located in NW SE of Section 34, about 1245 feet S and 355 feet E from the Center of Section 34. Well constructed in basalt aquifer (Well Log UMAT 54341). Flowmeter is located due north of well.

Well 2 is located in SW NW of Section 35, about 405 feet N and 1310 feet E from the West Quarter of Section 35. Well constructed in basalt aquifer (Well Log UMAT 54464). Flowmeter is located due south of well.

**Pump Station** **Pipeline** **Ditch**

Water from Well 1 flows into pressurized pipeline serving places of use and/or into Lower Bulge located in SW NE, Sec 34.)

Water from Well 2 flows into pressurized pipeline serving places of use, and/or Upper Bulge located in SW NW, Sec 35, and/or via Lydell Ditch (pipeline and ditch) to Lower Bulge.

Water delivered directly from wells to places of use, and via bulges, with a complex system of pipelines, ditches and pump stations. Water applied to permanent crops for supplemental irrigation and temperature control with sprinkler and drip irrigation systems.

**DISCLAIMER**

The purpose of this map is to identify the location of a water right. It is not intended to provide information regarding the location of property ownership boundary lines.

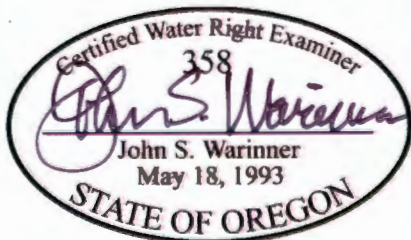

**Claim of Beneficial Use Map  
Transfer 12897**

in the name of  
Earl Brown & Sons  
Umatilla County, OR



SEP-2019  
PROJECT NO.  
170682

BY:  
EAC / JW  
REVISED BY:  
---

FIGURE NO.  
**1**