

Claim of Beneficial Use Map - Application G-15887 / Permit G-16312

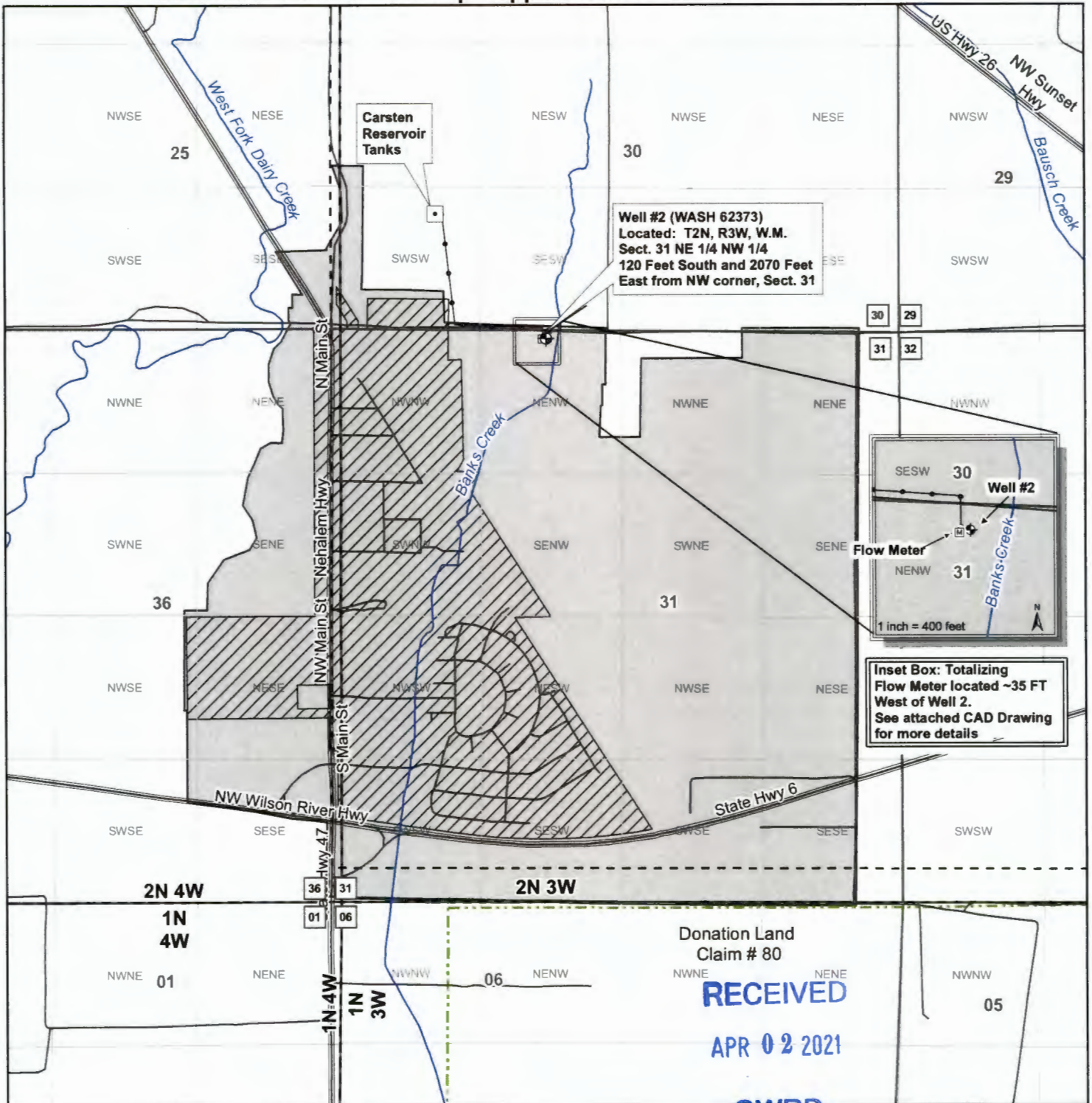

Donation Land
 Claim # 80

RECEIVED

APR 02 2021

OWRD

City of Banks-Well 2 (WASH 62373)
 Lat: 45.6214, Long: -123.10655
 Application: G-15887
 Permit: G-16312

T. 2N., R. 3W. W.M. Sect. 30, 31
 T. 2N., R. 4W. W.M. Sect. 25 and 36

- Legend**
- Well 2 (WASH 62373)
 - Magnetic Flow Meter in Vault
 - Carsten Reservoir Tanks
 - Streams
 - Highways
 - Place of Use (Service Area) per Permit 16312
 - Updated Place of Use (Service Area) per UGB
 - Donation Land Claim
 - Township/Range
 - 31 Sections
 - NENW 1/4, 1/4 Sections

CWRE SEAL:

Robert E. Long Jr.
 Robert E. Long Jr.
 May 15, 2002
 STATE OF OREGON

EXPIRATION DATE: 12-31-2021



13680 NW Main Street
 Banks, Oregon 97106



1319 SE MLK JR BLVD #204
 Portland, OR 97214

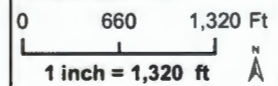

This map is not intended
 to provide legal dimensions
 or property ownership lines.

C:\01 Projects\1501004 Water Supply Development\6. Applications\CBUWell 2\Banks_CBU_WASH62373_12May2020.pdf JST