

Section 22, T5S, R5W, W.M.,
Yamhill County, Oregon

RECEIVED

JUL 09 2021

OWWRD

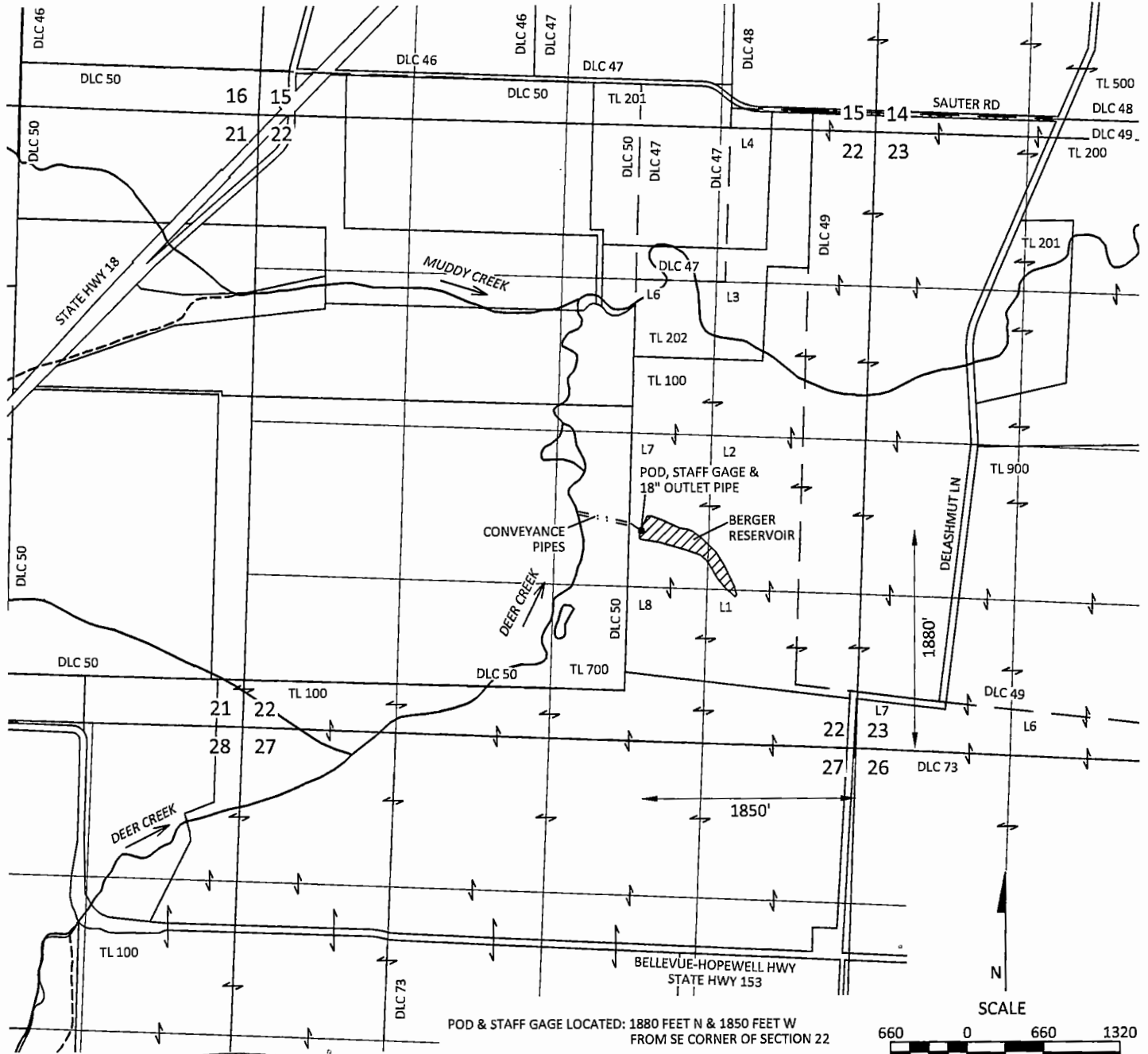

Application R-88742, Permit R-15431
CLAIM OF BENEFICIAL USE MAP
KA Berger Farms Inc.

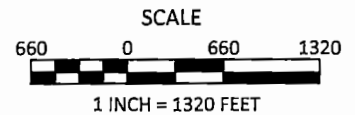

POD & STAFF GAGE LOCATED: 1880 FEET N & 1850 FEET W
FROM SE CORNER OF SECTION 22



EXPLANATION

-  BERGER RESERVOIR
2.7 ACRES
24.3 ACRE FEET
PRIORITY: 9/17/2019
-  POINT OF DIVERSION (POD)
-  PIPELINE

JUNE 8, 2021

This map is not intended to provide legal
dimensions or locations of property
ownership lines

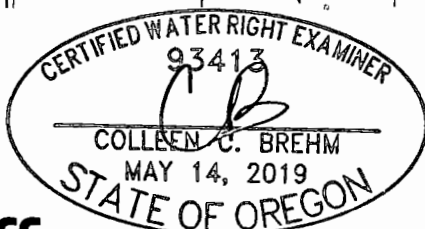

kpff

111 SW 9th Ave., Suite 2600
Portland, OR 97204
P: 503.241.2862
F: 503.241.4621
www.kpff.com

Site inspection conducted
MARCH 9, 2021

Figure 1