

Johnson Family Pond 2S 12E 0 2101 & 2102

Envelope ID: DB97693A-89CD-46DF-936A-73DCA9F09119

RECEIVED
DEC 28 2018
OWRD

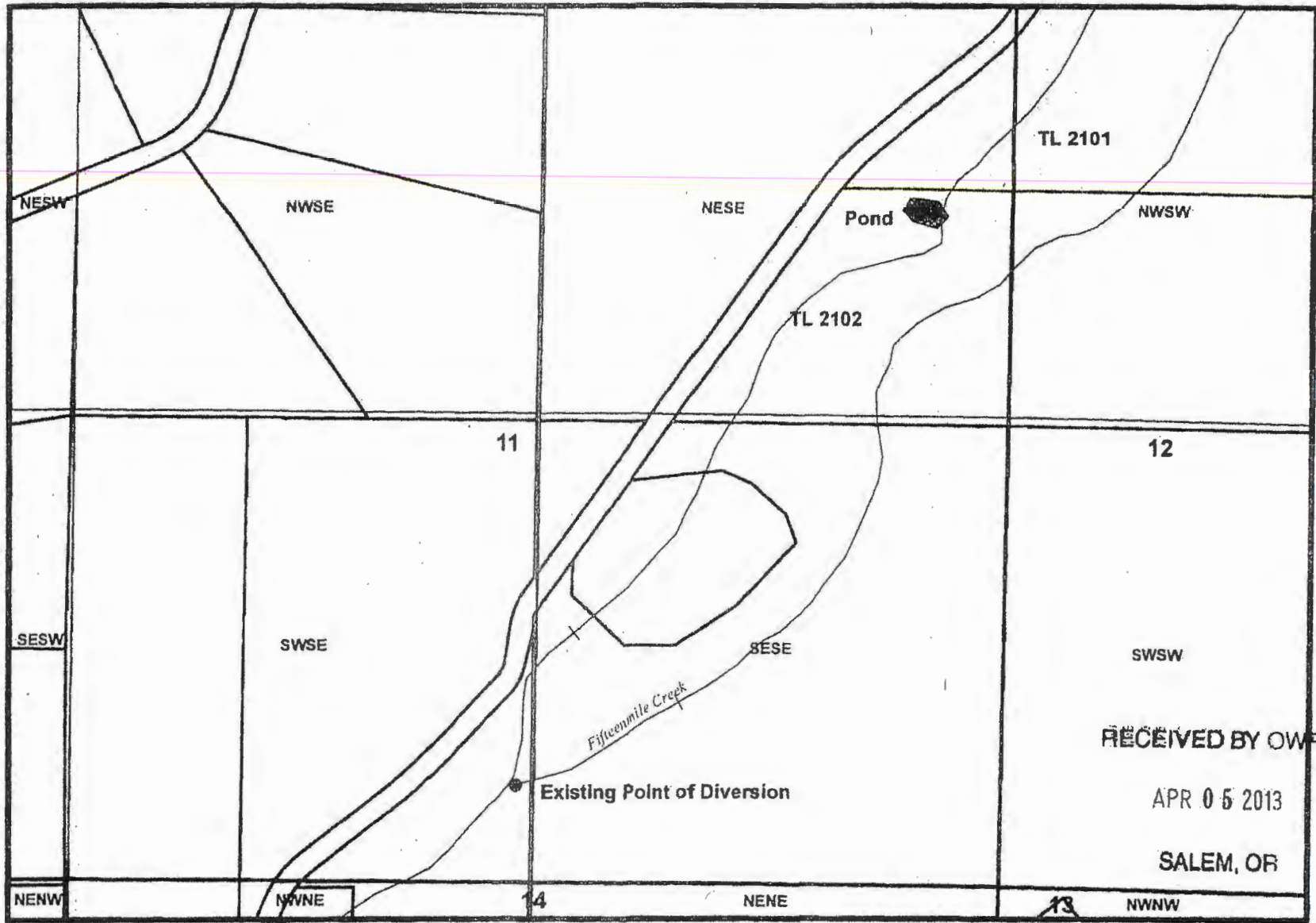

RECEIVED BY OWRD
APR 05 2013
SALEM, OR

Little Ditch Diversion: The POD is 1,390 ft West and 273 ft North of the SE Corner, Section 11, being in the SW SE Section 11.

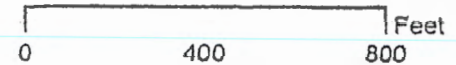

2-878885
 DS
 Documented by:
 Skully L Howard
 2/3/2018
 2/3/2018