

T.13S., R.29E., W.M.

RECEIV

SEP 30

OWR

RECEIVED

SEP 30 2019

OWRD

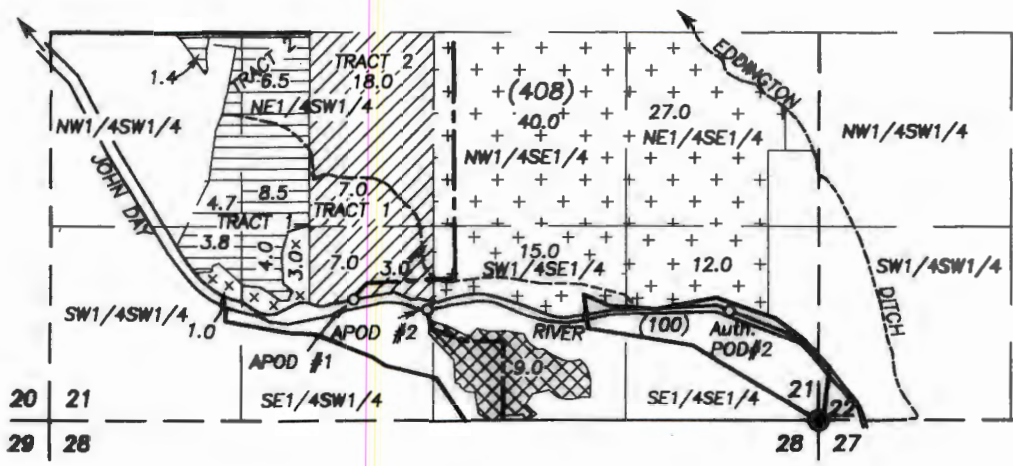

SCALE: 1" = 1320'

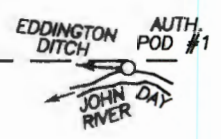

Authorized POD #1 50 ft. South and 3380 ft. East of NW Cor. Sec. 27
 Authorized POD #2 730 ft. North and 620 ft. West of SE Cor. Sec. 21
 Authorized POD #3 565 ft. North and 2320 ft. West of E1/4 Cor. Sec. 29, T.13S., R.30E.
 APOD #1, Pump, Flow Meter & Fish Screen 750 ft. North and 3210 ft. West of SE Cor. Sec. 21
 APOD #2, Pump, Flow Meter & Fish Screen 680 ft. North and 2690 ft. West of SE Cor. Sec. 21

- | | |
|-------------|-------------|
| TRACT 1 | TRACT 2 |
| Auth. POD#2 | Auth. POD#1 |
| Add. POD#1 | Add. POD#1 |
- | | |
|-------------|-------------|
| TRACT 1 | TRACT 2 |
| Auth. POD#2 | Auth. POD#1 |
| Add. POD#1 | Add. POD#1 |
- | | |
|-------------|------------|
| Auth. POD#1 | Add. POD#1 |
|-------------|------------|
- | | |
|--|------------|
| Auth. POD is a Slough of the John Day River per adjudication map | Add. POD#2 |
|--|------------|
- | | |
|--------------------------|------------|
| Supplemental Auth. POD#3 | Add. POD#2 |
|--------------------------|------------|
- | | |
|-------------|-------------|
| Add. POD #1 | Add. POD #1 |
|-------------|-------------|

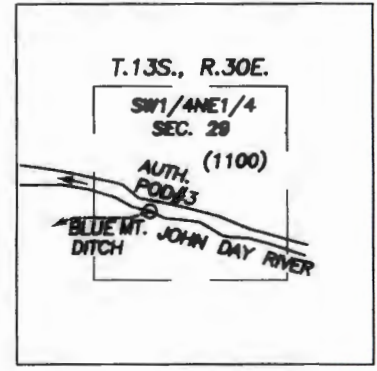

FINAL PROOF SURVEY
 UNDER
TRANSFER-11035
SPECIAL ORDER VOL. 91, PAGE 475

IN NAME OF THOMAS DAY

PREPARED BY
 ROBERT D. BAGETT, PLS, CWRE
 217 N. CANYON BLVD.
 JOHN DAY, OREGON
 (541) 575-1251

JUNE 12, 2019

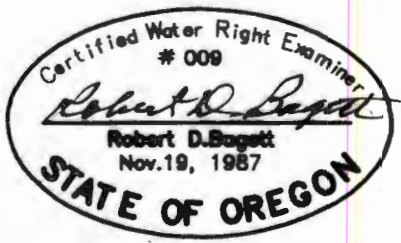

RENEWS: 12/31/2019

DISCLAIMER: THIS MAP IS NOT INTENDED TO PROVIDE LEGAL DIMENSIONS OR LOCATIONS OF PROPERTY BOUNDARY LINES.