

T.13S., R.29E., W.M.

RECEIV

SEP 30

OWR

RECEIVED

SEP 30 2019

OWRD

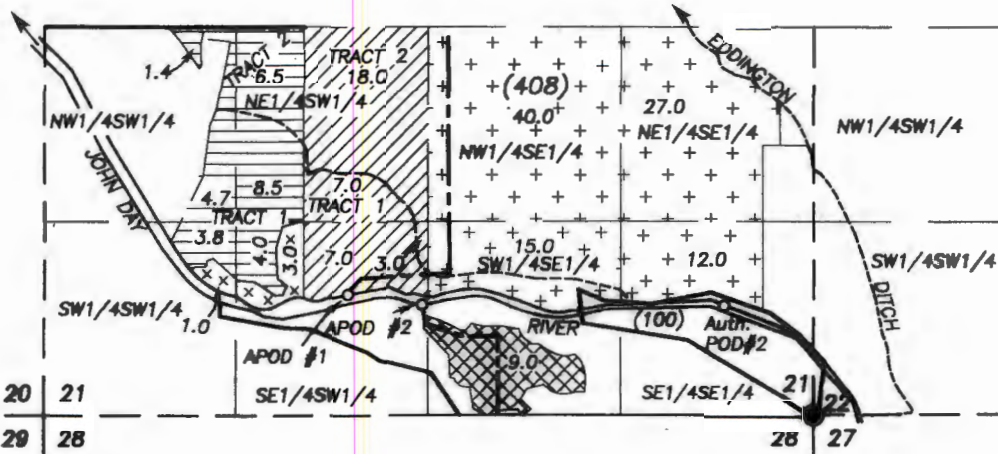

SCALE: 1" = 1320'



Authorized POD #1 50 ft. South and 3380 ft. East of NW Cor. Sec. 27  
 Authorized POD #2 730 ft. North and 620 ft. West of SE Cor. Sec. 21  
 Authorized POD #3 565 ft. North and 2320 ft. West of E1/4 Cor. Sec. 29, T.13S., R.30E.  
 APOD #1, Pump, Flow Meter & Fish Screen 750 ft. North and 3210 ft. West of SE Cor. Sec. 21  
 APOD #2, Pump, Flow Meter & Fish Screen 680 ft. North and 2690 ft. West of SE Cor. Sec. 21

- |                                                                                |                                      |
|--------------------------------------------------------------------------------|--------------------------------------|
| TRACT 1<br>Auth. POD#2<br>Add. POD#1                                           | TRACT 2<br>Auth. POD#1<br>Add. POD#1 |
| TRACT 1<br>Auth. POD#2<br>Add. POD#1                                           | TRACT 2<br>Auth. POD#1<br>Add. POD#1 |
| Auth. POD#1<br>Add. POD#1                                                      |                                      |
| Auth. POD is a Slough of the John Day River per adjudication map<br>Add. POD#2 |                                      |
| Supplemental Auth. POD#3<br>Add. POD#2                                         |                                      |
| Add. POD #1                                                                    |                                      |

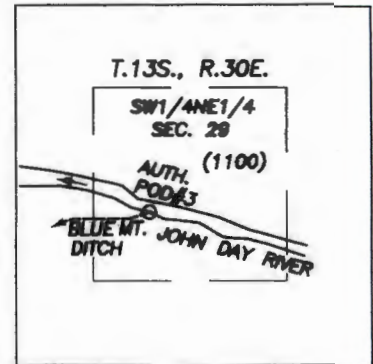

FINAL PROOF SURVEY  
 UNDER  
 TRANSFER-11035  
 SPECIAL ORDER VOL. 91, PAGE 475

IN NAME OF  
 THOMAS DAY

PREPARED BY  
 ROBERT D. BAGETT, PLS, CWRE  
 217 N. CANYON BLVD.  
 JOHN DAY, OREGON  
 (541) 575-1251

JUNE 12, 2019

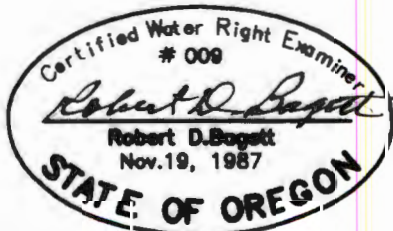

RENEWS: 12/31/2019

DISCLAIMER: THIS MAP IS NOT INTENDED TO PROVIDE LEGAL DIMENSIONS OR LOCATIONS OF PROPERTY BOUNDARY LINES.